

D Series (Standard D-Sub)

IDC Type (Male / Female)

Specifications

Insulation Resistance: 1,000MΩ min. at 500V DC
 Withstanding Voltage: 500V AC
 Contact Resistance: 10mΩ max.
 Current Rating: 1A
 Operating Temp. Range: -55°C to +105°C
 Soldering Temp.: 230°C / 3 secs

Materials and Finish

Shell: Steel, Tin Plated
 Insulator: Polyester Resin (glass filled)
 Fiber reinforced, UL94V-0
 Contacts: Phosphor Bronze
 Plating: Mating Face - Gold over Nickel
 I.D.C Terminal - Tin over Nickel
 Wire Size: AWG 26 or 28 Stranded Wire



Part Number (Details)

D Series
F2 Terminal Version: F2 = IDC Type
25 No. of Contact Pins
***** S = Female P = Male
M Metal Shell
***** Strain Relief: M = Metal P = Plastic
N Insulator Colour:
 N = Black (standard)
 G = Grey (min. order 5,000 pcs)

Outline Connector Dimensions (Male and Female)

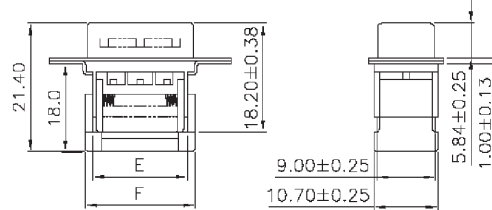
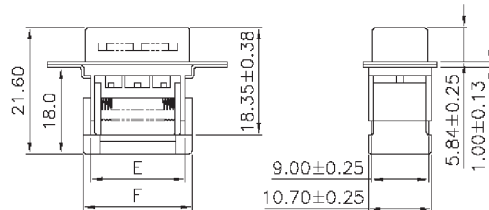
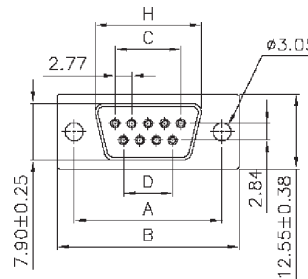
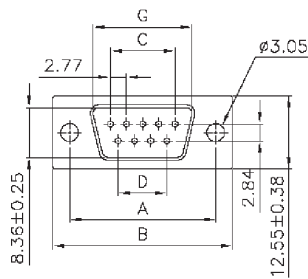

Male

Female

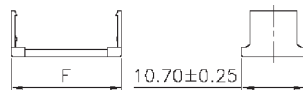

Plastic Strain Relief

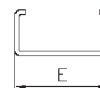

Stainless Steel Strain Relief

Part Number	No. of Contacts	A	B	C	D	E	F	G	H
DF2-09*M-**	9	24.99	30.80	11.08	8.31	16.10	18.60	16.92	16.33
DF2-15*M-**	15	33.32	39.10	19.39	16.62	24.00	26.60	25.25	24.66
DF2-25*M-**	25	47.04	53.09	33.24	30.47	38.14	40.90	38.96	38.38
DF2-37*M-**	37	63.50	69.40	49.86	47.09	54.60	57.10	55.45	54.84