

BAW56WS

HIGH-SPEED SWITCHING DIODE

PINNING

PIN	DESCRIPTION
1	Cathode
2	Anode

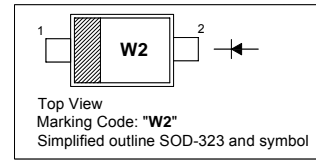

Absolute Maximum Ratings ($T_a = 25\text{ }^\circ\text{C}$)

Parameter	Symbol	Value	Unit
Repetitive Peak Reverse Voltage	V_{RRM}	85	V
Reverse Voltage	V_R	75	V
Continuous Forward Current	I_F	125	mA
Repetitive Peak Forward Current	I_{FRM}	450	mA
Non-repetitive Peak Forward Current $T_j = 25\text{ }^\circ\text{C}$, at $t = 1\text{ }\mu\text{s}$ at $t = 1\text{ ms}$ at $t = 1\text{ s}$	I_{FSM}	4 1 0.5	A
Power Dissipation	P_{tot}	250	mW
Junction Temperature	T_j	150	$^\circ\text{C}$
Storage Temperature Range	T_{stg}	- 65 to + 150	$^\circ\text{C}$

Characteristics at $T_a = 25\text{ }^\circ\text{C}$

Parameter	Symbol	Max.	Unit
Forward Voltage at $I_F = 1\text{ mA}$ at $I_F = 10\text{ mA}$ at $I_F = 50\text{ mA}$ at $I_F = 150\text{ mA}$	V_F	715 855 1 1.25	mV mV V V
Reverse Current at $V_R = 25\text{ V}$ at $V_R = 75\text{ V}$ at $V_R = 25\text{ V}$, $T_j = 150\text{ }^\circ\text{C}$ at $V_R = 75\text{ V}$, $T_j = 150\text{ }^\circ\text{C}$	I_R	30 1 30 50	nA μA μA μA
Diode Capacitance at $f = 1\text{ MHz}$	C_d	2	pF
Reverse Recovery Time at $I_F = 10\text{ mA}$, $I_R = 10\text{ mA}$, $R_L = 100\text{ }\Omega$	t_{rr}	4	ns

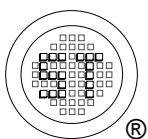

SEMTECH ELECTRONICS LTD.

(Subsidiary of Sino-Tech International Holdings Limited, a company listed on the Hong Kong Stock Exchange, Stock Code: 724)



ISO 9001:2008
Certificate No. 05103

ISO 14001:2004
Certificate No. 7116

ISO 9001:2000
Certificate No. 000008

BS-CHAS 18001:2007
Certificate No. 7119

IECQ QC 080000
Certificate No. 080000

Dated : 07/04/2009

BAW56WS

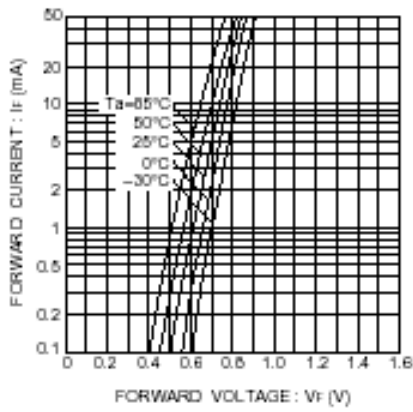

Forward characteristics

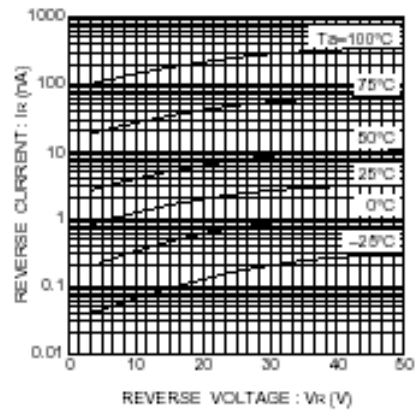

Reverse characteristics

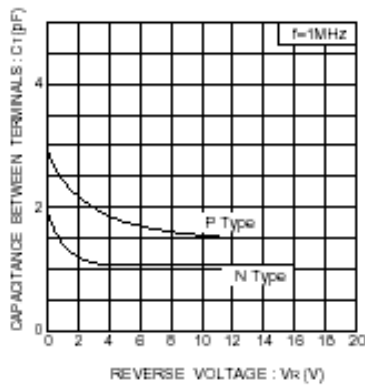

Capacitance between terminals characteristics

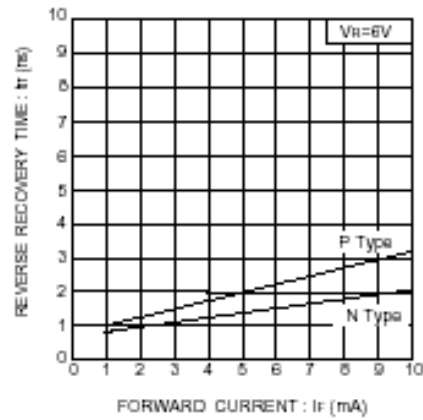

Reverse recovery time

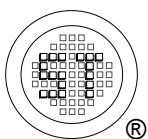

SEMTECH ELECTRONICS LTD.
 (Subsidiary of Sino-Tech International Holdings Limited, a company listed on the Hong Kong Stock Exchange, Stock Code: 724)



Dated : 07/04/2009

BAW56WS

PACKAGE OUTLINE

Plastic surface mounted package; 2 leads

SOD-323

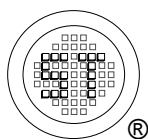
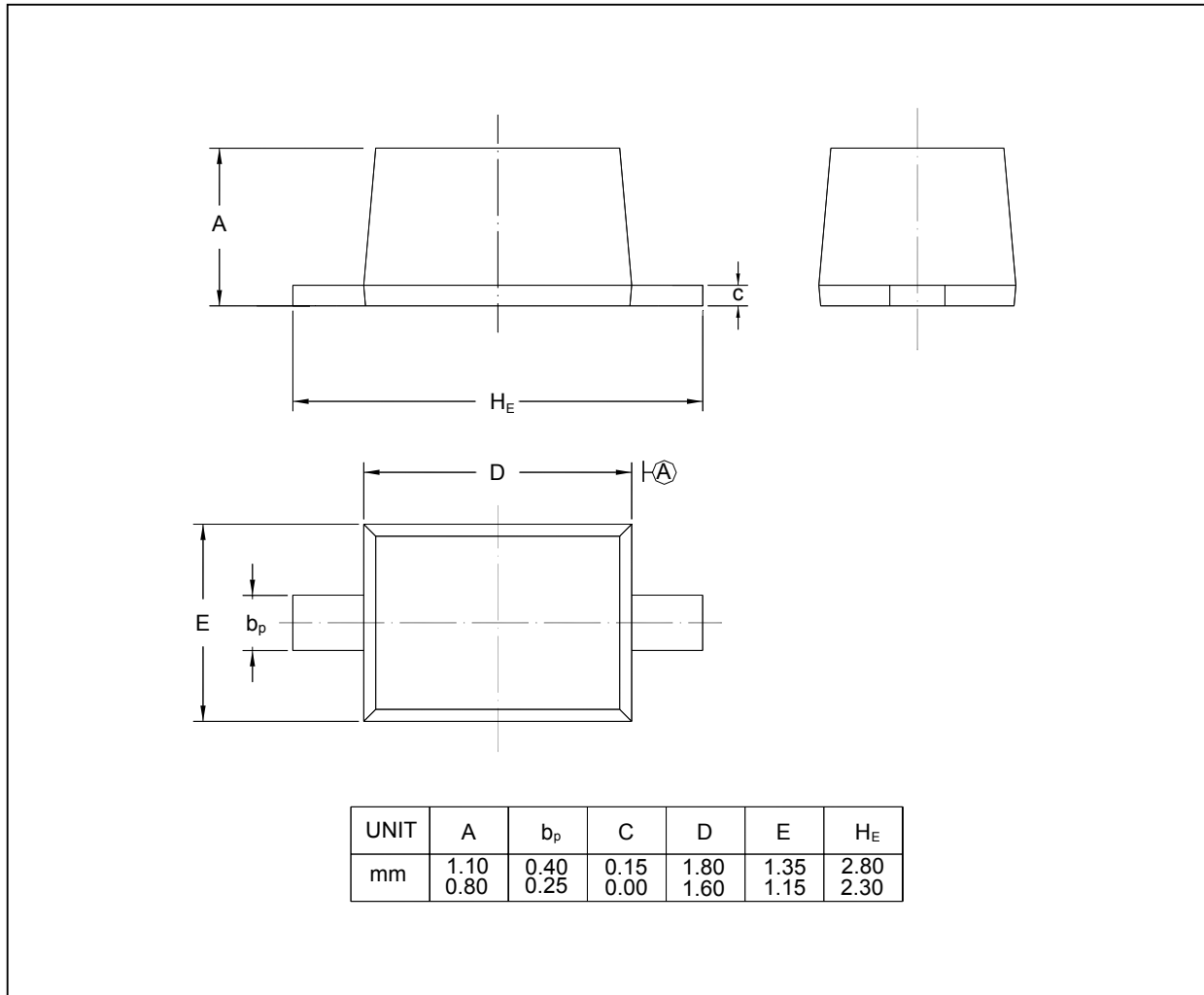

SEMTECH ELECTRONICS LTD.
 (Subsidiary of Sino-Tech International Holdings Limited, a company listed on the Hong Kong Stock Exchange, Stock Code: 724)



Dated : 07/04/2009