

# Micro Switches

## 8.6x4.8x3.0mm Superminiature Micro Switch

## MP30 Series

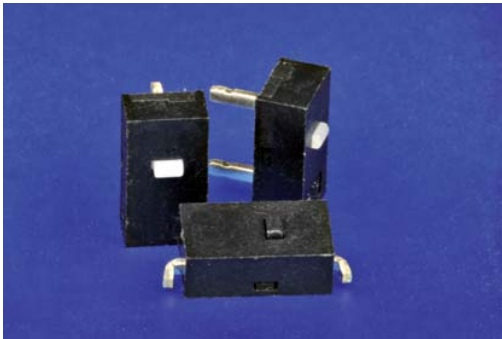

### FEATURES

- > Smaller size than former superminiature micro Switches
- > Longer operating life than former superminiature micro switches
- > THT and SMT terminal type

### APPLICATIONS

- > Industrial Control
- > Notebook
- > Joystick
- > Computer mouse

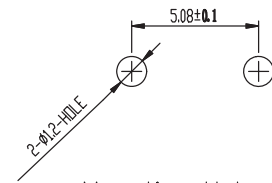
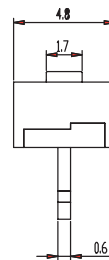
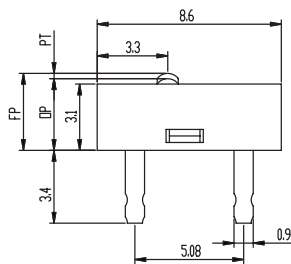

Mounting Holes

### MP30R1H

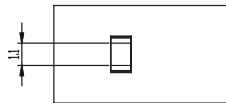

### Thru Hole Type

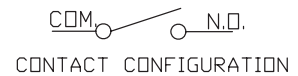

CONTACT CONFIGURATION

General Tolerance:  $\pm 0.2$  mm

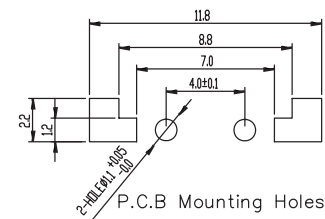
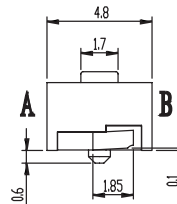
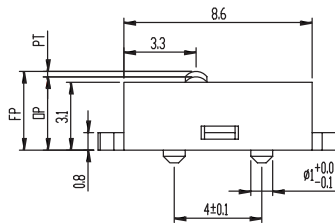

P.C.B Mounting Holes

### MP30R1S

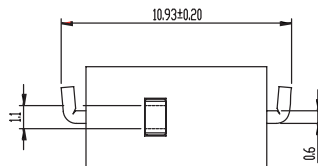

### Surface Mount Type



CONTACT CONFIGURATION

General Tolerance:  $\pm 0.2$  mm

### How to order:

MP30 1 2

- |          |                        |          |                               |
|----------|------------------------|----------|-------------------------------|
| <b>1</b> | <b>CURRENT RATING:</b> | <b>2</b> | <b>TERMINAL (see drawing)</b> |
| R1       | 0.1A 30VDC             | H        | THT                           |
|          |                        | S        | SMT                           |

### 1. Operation Characteristics

Operating Force (OF)	:	60±20 gf
Releasing Force (RF)	:	Min. 20 gf
Free Position (FP)	:	3.6±0.15 mm
Operating Position (OP)	:	3.35 $\begin{matrix} +0.2 \\ -0.15 \end{matrix}$ mm
Movement Differential (MD)	:	Max. 0.12 mm
Over-travel (OT)	:	Min. 0.1 mm
Pre-travel (PT)	:	Max.0.65 mm

### 2. Specifications

Contact Resistance	:	Max. 100 mΩ. (Initial) Before measure the switch contact resistance, please press the switch three times on and off.
Dielectric Strength	:	600VAC (50-60HZ) for one minute between contacts and live-parts
Insulation Resistance	:	Min. 100 MΩ ( At 500 VDC for 1 minute )
Circuit Arrangement	:	SPST ( Single pole single throw )
Rating	:	0.1A 30VDC
Service Life	:	Min. 3,000,000 operations
Rating Load	:	Resistive Load
Operating Frequency	:	120 operations per minute
Mechanical Service Life	:	Min. 3,000,000 operations.
Operating Frequency	:	Max. 120 operations per minute

### 3. Environments

Operating Temperature	:	-25°C ~ 70°C
Storage Temperature	:	-40°C ~ 85°C
Storage Humidity	:	at 40°C, Max. 85% R.H
Vibration	:	10~55Hz, displacement 0.75mm(p-p)
For SMT Temperature	:	Max. 250 °C for 10 seconds, please see the enclosed drawing

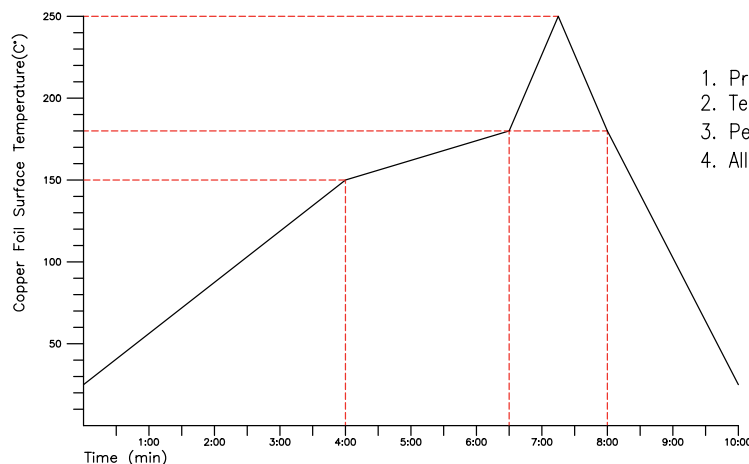

1. Preheat Temp. 150~180°C, Time 1.5~2.5 min.
2. Temp. over 180°C, Time Max. 1.5 min.
3. Peak Temp. Max. 250°C, Time Max. 10 sec.
4. Allowable frequency of solder 2 times.