

Micro Switches

Miniature SPDT Micro Switches

MP2 Series

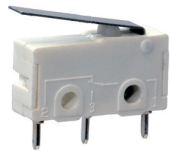

MP2_H01

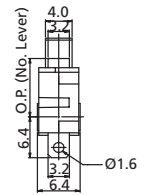
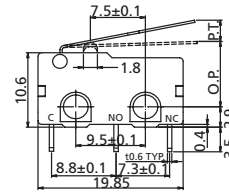
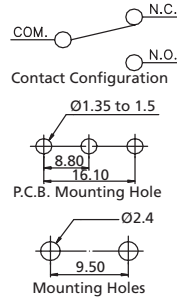
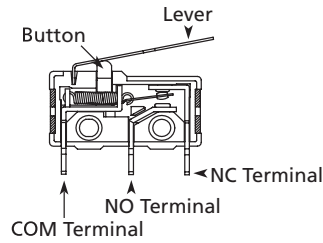

TERMINAL TYPE

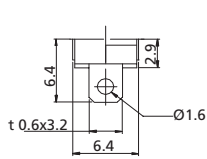

D Solder Terminal

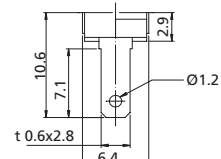

Q Quick Connect

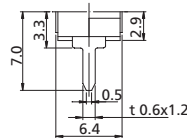

H P.C.B. Terminal Straight

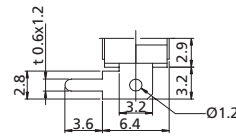

L P.C.B. Terminal Left Angle

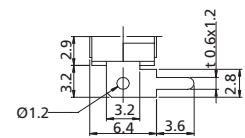

R P.C.B. Terminal Right Angle

HINGED TYPE (LEVER)

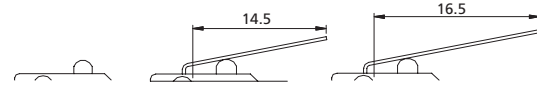

00 Pin Plunger 01 Short

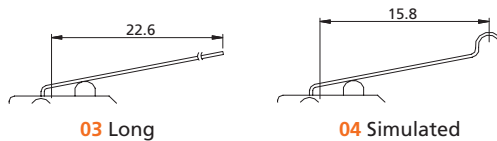

03 Long 04 Simulated



05 Roller 06 Bending

OPERATING FORCE

Hinged Type	O.P. (mm)	P.T. max. (mm)	O.T. min. (mm)	M.D. max. (mm)	Operating Force max. (gf)				Release Force min. (gf)			
					M	L	N	H	M	L	N	H
00	8.40±0.50	0.4	0.7	0.2	50	100	150	250	15	15	35	140
01	9.15±0.85	1.5	1.7	0.8	20	25	45	80	5	5	12	15
02	9.25±0.95	1.8	2.3	0.8	20	20	45	80	5	5	12	15
03	9.3±1.0	2.3	3.0	0.8	15	15	40	70	5	5	12	15
04	10.3±1.0	2.8	1.0	0.8	15	15	40	70	5	5	12	15
05	14.3±1.0	2.5	1.5	0.8	15	15	40	70	5	5	12	15
06	12.55±1.25	2.0	1.5	0.8	15	15	40	70	5	5	12	15

O.P. (Operation Position): The position of the actuator at which the contact snap to the operated contact position
 F.P. (Free Position): The initial position on the actuator when there is no external force applied
 P.T. (Pretravel): The distance or angle through which the actuator moves from the F.P. to the O.P.
 O.T. (Over Travel): The distance or angle of the actuator movement beyond the O.P.
 R.P. (Releasing Position): The position of the actuator at which the contacts snap from the operated contact position to their normal position
 M.D. (Movement Differential): The distance or angle from O.P. to R.P.

Micro Switches

How to order:

MP2 1 2 3 4 5

1 CURRENT RATING:

R1 0.1A 48VDC
 R2 5A 125/250VAC

2 CLOTHED MATERIAL:

AG Silver (Standard)
 AU Gold

3 TERMINAL

D Solder Lug
 Q Quick Connect
 H P.C.B. Terminal Straight
 L P.C.B. Terminal Left Angle
 R P.C.B. Terminal Right Angle

4 HINGED TYPE (See above drawings):

00 Pin Plunger
 01 Short Hinge Lever
 02 Standard Hinge Lever
 03 Long Hinge Lever
 04 Simulated Hinge Lever
 05 Roller Hinge Lever
 06 Bending Hinge Lever

5 OPERATING FORCE

M Minimal Force
 L Lower Force
 N Standard Force
 H Higher Force

General Specifications:

FEATURES

- » SPDT Miniature Micro Switch
- » Long Life spring mechanism
- » Large over travel
- » Small compact size

MATERIAL

- » Stationary Contact: Silver (5A)
 Brass copper (0.1A)
- » Movable Contact: Silver alloy
- » Terminals: Brass Copper

MECHANICAL

- » Type of Actuation: Momentary
- » Mechanical Life: 300,000 operations min.
- » Operating Temperature: -25°C to +105°C

ELECTRICAL

- » Electrical Life: 10,000 operations min.
- » Initial Contact Resistance: 30mΩ max.
- » Insulation Resistance: 100MΩ min.