

20V, 1A SCHOTTKY BARRIER RECTIFIER

Features

- Low forward voltage drop
- Low power loss and High efficiency
- Low leakage current
- High surge capability
- Full lead (Pb)-free and RoHS compliant device

Applications

- High efficiency SMPS
- Output rectification
- High frequency switching
- Freewheeling
- DC-DC converter systems

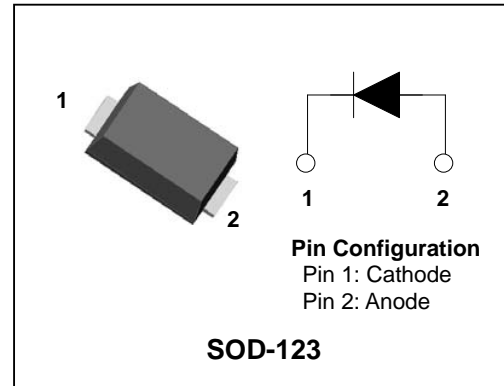

Product Characteristics

$I_{F(AV)}$	1A
V_{RRM}	20V
V_{FM} at 125°C	0.35V (Typ.)
T_J max.	150°C

Description

The SDB120G is suited for Switch Mode Power Supply and high frequency DC to DC converters. This device is especially intended for use in low voltage, high frequency inverters, freewheeling and polarity protection applications.

Ordering Information

Device	Marking Code	Package	Packaging
SDB120G	12G□	SOD-123	Tape & Reel

Marking Information

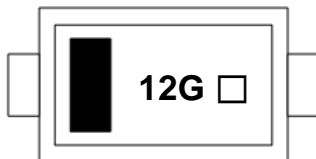

12G = Specific Device Code

□ = Year & Week Code Marking

■ = Color band denote cathode

Absolute Maximum Ratings (Rating at 25°C ambient temperature unless otherwise specified.)

Characteristic	Symbol	Value	Unit
Maximum repetitive reverse voltage Maximum working peak reverse voltage Maximum DC blocking voltage	V_{RRM} V_{RWM} V_R	20	V
Maximum average forward rectified current	$I_{F(AV)}$	1	A
Peak forward surge current 8.3ms single half sine-wave superimposed on rated load per diode	I_{FSM}	12	A
Storage temperature range	T_{stg}	-55°C to +150°C	°C
Maximum operating junction temperature	T_J	150	°C

Thermal Characteristics

Characteristic	Symbol	Value	Unit
Maximum thermal resistance junction to ambient	$R_{th(j-a)}^{1)}$	250	°C/W

* 1) Device mounted on FR-4 board with recommended pad layout.

Electrical Characteristics (Rating at 25°C ambient temperature unless otherwise specified.)

Characteristic	Symbol	Test Condition	Min.	Typ.	Max.	Unit	
Peak forward voltage drop	$V_{FM}^{2)}$	$I_{FM} = 1A$	$T_J = 25^\circ C$	-	0.45	0.50	V
			$T_J = 125^\circ C$	-	0.35	0.40	V
Reverse leakage current	$I_{RM}^{2)}$	$V_R = V_{RRM}$	$T_J = 25^\circ C$	-	-	1	mA
			$T_J = 125^\circ C$	-	-	25	mA
Typical junction capacitance	C_J	$V_R = 1V, f = 1MHz$	-	280	-	pF	

* 2) Pulse test: $t_p \leq 380 \mu s$, Duty cycle $\leq 2\%$

To evaluate the conduction losses use the following equation : $P_F = 0.34 I_{F(AV)} + 0.091 I_{F(RMS)}^2$

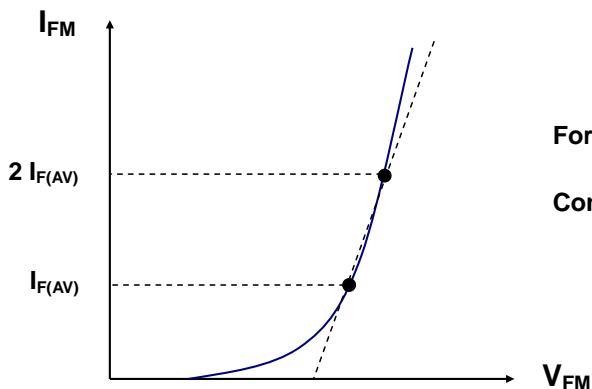

$$\text{Forward Voltage : } V_{FM} = V_{to} + rd I_{FM}$$

$$\text{Conduction Loss : } P_F = V_{to} I_{F(AV)} + rd I_{F(RMS)}^2$$

Rating and Characteristic Curves

Fig. 1) Typical Forward Characteristics

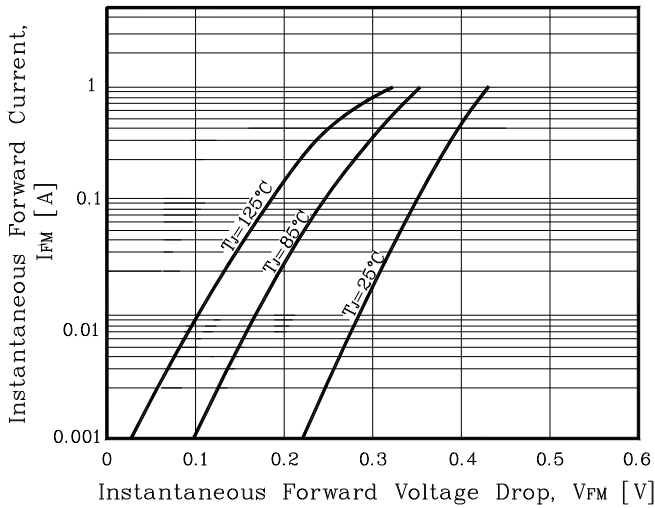

Fig. 2) Typical Reverse Characteristics

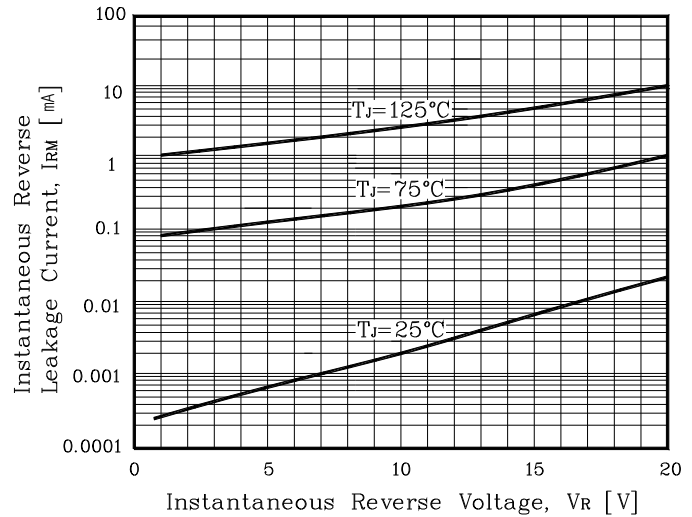

Fig. 3) Maximum Forward Derating Curve

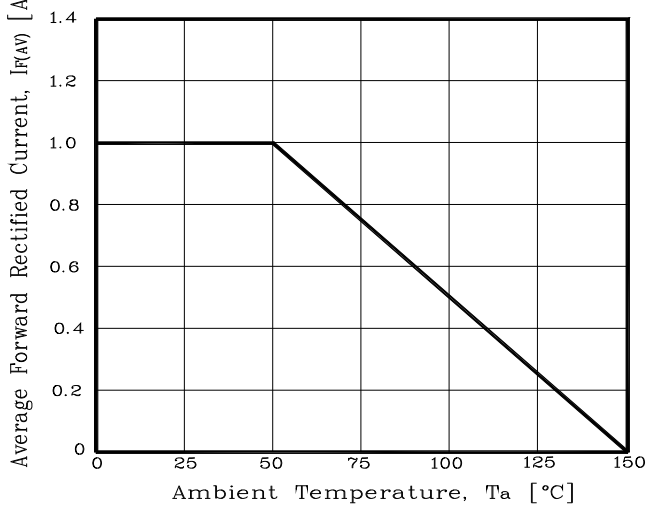

Fig. 4) Forward Power Dissipation

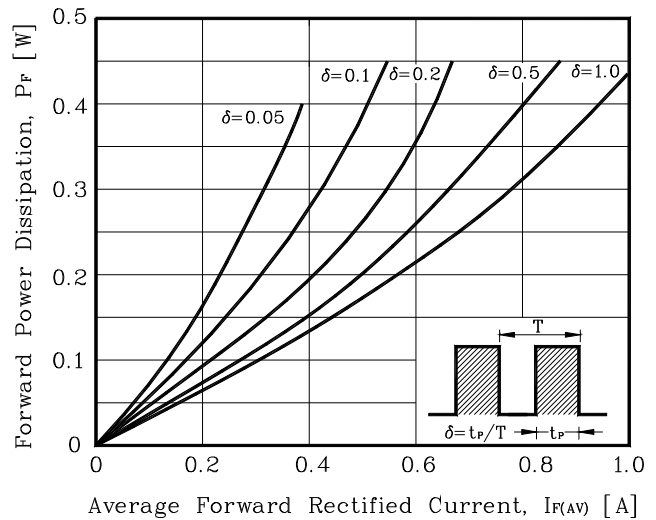
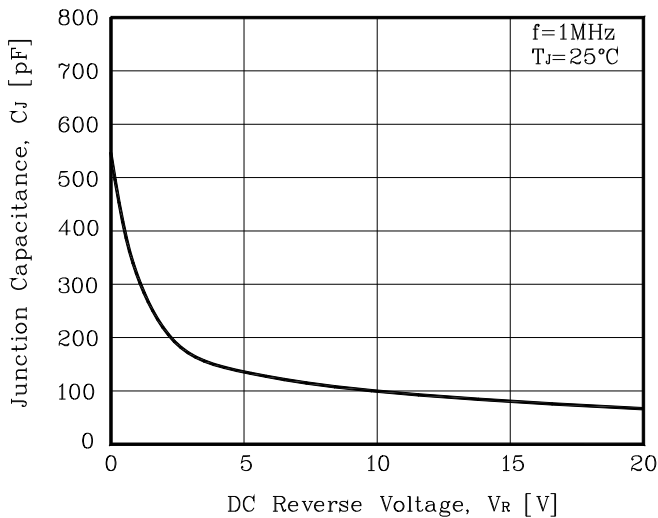
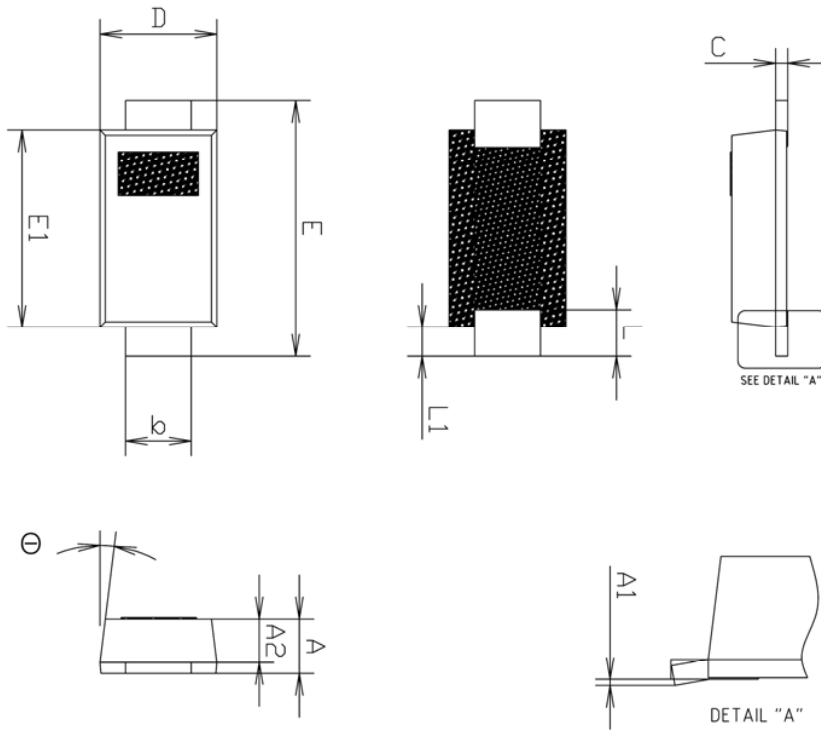

Fig. 5) Typical Junction Capacitance



Package Outline Dimension



SYMBOL	MILLIMETERS			NOTE
	MINIMUM	NOMINAL	MAXIMUM	
A	0.70	0.750	0.80	
A1	0.00	—	0.10	
A2	0.55	0.60	0.65	
b	0.85	0.92	0.99	
c	0.12	0.17	0.22	
D	1.50	1.60	1.70	
E	3.30	3.50	3.70	
E1	2.60	2.70	2.80	
L	0.49	0.64	0.79	
L1	0.30	0.40	0.50	
Θ	4°	—	10°	

Recommend PCB Solder Land Dimension (Unit: mm)

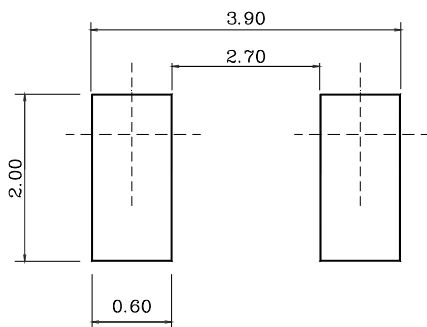

The AUK Corp. products are intended for the use as components in general electronic equipment (Office and communication equipment, measuring equipment, home appliance, etc.).

Please make sure that you consult with us before you use these AUK Corp. products in equipments which require high quality and / or reliability, and in equipments which could have major impact to the welfare of human life(atomic energy control, airplane, spaceship, transportation, combustion control, all types of safety device, etc.). AUK Corp. cannot accept liability to any damage which may occur in case these AUK Corp. products were used in the mentioned equipments without prior consultation with AUK Corp..

Specifications mentioned in this publication are subject to change without notice.