

Rotary Switches

Rotary Switches

RB1 Series

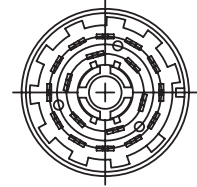
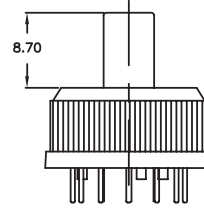
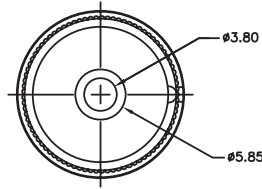

SWITCHING COMBINATION

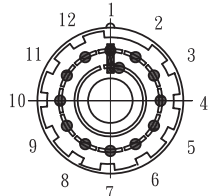

11 1 pole 1*2

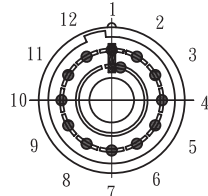

12 1 pole 1*12

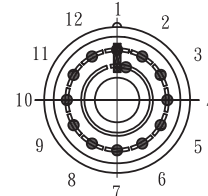

13 1 pole without stop

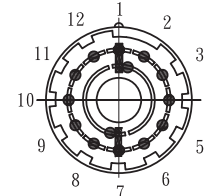

21 2 poles 2*2

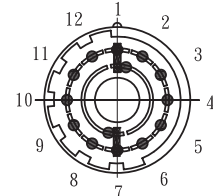

22 2 poles 2*6

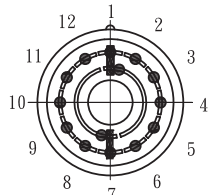

23 2 poles without stop

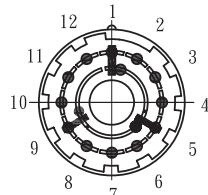

31 3 poles 3*2

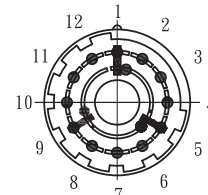

32 3 poles 3*4

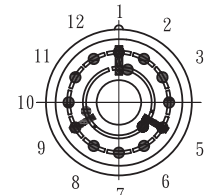

33 3 poles without stop

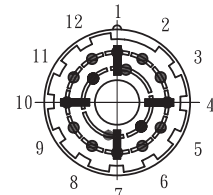

41 4 poles 4*2

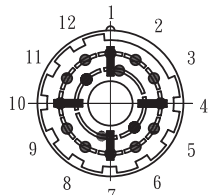

42 4 poles 4*3

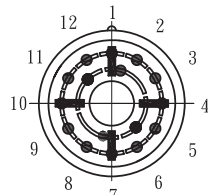

43 4 poles without stop

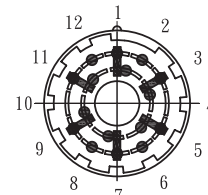

61 6 poles 6*2

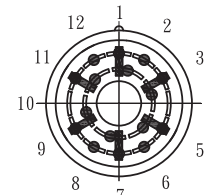

63 6 poles without stop

ACTUATOR OPTIONS

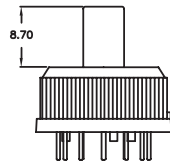

E Extended Actuator

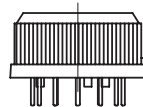

R Recessed Actuator

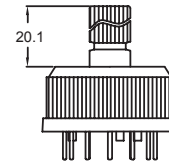

L Extended with Allu Shaft

P. C. MOUNTING

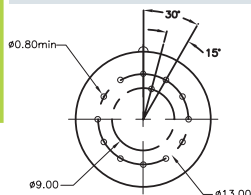

1 pole

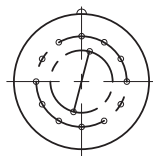

2 poles

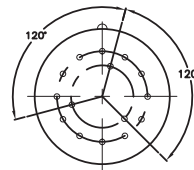

3 poles

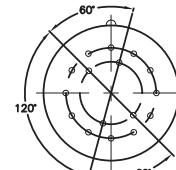

4 poles

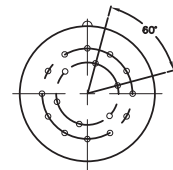

6 poles

How to order:

RB1

1 ACTUATOR:
E Extended
R Recessed
L Extended with Alluminum Shaft

2 SWITCHING COMBINATION:
11 12 13 21 22
23 31 32 33 41
42 43 61 63

3 CONTACTS:
S Shorting (Make before break)
N Non Shorting (Break before make)

General Specifications:

Voltage Rating: 150 VDC
Current Rating: 130mA
Insulation Resistance: 100M Ω Min.
Indexing Angle: 30°
Operating Life no load: 20,000 cycles Min.
Operating Life at Maxpower: 15,000 cycles Min.
Solder Specification: 250°C 5 seconds
Operating Force: 1 kgf $_cm$ (Max.)