

## Specifications

Insulation Resistance:	50MΩ min. at 250V DC
Withstanding Voltage:	250V AC for 1 minute
Contact Resistance:	30mΩ max.
Rating:	1A max. at 100V AC 2A max. at 12V DC
Operating Temp. Range:	-55°C to +85°C
Mating Cycles:	1000 min. at 10-20 times per minute (no electrical load)
Soldering Temp.:	230°C / 3 sec.

## Materials and Finish

Housing: Thermoplastic  
Contact: Phosphor Bronze



## Features

- ⇨ 180° Pin Through Hole Jam-Nut socket, screw type
- ⇨ Hex Nut M14, \*P1.0

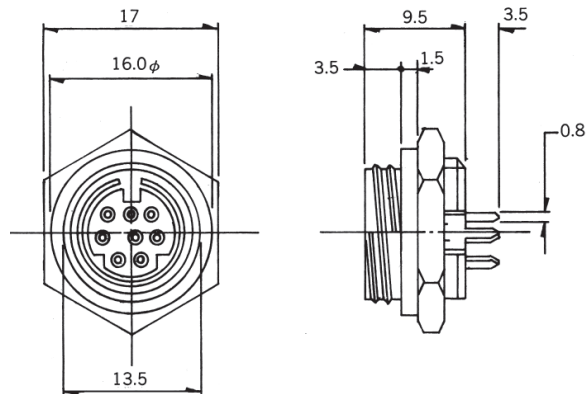

## Contact Arrangements and PCB Layouts

### 3 Pins

Part No.: MDIN03G

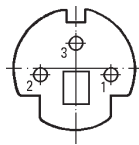

Front View

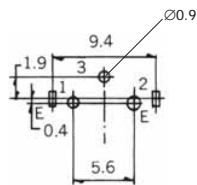

Bottom View

### 6 Pins

Part No.: MDIN06G

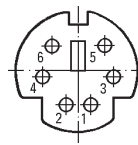

Front View

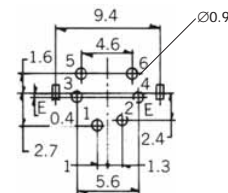

Bottom View

### 4 Pins

Part No.: MDIN04G

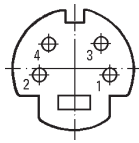

Front View

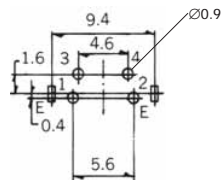

Bottom View

### 7 Pins

Not Available

### 5 Pins

Part No.: MDIN05G

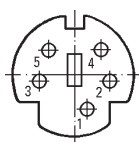

Front View

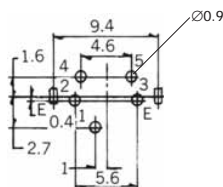

Bottom View

### 8 Pins

Part No.: MDIN08G

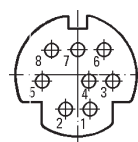

Front View

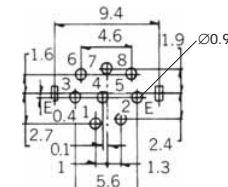

Bottom View