

PLEASE CHECK WWW.MOLEX.COM FOR LATEST PART INFORMATION

Part Number: [0003062043](#)
Status: **Active**
Overview: [standard_062](#)
Description: 1.57mm (.062") Diameter Standard .062 Pin and Socket Plug Housing, Dual row, with Panel Mount Ears, PA Polyamide Nylon 6/6, UL 94V-2, 4 Circuits

Documents:

[3D Model](#) [Packaging Specification \(PDF\)](#)
[Drawing \(PDF\)](#) [RoHS Certificate of Compliance \(PDF\)](#)

Agency Certification

CSA LR19980
 UL E29179

General

Product Family Crimp Housings
 Series [2004](#)
 Overview [standard_062](#)
 Product Name Standard .062"

Physical

Circuits (maximum) 4
 Circuits Detail (2 x 2)
 Color - Resin Natural
 Flammability 94V-2
 Gender Male
 Glow-Wire Compliant No
 Lock to Mating Part Yes
 Material - Resin Nylon
 Number of Rows 2
 Packaging Type Bag
 Panel Mount Yes
 Pitch - Mating Interface (in) 0.145 In
 Pitch - Mating Interface (mm) 3.68 mm
 Polarized to Mating Part Yes
 Stackable No
 Temperature Range - Operating -40°C to +105°C

Electrical

Current - Maximum per Contact 5A

Material Info

Old Part Number 2004P

Reference - Drawing Numbers

Sales Drawing SD-2004-*

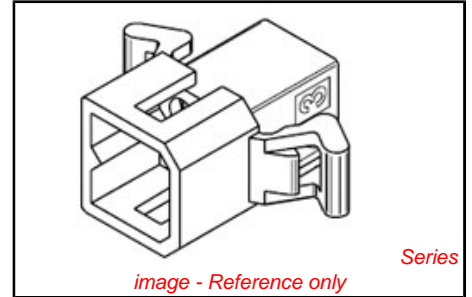

<p>EU RoHS ELV and RoHS Compliant REACH SVHC Contains SVHC: No Halogen-Free Status Not Reviewed</p>	<p>China RoHS</p> 
------------------------------------------------------------------------------------------------------------------------------------------------------------------------------------------------	--------------------------------------------------------------------------------------------------------------

Need more information on product environmental compliance?
 Email productcompliance@molex.com
 For a multiple part number RoHS Certificate of Compliance, [click here](#)
 Please visit the [Contact Us](#) section for any non-product compliance questions.

Search Parts in this Series
[2004Series](#)

Mates With
[03-06-1043](#) Panel Mount Receptacle,
[03-06-1044](#) Free Hanging Receptacle

Use With
 1560 male crimp terminals, 1561 female crimp terminals, [4559](#) , [4529](#) , [2190](#) , [2189](#) , [1787](#) female crimp terminals, [1786](#) male crimp terminals, [1854](#) male crimp terminals, [1855](#) female crimp terminals, [1778](#) male PC tail terminals, [1779](#) female PC tail terminals

PLEASE CHECK WWW.MOLEX.COM FOR LATEST PART INFORMATION

13 12 11 10 9 8 7 6 2004 4 3 2 1

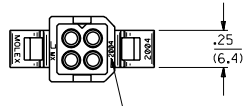

ENG. NO. LOCATION FOR PARTS W/O MTC. EARS

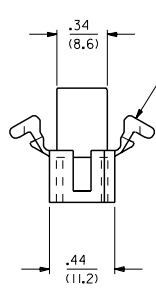
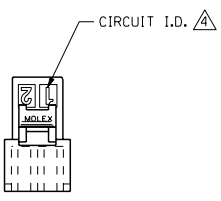

MOUNTING EAR (2 PL.) (PREBENT EAR SHOWN) SEE DETAIL 3 OR 4

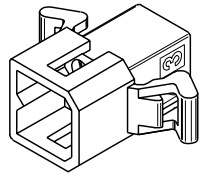
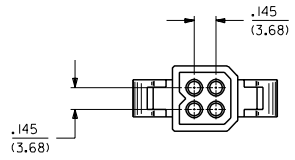
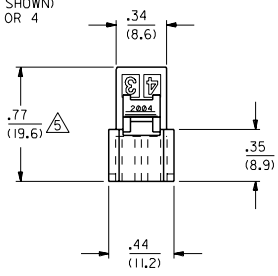

PLUG HOUSING

K	3	K	OBsolete P/N LER 2002-0270 COMMERCIAL 01/10/1
J2	1	1	X-REMOVE PER ECN U3 0816 GC 5/25/93 RW
J1	1	1	X-RELEASE PER ECN U3 0759 GC 5/18/93 RW
J	1	1	REV. PER ECN ECN U2-1825 AFG 92-12-18 RW
K	1	1	RE-DRAWN & REV'D. ON CAD. ECR U1 1774 GC 8/27/91
MFG.	SHL.	REV.	LTR.
			REVISIONS

REVISE ONLY ON CAD SYSTEM

SEE CHART

PLUG AND RECEPTACLE HOUSINGS, 4 CIRCUIT .062/(1.57) DIA.

MOLEX INCORPORATED

U.S.A. 1 of 3 8/27/91

SD-2004-*

13 12 11 10 9 8 7 6 5 4 3 2 1

PLUG		RECEPTACLE		
PART NO.	ENG. NO.	PART NO.	ENG. NO.	
03-06-2043	2004-P	03-06-1043	2004-R	
03-06-7043	2004-PBK	03-06-6043	2004-RBK	
03-06-2044	2004-PI	03-06-1044	2004-RI	
03-06-7044	2004-PIBK	03-06-6044	2004-RIBK	OBSOLETE
PRELIMINARY	2004-P2	03-06-1046	2004-R3	OBSOLETE
03-06-7045	2004-PIRD	03-06-1052	2004-R5	OBSOLETE
03-06-7046	2004-PIBN	03-06-6052	2004-R5BK	OBSOLETE
03-06-7047	2004-PIOR	PRELIMINARY	2004-R2	
		03-06-6045	2004-RRD	OBSOLETE
		03-06-6046	2004-RBN	OBSOLETE
		03-06-6048	2004-ROR	OBSOLETE

LEGEND:

2004-***
 P = PLUG
 R = RECEPTACLE
 BLANK = WITH STANDARD EARS
 1 = WITHOUT EARS
 2 = WITH PREBENT EARS
 3 = W/O EARS, W/O DETENTS
 5 = W/O EARS, WITH POSITIVE LOCKS
 COLOR:
 BLANK = NATURAL
 AM=AMBER BK=BLACK BU=BLUE
 BN=BROWN GY=GRAY GN=GREEN
 OR=ORANGE RD=RED YW=YELLOW

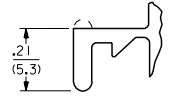

DETAIL 3

STANDARD MOUNTING EARS
(SCALE 4:1)

NOTE:
 THIS DRAWING ENCOMPASSES ALL 2004
 SERIES HOUSINGS EXCEPT 2004-R7.

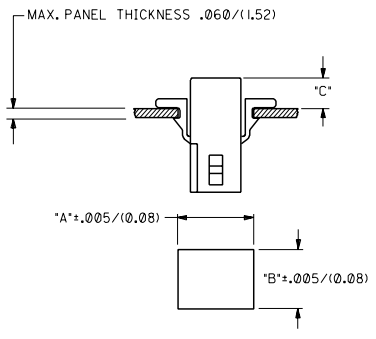

- NOTES:**
- MATERIAL - NYLON TYPE 6/6, 94V-2
 - THIS PRODUCT COMPLIES WITH MOLEX PRODUCT SPEC 02-06.
 - HOUSINGS FOR USE WITH MOLEX .062/(1,57) DIA. SERIES TERMINALS.
- ⚠️ CIRCUIT I.D. NUMBERS ON SIDE OF HOUSING APPEAR ON PARTS FROM TOOLS BUILT AFTER 8/26/91.
- ⚠️ THIS DIMENSION .020/(0,51) LESS ON TOOLS BUILT PRIOR TO 8/26/91.



DETAIL 4

PREBENT MOUNTING EARS
(SCALE 4:1)

RECOMMENDED HOLE PATTERN

HOUSING	DIM. "A"	DIM. "B"	PREBENT EAR DIM. "C"	STD. EAR DIM. "C"
PLUG	.615 (15,62)	.465 (11,81)	.26 (6,6)	.26 (6,6)
RECEPTACLE	.506 (12,85)	.400 (10,16)	.24 (6,1)	.24 (6,1)

DIMENSIONS SHOWN IN METRIC (INCH UNLESS OTHERWISE SPECIFIED)		TOLERANCES ANGULAR ±.040 (1.0)		REVISIONS ONLY ON CAD SYSTEM	
TITLE: PLUG AND RECEPTACLE HOUSINGS, 4 CIRCUIT .062/(1,57) DIA.		SHEET NO. 3		DATE 8/28/91	
MOLEX INCORPORATED		U.S.A.		DRAWING NO. SD-2004-*	
DRAWN BY: JJS		CHK'D BY: RW		FILE NAME: MOLEX4-CA	
APP'D BY: RS		SCALE: 2:1		DIV. CP	
LTR. REVISIONS		LTR. REVISIONS		LTR. REVISIONS	