

PLEASE CHECK WWW.MOLEX.COM FOR LATEST PART INFORMATION

Part Number: [0011185331](#)
Status: **Active**
Description: Insulation Anvil

Documents:

[RoHS Certificate of Compliance \(PDF\)](#)

General

Product Family	Application Tooling
Series	T1118
Comments	See Tooling Specification (PDF) Above
Function	Cutter
Geographic Area	Global
Level of Automation	Semi-Automatic
More Detailed Tech Information	applicationtooling@molex.com
Product Name	N/A
Survey	www.molex.com/review/apptool_survey.html
Tool Type	Anvil

Material Info

Old Part Number 60816D122

Reference - Drawing Numbers

Application Tooling Documents ATS-STANDARD-PARTS

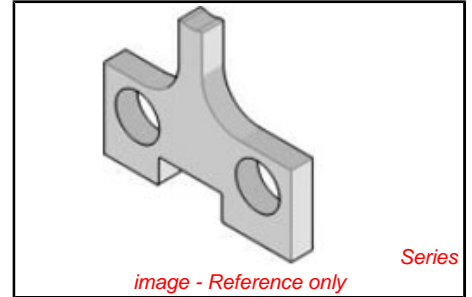

<p>EU RoHS ELV and RoHS Compliant REACH SVHC Not Reviewed Low-Halogen Status Not Reviewed</p>	<p>China RoHS</p>
---	--------------------------

Need more information on product environmental compliance?

Email productcompliance@molex.com
 For a multiple part number RoHS Certificate of Compliance, [click here](#)

Please visit the [Contact Us](#) section for any non-product compliance questions.

Search Parts in this Series
 T1118Series

Use With
[0011182193](#) , [0011182194](#) , [0011183187](#) ,
[0638933200](#) , [0638933270](#) , [0638933300](#) ,
[0638933370](#)

PLEASE CHECK WWW.MOLEX.COM FOR LATEST PART INFORMATION