

# Customer Information Sheet

DRAWING No.: M50-360XX42

IF IN DOUBT - ASK

©

NOT TO SCALE

THIRD ANGLE PROJECTION

ALL DIMENSIONS IN mm

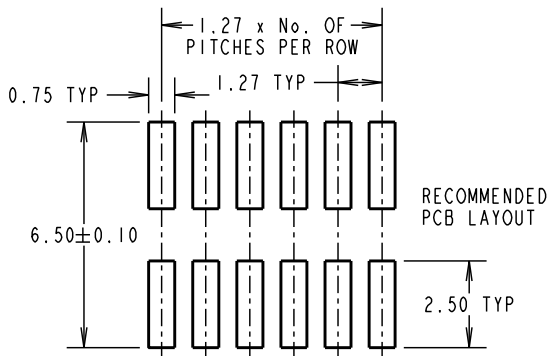
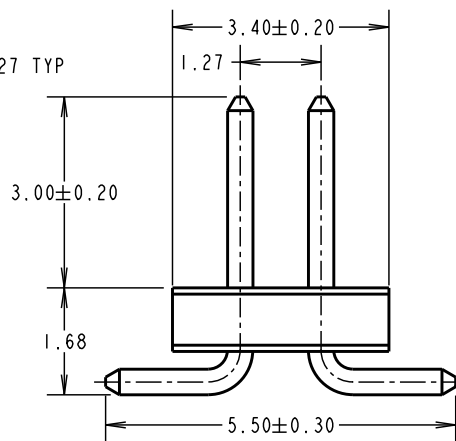
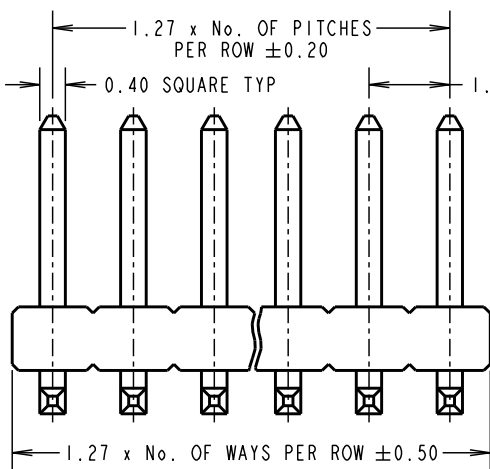

**SPECIFICATIONS:**

**MATERIAL:**  
 MOULDING = HIGH TEMP THERMOPLASTIC UL94V-0  
 CONTACTS = BRASS  
**FINISH:**  
 CONTACTS = 0.15 - 0.08µ GOLD ON CONTACT AREA,  
 2.5 - 3.0µ 100% TIN OVER 0.7 - 1.3µ  
 NICKEL ON TAILS

**ELECTRICAL:**  
 CURRENT RATING (ALL CONTACTS ARE  
 ELECTRICALLY LOADED) = 1A  
 CONTACT RESISTANCE = 30mΩ MAX  
 INSULATION RESISTANCE = 5000MΩ MIN  
 DIELECTRIC WITHSTANDING = 600V AC MIN  
**MECHANICAL:**  
 PIN RETENTION = 4.4N NOMINAL  
 SOLDERABILITY = 250°C FOR 3 TO 5 SECONDS  
 DURABILITY = 600 CYCLES

**ENVIRONMENTAL:**  
 TEMPERATURE RANGE = -40°C TO +105°C  
**PACKING:**  
 BOX

FOR COMPLETE SPECIFICATION, SEE COMPONENT SPECIFICATION C029XX (LATEST ISSUE)

ORDER CODE:  
**M50-360XX42**  
 No. OF WAYS PER ROW = 42  
 01 TO 50  
 FINISH:  
 42 = SELECTIVE GOLD  
 + 100% TIN OVER NICKEL

SB	14	29.03.12	11696
NAME	ISS.	DATE	C/NOTE
APPROVED: S.BENNETT			
CHECKED: S.FLOWER			
DRAWN: J. KIER			
CUSTOMER REF.:			
ASSEMBLY DRG:			

NOTES:  
 1. ALL TOLERANCES ARE ±0.15 UNLESS OTHERWISE STATED.

**HARWIN**

www.harwin.com  
 technical@harwin.com

THIS DRAWING AND ANY INFORMATION OR DESCRIPTIVE MATTER SET OUT HEREON ARE CONFIDENTIAL AND COPYRIGHT PROPERTY OF THE HARWIN GROUP AND MUST NOT BE DISCLOSED, LOANED, COPIED OR USED FOR MANUFACTURING, TENDERING OR FOR ANY OTHER PURPOSE WITHOUT THEIR WRITTEN PERMISSION.

**TOLERANCES**  
 % = ±1mm  
 X.X = ±0.25mm  
 X.XX = ±0.10mm  
 X.XXX = ±0.01mm  
 ANGLES = ±5°  
 UNLESS STATED

**MATERIAL:**  
 SEE ABOVE

**FINISH:** SEE ABOVE

**S/AREA:** mm<sup>2</sup>

**TITLE:**  
 1.27mm PITCH DIL VERTICAL SMT PIN HEADER

**DRAWING NUMBER:**  
**M50-360XX42**

SHT  
 2 OF 2