

# Customer Information Sheet

DRAWING No.: M50-315XX42 SHEET 2 OF 2 IF IN DOUBT - ASK (C) NOT TO SCALE THIRD ANGLE PROJECTION ALL DIMENSIONS IN mm

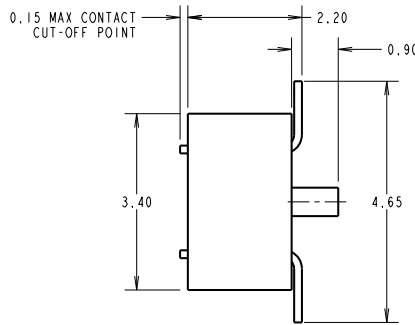
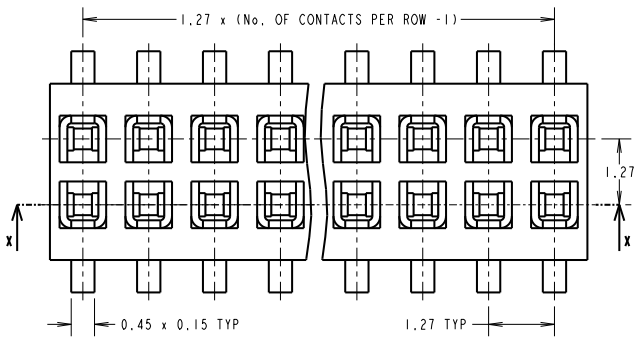

**SPECIFICATION:**  
**MATERIAL:**  
 MOULDING = NYLON-9T, UL94V-0, BLACK  
 CONTACTS = PHOSPHOR BRONZE  
**FINISH:**  
 CONTACTS = 1.27µ NICKEL ALL OVER,  
 GOLD FLASH ON CONTACT AREA, 2.54µ 100% TIN ON TAILS  
**ELECTRICAL:**  
 CURRENT RATING = 1.5A  
 VOLTAGE RATING = 150V AC/DC  
 CONTACT RESISTANCE = 20mΩ MAX  
 INSULATION RESISTANCE = 1000MΩ MIN  
 DIELECTRIC WITHSTANDING = 500V AC (1 MINUTE)  
**MECHANICAL:**  
 INSERTION FORCE = 1.5N MAX  
 WITHDRAWAL FORCE = 0.15N MIN  
 DURABILITY = 100 CYCLES  
**ENVIRONMENTAL:**  
 TEMPERATURE RANGE = -40°C TO +105°C  
**PACKING:**  
 TUBE  
 FOR COMPLETE SPECIFICATION, SEE COMPONENT SPECIFICATION C029XX (LATEST ISSUE)

**NOTES:**  
 1. ALL TOLERANCES ARE ±0.25 UNLESS OTHERWISE STATED.

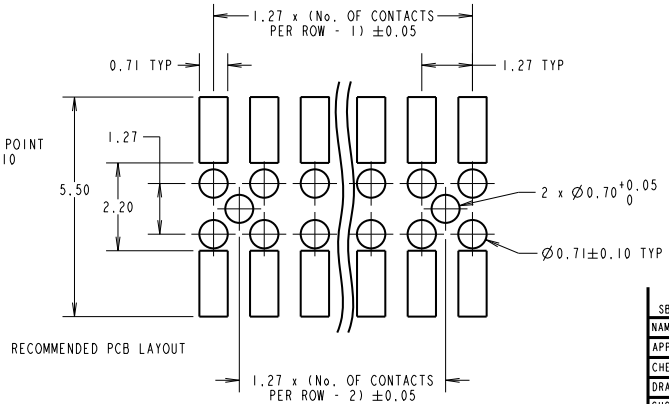
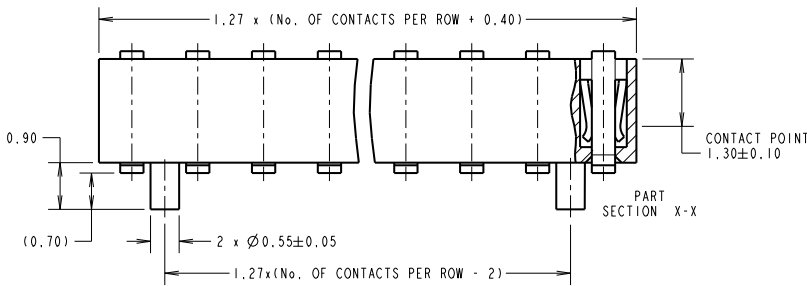

|                     |      |          |        |
|---------------------|------|----------|--------|
| SB                  | 14   | 19.10.12 | 11847  |
| NAME                | ISS. | DATE     | C/NOTE |
| APPROVED: S.BENNETT |      |          |        |
| CHECKED: M.PLESTED  |      |          |        |
| DRAWN: W. J. BOURNE |      |          |        |
| CUSTOMER REF.:      |      |          |        |
| ASSEMBLY DRG:       |      |          |        |

ORDER CODE  
**M50-315XX42**  
 No. OF CONTACTS PER ROW: 03 TO 50  
 FINISH: 42 = SELECTIVE GOLD + 100% TIN

**HARWIN**  
 www.harwin.com  
 technical@harwin.com

THIS DRAWING AND ANY INFORMATION OR DESCRIPTIVE MATTER SET OUT HEREON ARE CONFIDENTIAL AND COPYRIGHT PROPERTY OF THE HARWIN GROUP AND MUST NOT BE DISCLOSED, LOANED, COPIED OR USED FOR MANUFACTURING, TENDERING OR FOR ANY OTHER PURPOSE WITHOUT THEIR WRITTEN PERMISSION.

**TOLERANCES**  
 X = ±0.1mm  
 X.X = ±0.25mm  
 X.XX = ±0.10mm  
 X.XXX = ±0.01mm  
 ANGLES = ±5°  
 UNLESS STATED

**MATERIAL:**  
 SEE ABOVE  
**FINISH:** SEE ABOVE  
**S/AREA:** mm<sup>2</sup>

**TITLE:**  
 1.27mm PITCH DIL SMT VERT. LOW-PROFILE SOCKET ASSY.  
**DRAWING NUMBER:**  
**M50-315XX42**  
 SHT 2 OF 2