

0.4 mm Pitch Back-Lock FPC Connector

FF19CE Series 【CE-ATA 8Bit Standard】



OUTLINE

- FF19CE series is a FPC connector which is 0.4mm pitch, 1.25mm height and 4.21mm depth.
- It is interface connector for smaller than 1.8" HDD.

FEATURE

- Conforming to CE-ATA 8bit standard (HDD side)
- Front-access back lock design is short depth and suitable to compact device.
- Cable lock mechanism retains FPC.
- Mid-mounting design which is mounted across the PCB enables to operate the lock lever from reverse side.
- Connectors deliver with the lock lever opened. Time saving for FPC inserting operation.
- Both upper and lower contacts design accepts any FPC inserting directions.
- Back lock mechanism enables to retain FPC against pulling upward direction.
- The lock lever does not fall down to the opposite side.
- Board lock pins prevent the mounting gap.
- Nickel barrier prevents solder wicking.

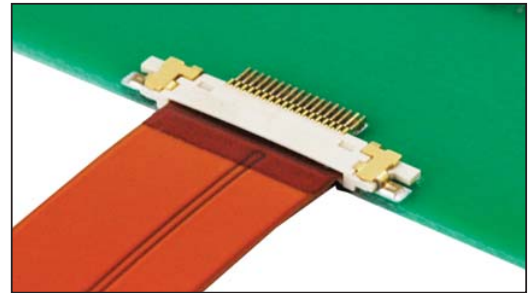
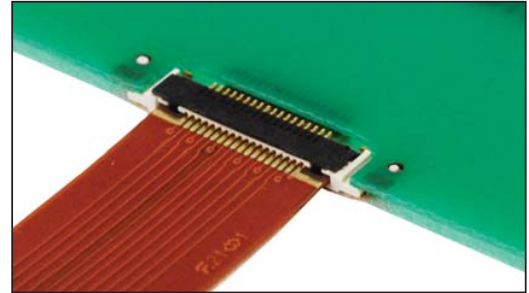

SPECIFICATIONS

| | |
|---------------------------------|--------------------------------|
| Rated Voltage | 50V AC(r.m.s.) |
| Rated Current | 0.5A / Contact |
| Dielectric Withstanding Voltage | 200V AC(r.m.s.) / 1 minute |
| Insulation Resistance | 100 M Ω min. at 500V DC |
| Contact Resistance | 50m Ω max. |

APPLICATIONS

Portable HDD

MATERIAL/FINISH



| Item | Material / Finish |
|------------|---|
| Contact | Copper Alloy /Au(Flash) over Ni Plating |
| Housing | LCP Resin (UL94V-0) / Ivory |
| Lock Lever | PPS Resin (UL94V-0) / Black |

© Specifications and/or dimensions in this catalogue are subject to change without notice.
Your catalogue checking the latest specifications with our drawings would be highly appreciated.

090803

<http://www.ddknet.co.jp>

▶ CE-ATA 8Bit Standard
Part Number FF19CE-18B-R11BP

① ② ③ ④ ⑤ ⑥ ⑦ ⑧

| | |
|---------------------|-------------------------------|
| ① Series | FF19CE |
| ② Number of Contact | 18 : 18 Contacts |
| ③ Contact Position | B : Upper and Lower Contact |
| ④ Contact Style | R : Right Angle |
| ⑤ Mounting Type | 1 : Mid Mount Type |
| ⑥ Contact Plating | 1 : Au(Flash) over Ni Plating |
| ⑦ Lock Lever Type | B : with Cable Lock |
| ⑧ Board Lock | P : with Board Lock |

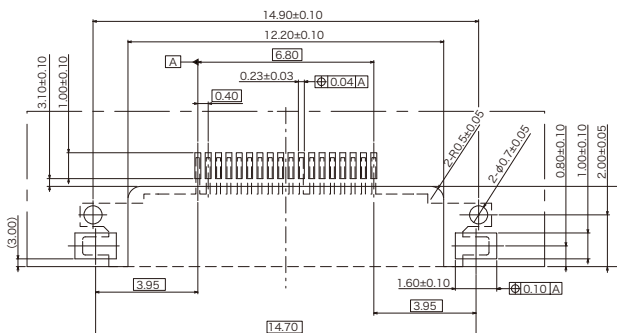
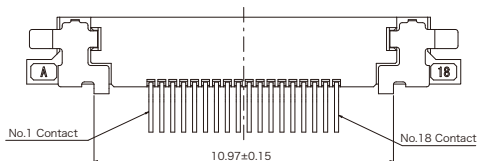
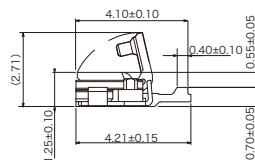
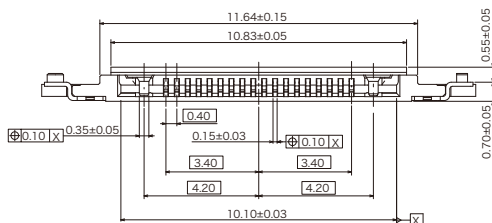
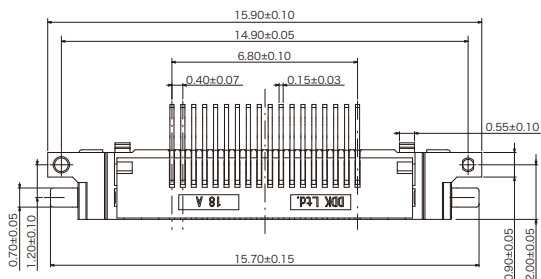
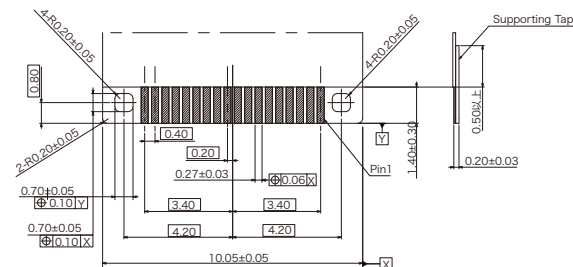

Recommended PCB Dimensions

Recommended FPC Dimensions

- Recommended FPC Plating : Au over Ni Plating
- Recommended Adhesive : Heat Curing Adhesive

© Specifications and/or dimensions in this catalogue are subject to change without notice.
 Your catalogue checking the latest specifications with our drawings would be highly appreciated.

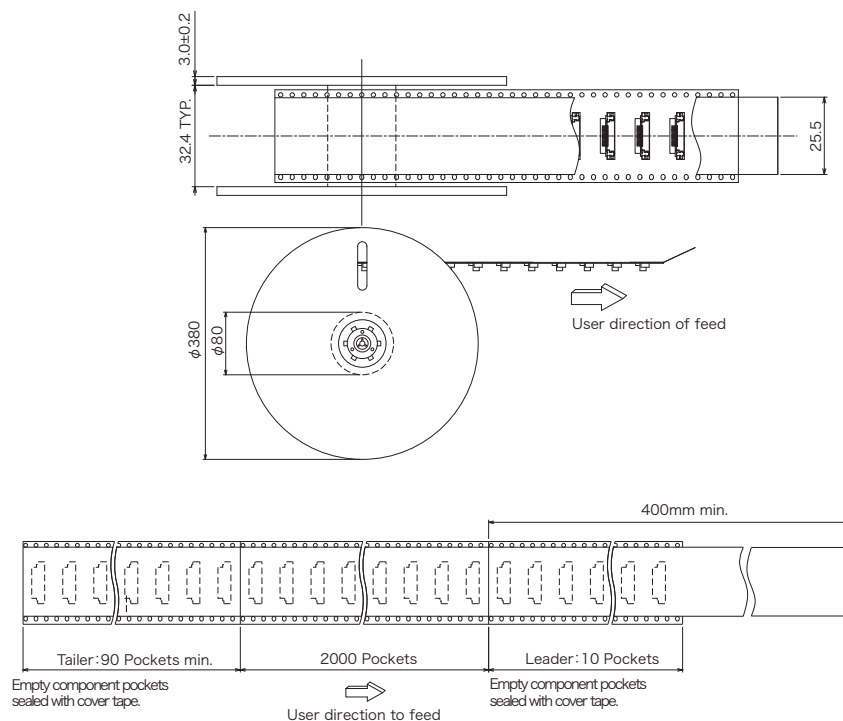
▶ Package Specifications

■ Reel Dimensions



■ Emboss Tape Dimensions

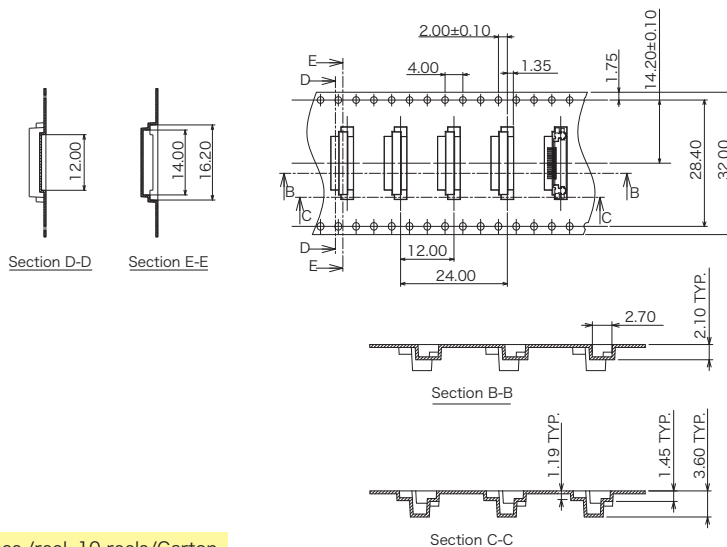

■ Quantity : 2000pcs./reel, 10 reels/Carton

© Specifications and/or dimensions in this catalogue are subject to change without notice.
 Your catalogue checking the latest specifications with our drawings would be highly appreciated.

<http://www.ddknet.co.jp>