

Model(型號): ROTARY POTENTIOMETER-----S[X][X]D11B01

► Download PDF file

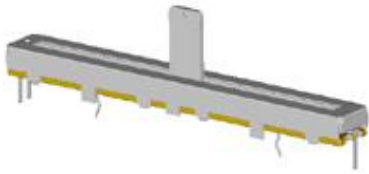

Features:(特點):

Excellent operating feeling by less lever wobble.
Horizontal type is blind constring capability using a crank lever
Horizontal,long-terminal type has a space between the main body and circuit board.

Applications(作用):

For fader control of mixers

Dimensions(規格圖):

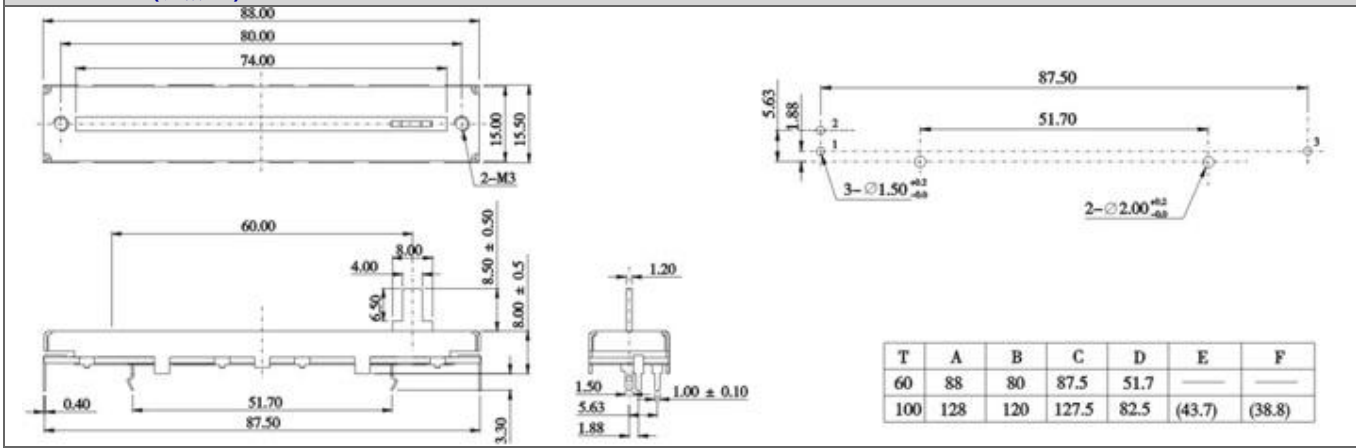

Specifications(規格)

Electrical Characteristics [電氣性能]

Total resistance [全阻抗值]	100Ω ~1MΩ
Total resistance tolerance [全阻抗值容許差]	±20%
Ratings power(w) [額定功率]	Travel 45mm B Single 0.25W,Dual 0.125W Except B single 0.125W,Dual 0.06W
Resistance taper [阻抗變化特性]	A,B,*C,D,W
Residual resistance(1-2/2-3) [殘留阻值]	10/20 Max
	20/30 Max
	30/50 Max
	50/70 Max
Sliding noise [滑動雜音]	100mV Max
Insulation resistance [絕緣阻抗]	100MΩ Min. at DC 250V.
Withstanding voltage [耐電壓]	1 minute at AC 300V
Max. operating voltage [最高使用電壓]	B Single 200V, Dual 200V Except B Single 150V,Dual 50V
Cang error:[運動誤差]	Volume[音量] -40dB ~0dB±3dB Max
	Tone [音質] ±3dB Max. at 50% position.

Mechanical Characteristics [機械性能]

Operation torque [滑動力矩]	30~250gf.cm
Stopper strength[止動強度]	5.0Kgf
Click slip out torque[掣子脫出力矩]	40~350gf.cm
Lever wobble[推柄搖晃]	2(2×L)/20mm Max. L=length of level
Position of click[推拉強度]	1C,7C,11C
Lever push-pull strength[推拉強度]	5.0Kgf. cm Max. at 5 sec.

Endurance Characteristics [耐久性能]

Rotational life [回轉壽命]	More than 15,000 cycles
--------------------------	-------------------------

