

PLEASE CHECK WWW.MOLEX.COM FOR LATEST PART INFORMATION

Part Number: [0352630915](#)
Status: **Active**
Description: 2.28/4.75mm (.090/187") Tab Housing, Female, 9 Circuits

Documents:

[Drawing \(PDF\)](#) [RoHS Certificate of Compliance \(PDF\)](#)

General

Product Family Crimp Housings
 Series [35263](#)
 Product Name N/A

Physical

Circuits (maximum) 9
 Color - Resin Brown, Gray (Dark)
 Gender Female
 Glow-Wire Compliant No
 Material - Resin Polyester
 Number of Rows 2
 Packaging Type Bag
 Panel Mount No
 Pitch - Mating Interface (in) 0.236 In
 Pitch - Mating Interface (mm) 6.00 mm
 Stackable No
 Temperature Range - Operating -40°C to +85°C

Material Info

Reference - Drawing Numbers

Sales Drawing [SD-35263-0915](#)

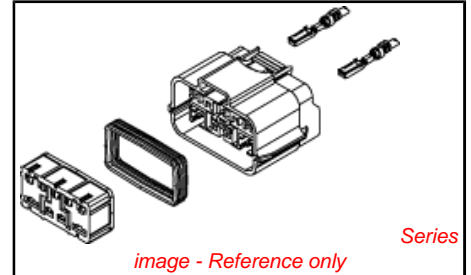

EU RoHS

ELV and RoHS Compliant
REACH SVHC
 Not Reviewed
Halogen-Free Status

China RoHS



Halogen-Free

Need more information on product environmental compliance?

Email productcompliance@molex.com
 For a multiple part number RoHS Certificate of Compliance, [click here](#)

Please visit the [Contact Us](#) section for any non-product compliance questions.

Search Parts in this Series

[35263Series](#)

Use With

[35407](#)

PLEASE CHECK WWW.MOLEX.COM FOR LATEST PART INFORMATION

ENC. NO. SD35263-0915

EDP NO.

SIMILAR ITEM

PROJECT NO.

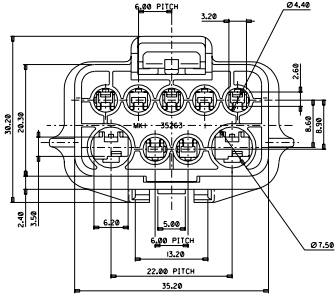
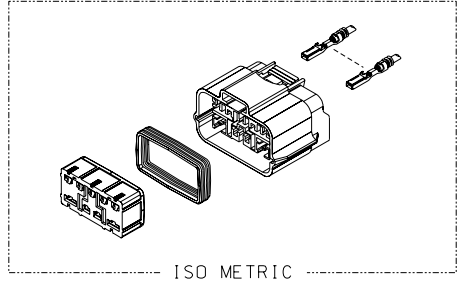
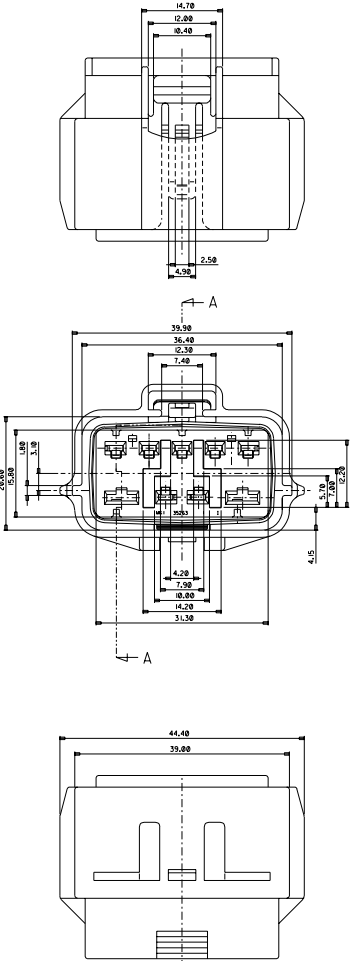

NOTE

1. APPLICABLE TERMINAL: FEMALE 35407-6702(S), 35407-6902(L) (.090 TYPE) MALE 35408-9702(S), 35408-9902(L)
2. APPLICATION CONNECTOR: SUMITOMO PART NO.(M 6195-0173)

NO.	PART NAME	PART NO.	MATERIAL	FINISH
1	FEMALE HSG 9P	SD35263-0995	PBT	DARK-GRAY
2	FRONT T.P.A	SD35264-0982	PBT	BROWN
3	FRONT SEAL	SD35903-0017	OIL SILICON	RED

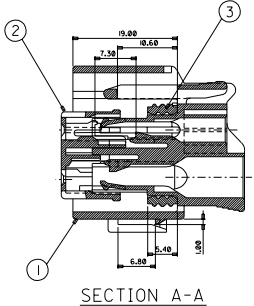

SECTION A-A

MATERIAL		SEE TABLE	MOLEX MOLEX-KOREA CO.,LTD.	
GENERAL TOLERANCE		DIMENSION : +0.30	DRAWN BY	CHK'D BY
ANGLE		1:1 REFERENCE	B.C.YOON	
DIMENSION CLASSIFICATION		▲ CRITICAL ▼ MAJOR	APPROD BY	SCALE
LTR REVISION RECORD		ECN DATE	ASSY PART DESCRIPTION	ENG. NO.
REVISE ONLY ON CAD SYSTEM				

THIS DRAWING CONTAINS INFORMATION THAT IS PROPRIETARY TO MOLEX(KOREA) AND SHOULD NOT BE USED WITHOUT WRITTEN PERMISSION: MX-A2(ANSI)-420,500