

GM4033

PNP EPITAXIAL PLANAR TRANSISTOR

Description

The GM4033 is designed for high current general purpose amplifier applications .

Package Dimensions

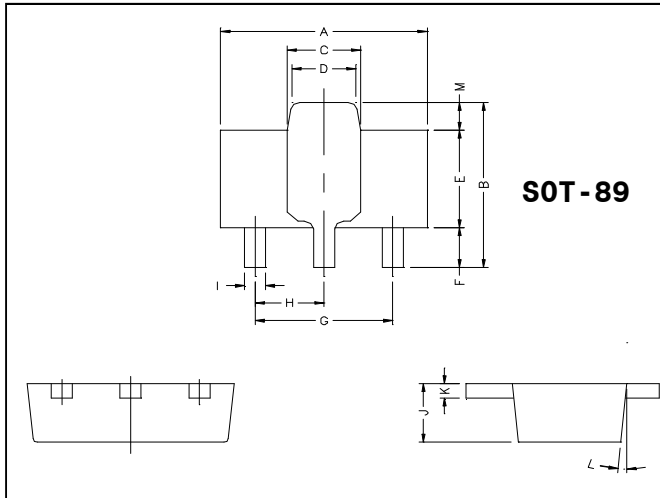

Marking :

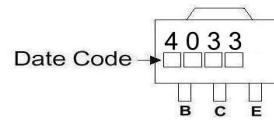

	Millimeter			Millimeter	
	Min.	Max.		Min.	Max.
A	4.4	4.6	G	3.00	REF.
B	4.05	4.25	H	1.50	REF.
C	1.50	1.70	I	0.40	0.52
D	1.30	1.50	J	1.40	1.60
E	2.40	2.60	K	0.35	0.41
F	0.89	1.20	L	5° TYP.	
			M	0.70 REF.	

Absolute Maximum Ratings (Ta = 25°C, unless otherwise specified)

Parameter	Symbol	Ratings	Unit
Junction Temperature	Tj	+150	°C
Storage Temperature	Tstg	-55 ~ +150	°C
Collector to Base Voltage	Vcbo	-80	V
Collector to Emitter Voltage	Vceo	-80	V
Emitter to Base Voltage	Vebo	-5	V
Collector Current(DC)	Ic	-1	A
Collector Power Dissipation	Pd	1.2	W

Electrical Characteristics (Ta = 25°C, unless otherwise specified)

Symbol	Min.	Typ.	Max.	Unit	Test Conditions
BVcbo	-80	-	-	V	Ic=-10uA, Ie=0
BVceo	-80	-	-	V	Ic=-10mA, Ib=0
BVebo	-5	-	-	V	Ic=-10uA
Icbo	-	-	-100	nA	Vcb=-60V
Iebo	-	-	-100	nA	VEB=-5V
*VCE(sat)1	-	-	-150	mV	Ic=-150mA, Ib=-15mA
*VCE(sat)2	-	-	-500	mV	Ic=-500mA, Ib=-50mA
*VBE(sat)1	-	-	-900	mV	Ic=-150mA, Ib=-15mA
*VBE(sat)2	-	-	-1.1	V	Ic=-500mA, Ib=-50mA
*hFE1	75	-	-		VCE=-5V, Ic=-0.1mA
*hFE2	100	-	-		VCE=-5V, Ic=-100mA
*hFE3	70	-	-		VCE=-5V, Ic=-500mA
*hFE4	25	-	-		VCE=-5V, Ic=-1A
fT	100	-	-	MHz	VCE=-10V, Ic=-50mA, f=100MHz
Cob	-	-	20	pF	VCE=-10V, Ie=0, f=1MHz

*Pulse Test:Pulse Width ≤380 us,Duty Cycle≤2% .

Characteristics Curve

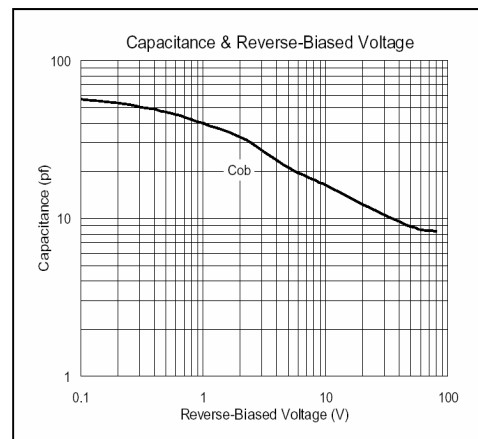
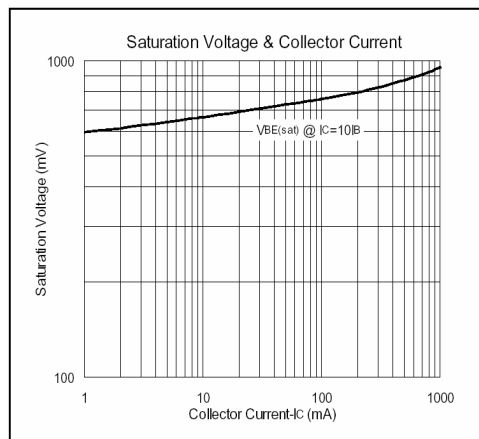
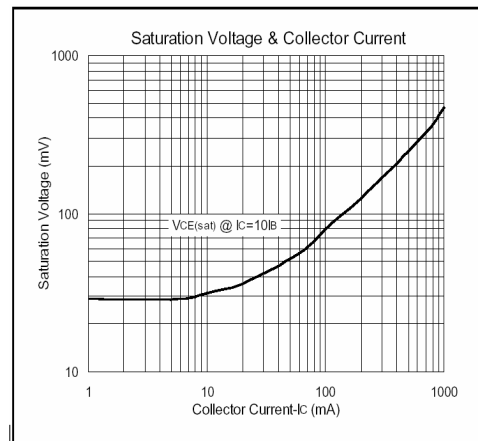
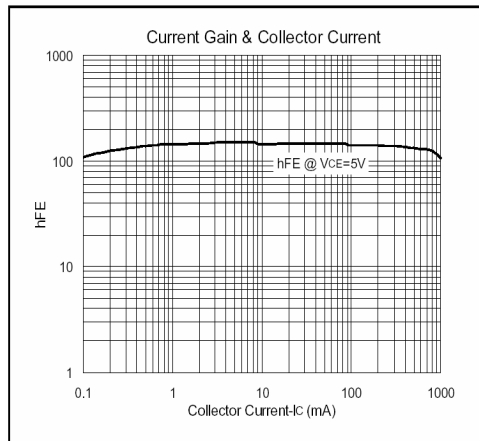

Important Notice:

- All rights are reserved. Reproduction in whole or in part is prohibited without the prior written approval of GTM.
- GTM reserves the right to make changes to its products without notice.
- GTM semiconductor products are not warranted to be suitable for use in life-support Applications, or systems.
- GTM assumes no liability for any consequence of customer product design, infringement of patents, or application assistance.

Head Office And Factory:

- **Taiwan:** No. 17-1 Tatung Rd. Fu Kou Hsin-Chu Industrial Park, Hsin-Chu, Taiwan, R. O. C.
TEL : 886-3-597-7061 FAX : 886-3-597-9220, 597-0785
- **China:** (201203) No.255, Jang-Jiang Tsai-Lueng RD., Pu-Dung-Hsin District, Shang-Hai City, China
TEL : 86-21-5895-7671 ~ 4 FAX :86-21-38950165