

GSM/DCS CIRCULATOR DROP-IN

Features

- Excellent IMD Performance
- Low Cost/High Volume
- Guaranteed Performance Over Temperature
- Circulation Direction — Forward or Reverse
- Custom Designs Available

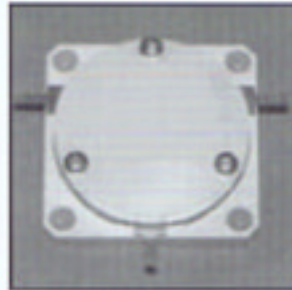

STRIPLINE CIRCULATOR
1795–1890 MHz
MODEL CF 102

Typical Specifications

	Typical	Max.	Min.
Insertion Loss	0.25 dB	0.30 dB	—
Isolation	22 dB	—	20 dB
VSWR	1.2:1	1.22:1	—
Power Rating* (Forward/Reverse)	200 W		
Size	1.0 x 1.0 x 0.33		
Operating Temp	-10 to +85°C Typical		

*Higher Power Available

**Other Configurations Available

Design and specifications subject to change without notice.

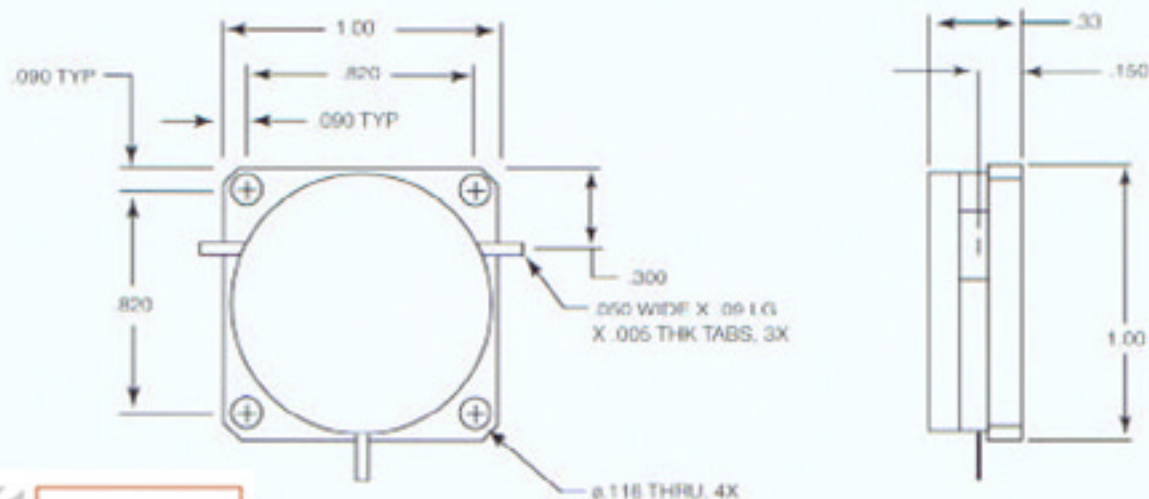

975 BENECIA AVENUE • SUNNYVALE, CA 94086 • TEL. 408.730.6300 • FAX 408.733.0254