

KVR667D2S5/2G

2GB 256M x 64-Bit DDR2-667

CL5 200-Pin SODIMM

DESCRIPTION:

This document describes ValueRAM's 256M x 64-bit 2GB (2048MB) CL5 DDR2-667 SDRAM (Synchronous **DRAM**) memory module. The components on this module include sixteen stacked 128M x 8-bit DDR2-667 SDRAM. This 200-pin SODIMM uses gold contact fingers and requires +1.8V. The electrical and mechanical specifications are as follows:

FEATURES:

| | |
|---|-------------------------------|
| ✓ Clock Cycle Time (tCK) CL=5 | 3ns (min.) / 8ns (max.) |
| ✓ Row Cycle Time (tRC) | 54ns (min.) |
| ✓ Refresh to Active/Refresh Command Time (tRFC) | 127.5ns |
| ✓ Row Active Time (tRAS) | 39ns (min.) / 70,000ns (max.) |
| ✓ Single Power Supply of | +1.8V (+/- .1V) |
| ✓ Power | 1.944 W (operating) |
| ✓ UL Rating | 94 V - 0 |

Note: The module defined in this data sheet is one of several configurations available under this part number. While all configurations are compatible, the DRAM combination and/or the module height may vary from what is described here. However, in no configuration will the module height exceed 30.00mm.

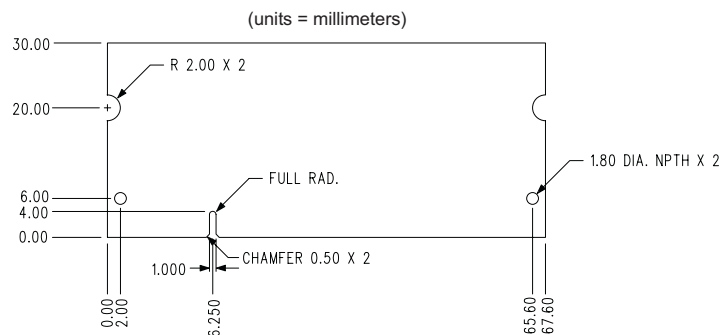
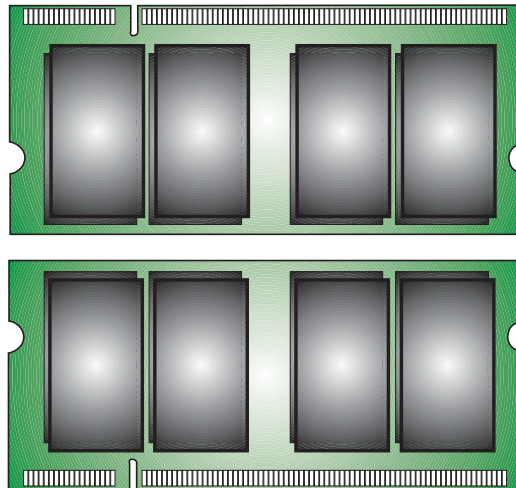

Figure 1: KVR667D2S5/2G 200-Pin SODIMM