

**How To Order: MS**

**Basic Specification**  
D38999

**Connector Material / Finish**  
N - CRES, Nickel  
Y - CRES, Passivated

**Insert Arrangement**  
Per MIL-STD-1560;  
See Pages B2 - B4

**Alternate Key Position**  
A, B, C, D, E  
(N = Normal)

**D38999**

**/23**

**Y**

**B**

**35**

**P**

**N**

**Shell Style**

/23 - Jam Nut Mount

**Shell Size**

A - 9    F - 19  
B - 11    G - 21  
C - 13    H - 23  
D - 15    J - 25  
E - 17

**Contact Termination**

P - Pin, Solder Cup    S - Socket, Solder Cup  
X - Pin, Eyelet        Z - Socket, Eyelet  
C - Pin, PCB            D - Socket, PCB  
Flex Feedthrough      Flex Feedthrough

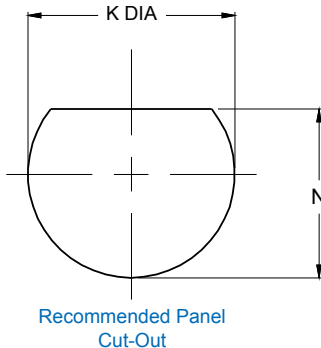
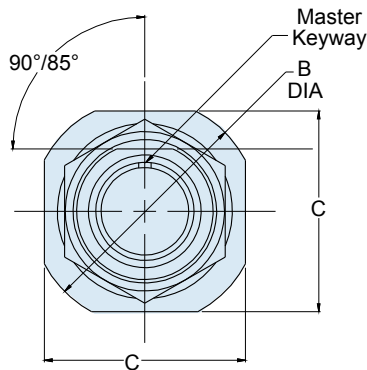
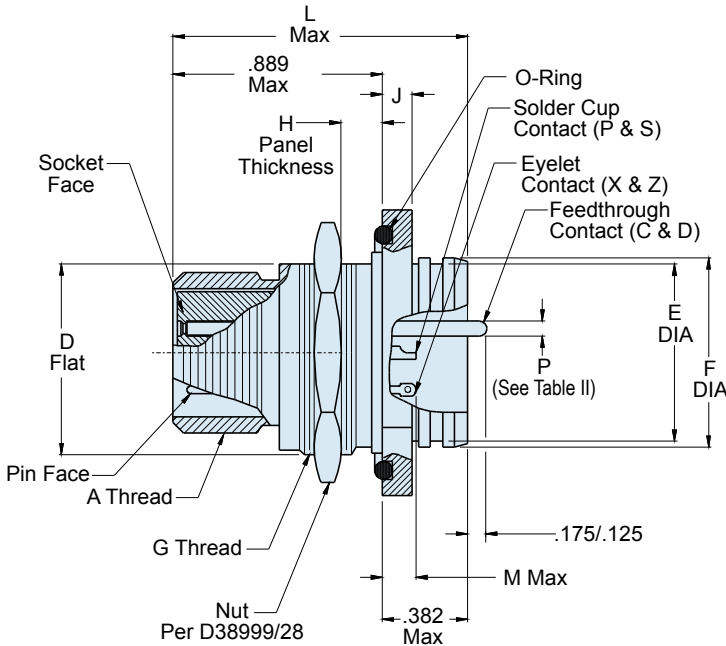
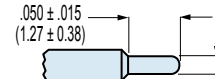

**TABLE II: CONTACT SIZE**

PRINTED CIRCUIT TAIL CONFIGURATIONS  
CONTACT STYLE C AND D



SIZE 12 AND SIZE 16



SIZE 22D AND SIZE 20

Contact Size	ø P
22D	.011 (0.28)
	.015 (0.38)
20	.024 (0.61)
	.028 (0.71)
16	.0635 (1.61)
	.0615 (1.56)
12	.095 (2.41)
	.093 (2.36)

**WIRE ACCOMODATION**

Contact Size	Wire Gauge
22D	#22 - #28
20	#20 - #24
16	#16 - #20
12	#12 - #14

**233-100-H7**  
**Jam Nut Mount Hermetic Receptacle**  
**MIL-DTL-38999 Series III Type**



MIL-DTL  
38999 Type

**How To Order: Commercial**

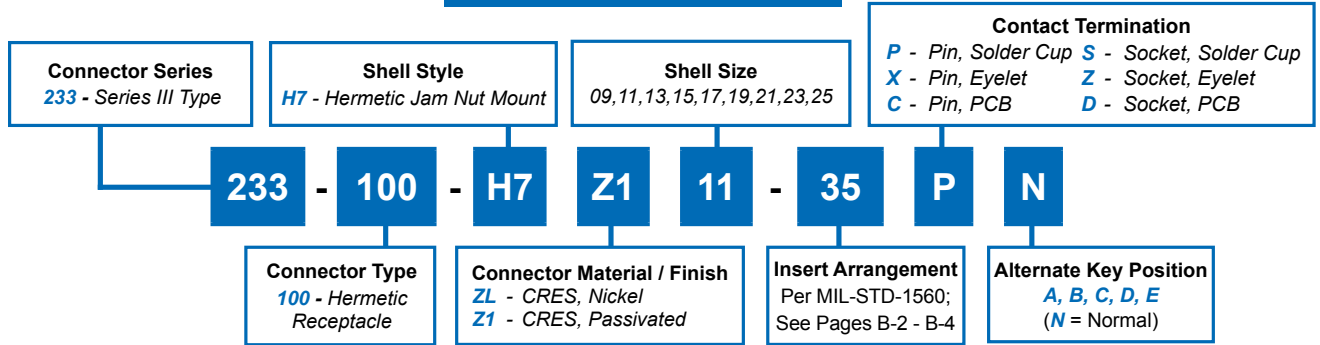

**B**

**TABLE I: CONNECTOR DIMENSIONS**

SHELL SIZE CODE	SHELL SIZE	A THREAD -0.1P-0.03L-TS	B DIA	C A/F ±.015(0.4)	D FLAT ±.005(0.1)	E DIA ±.012(0.3)	F DIA	G THREAD ISO METRIC	H ±.032(0.8)
A	9/09	0.625	1.200(30.5) 1.178(29.9)	1.063(27.0)	.650(16.5)	.603(15.3)	.653(16.6) .642(16.3)	M17 X 1.0-6g	.094(2.4)
B	11	0.750	1.385(35.2) 1.363(34.6)	1.252(31.8)	.750(19.1)	.725(18.4)	.775(19.7) .764(19.4)	M20 X 1.0-6g	.094(2.4)
C	13	0.875	1.511(38.4) 1.489(37.8)	1.374(34.9)	.937(23.8)	.851(21.6)	.905(23.0) .894(22.7)	M25 X 1.0-6g	.094(2.4)
D	15	1.000	1.637(41.6) 1.615(41.0)	1.500(38.1)	1.061(26.9)	.977(24.8)	1.031(26.2) 1.020(25.9)	M28 X 1.0-6g	.094(2.4)
E	17	1.187	1.763(44.8) 1.741(44.2)	1.626(41.3)	1.186(30.1)	1.103(28.0)	1.153(29.3) 1.142(29.0)	M32 X 1.0-6g	.094(2.4)
F	19	1.250	1.948(49.5) 1.926(48.9)	1.811(46.0)	1.311(33.3)	1.229(31.2)	1.278(32.5) 1.268(32.2)	M35 X 1.0-6g	.094(2.4)
G	21	1.375	2.074(52.7) 2.051(52.1)	1.937(49.2)	1.436(36.5)	1.351(34.3)	1.405(35.7) 1.394(35.4)	M38 X 1.0-6g	.094(2.4)
H	23	1.500	2.200(55.9) 2.177(55.3)	2.063(52.4)	1.561(39.6)	1.477(37.5)	1.531(38.9) 1.520(38.6)	M41 X 1.0-6g	.094(2.4)
J	25	1.625	2.322(59.0) 2.300(58.4)	2.189(55.6)	1.686(42.8)	1.603(40.7)	1.653(42.0) 1.642(41.7)	M44 X 1.0-6g	.094(2.4)

**TABLE I: (Continued) CONNECTOR DIMENSIONS**

J ±.008(0.2)	K DIA ±.005(0.1)	L MAX	M MAX		N ±.005(0.1)
			P&X	S&Z	
.106(2.7)	.705(17.9)	1.149(29.2)	.208(5.3)	.232(5.9)	.665(16.9)
.106(2.7)	.827(21.0)	1.149(29.2)	.208(5.3)	.232(5.9)	.764(19.4)
.106(2.7)	1.012(25.7)	1.153(29.3)	.200(5.1)	.224(5.7)	.950(24.1)
.106(2.7)	1.139(28.9)	1.153(29.3)	.200(5.1)	.224(5.7)	1.079(27.4)
.106(2.7)	1.266(32.2)	1.153(29.3)	.200(5.1)	.224(5.7)	1.203(30.6)
.138(3.5)	1.389(35.3)	1.185(30.1)	.200(5.1)	.224(5.7)	1.328(33.7)
.138(3.5)	1.512(38.4)	1.185(30.1)	.200(5.1)	.224(5.7)	1.454(36.9)
.138(3.5)	1.639(41.6)	1.185(30.1)	.200(5.1)	.224(5.7)	1.575(40.0)
.138(3.5)	1.764(44.8)	1.185(30.1)	.200(5.1)	.224(5.7)	1.704(43.3)

**HERMETIC LEAK RATE MOD CODES**

Designator	Required Leak Rate
-585A	1 x 10 <sup>-10</sup> cc's Helium per second
-585B	1 x 10 <sup>-9</sup> cc's Helium per second
-585C	1 x 10 <sup>-8</sup> cc's Helium per second