



● For GSM Repeater

**Absolute Maximum Rating**

Rating	Value
CW RF power Dissipation	+13dBm
DC Voltage between any 2 pins	± 30VDC
Operating Temperature	-10 to +60

**NE 71-0.2**  
71MHz SAW Filter

**Electrical Characteristic**

Characteristic	Unit	Minimum	Typical	Maximum
Center Frequency	MHz	70.984	71.00	71.016
Insertion Loss	dB		15.6	18
3dB Bandwidth	MHz	0.19	0.20	0.21
Attenuation (at $F_0 \pm 200\text{KHz}$ )	dB	11.5	12.0	
Attenuation (at $F_0 \pm 400\text{KHz}$ )	dB	45	50	
Attenuation (at $F_0 \pm 600\text{KHz}$ )	dB	60	63	
Ultimate rejection	dB	55	60	
Package	mm <sup>2</sup>		36×16	
Ambient Temperature			25	

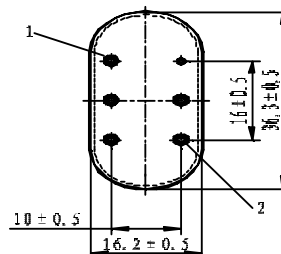
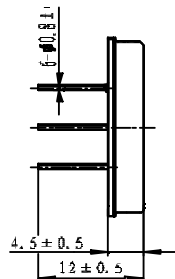
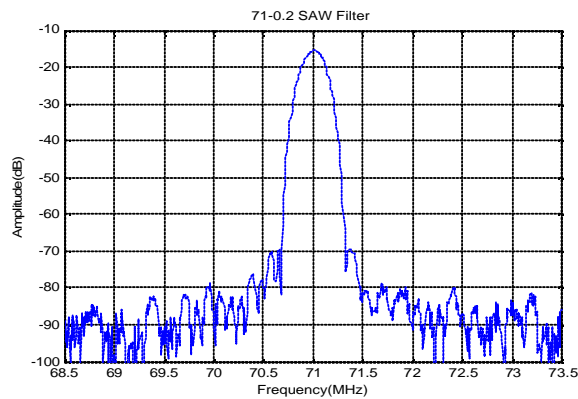

1: Input; 2: Output; other: ground.