



Micro Commercial Components

Micro Commercial Components  
20736 Marilla Street Chatsworth  
CA 91311  
Phone: (818) 701-4933  
Fax: (818) 701-4939

# MJE13003A

## NPN Silicon Plastic-Encapsulate Transistor

### Features

- Capable of 1.25Watts of Power Dissipation.
- Collector-current 1.5A
- Collector-base Voltage 700V
- Operating and storage junction temperature range: -55°C to +150°C
- Case Material: Molded Plastic. UL Flammability Classification Rating 94V-0

### Electrical Characteristics @ 25°C Unless Otherwise Specified

Symbol	Parameter	Min	Max	Units
<b>OFF CHARACTERISTICS</b>				
$V_{(BR)CEO}$	Collector-Emitter Breakdown Voltage ( $I_C=10mA, I_B=0$ )	400		Vdc
$V_{(BR)CBO}$	Collector-Base Breakdown Voltage ( $I_C=1000\mu A, I_E=0$ )	700		Vdc
$V_{(BR)EBO}$	Emitter-Base Breakdown Voltage ( $I_E=1000\mu A, I_C=0$ )	9.0		Vdc
$I_{CBO}$	Collector Cutoff Current ( $V_{CB}=700Vdc, I_E=0$ )		1000	$\mu A$
$I_{CEO}$	Collector Cutoff Current ( $V_{CE}=400Vdc, I_B=0$ )		500	$\mu A$
$I_{EBO}$	Emitter Cutoff Current ( $V_{EB}=9.0Vdc, I_C=0$ )		1000	$\mu A$

### ON CHARACTERISTICS

$h_{FE(1)}$	DC Current Gain ( $I_C=0.5A, V_{CE}=5.0Vdc$ )	8.0	40	
$h_{FE(2)}$	DC Current Gain ( $I_C=1.5mA, V_{CE}=5.0Vdc$ )	5.0		
$V_{CE(sat)}$	Collector-Emitter Saturation Voltage ( $I_C=1000mA, I_B=250mA$ )		1.0	Vdc
$V_{BE(sat)}$	Base-Emitter Saturation Voltage ( $I_C=1000mA, I_B=250mA$ )		1.2	Vdc
$V_{BE}$	Base-Emitter Voltage ( $I_E=2000mA$ )		3.0	Vdc

### SMALL-SIGNAL CHARACTERISTICS

$f_T$	Transistor Frequency ( $I_C=100mA, V_{CE}=10Vdc, f=1.0MHz$ )	5.0		MHz
$t_F$	Fall Time	$V_{CC}=100V, I_C=1.0$	0.5	$\mu S$
$t_S$	Storage Time	$A, I_{B1}=I_{B2}=0.2A$	2.5	$\mu S$

### TO-126

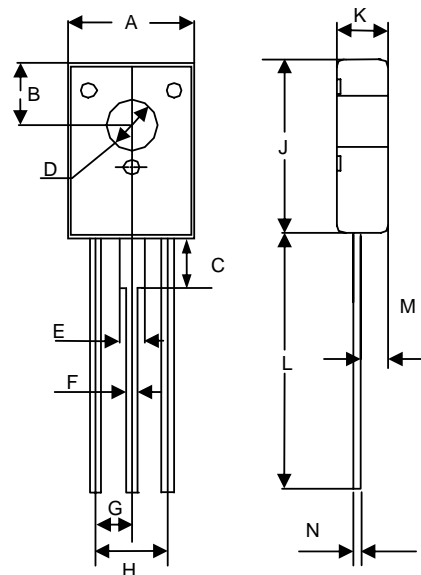

### DIMENSIONS

DIM	INCHES		MM		NOTE
	MIN	MAX	MIN	MAX	
A	0.291	0.307	7.40	7.80	
B	0.154	0.161	3.90	4.10	
C	0.083	0.091	2.10	2.30	
D	0.118	0.126	3.00	3.20	
E	0.046	0.056	1.17	1.37	
F	0.026	0.034	0.66	0.86	
G	0.09(Typ)		2.29(Typ)		
H	0.176	0.184	4.48	4.68	
J	0.417	0.433	10.60	11.00	
K	0.098	0.114	2.50	2.90	
L	0.602	0.618	15.30	15.70	
M	0.043	0.059	1.10	1.50	
N	0.018	0.024	0.45	0.60	

# MJE13003A

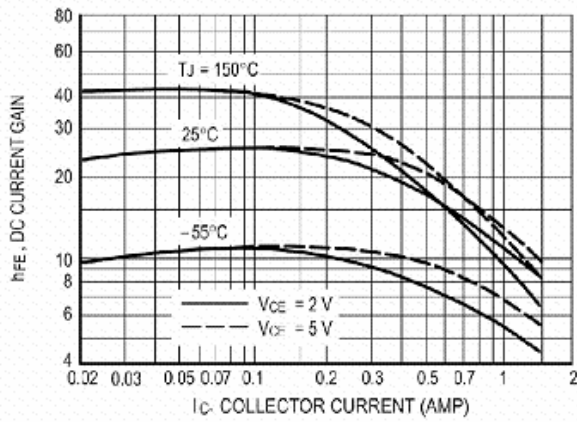

DC Current Gain

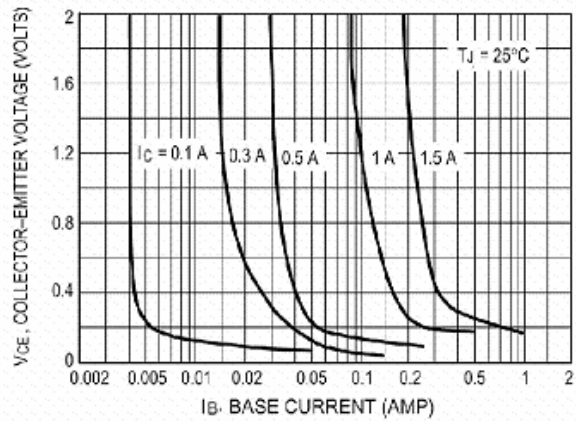

Collector Saturation Region

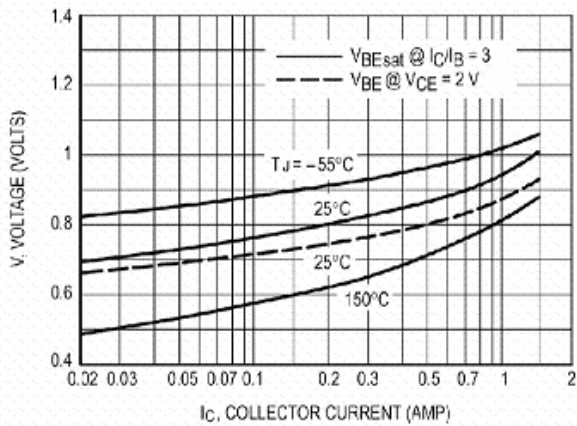

Base-Emitter Voltage

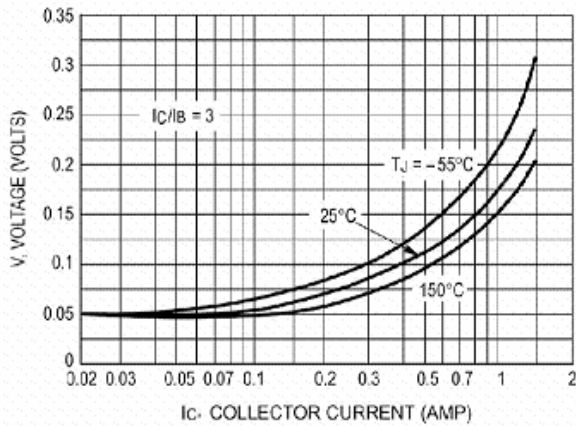

Collector-Emitter Saturation Region

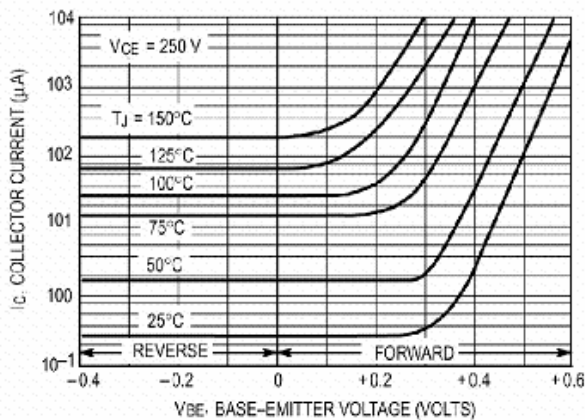

Collector Cutoff Region

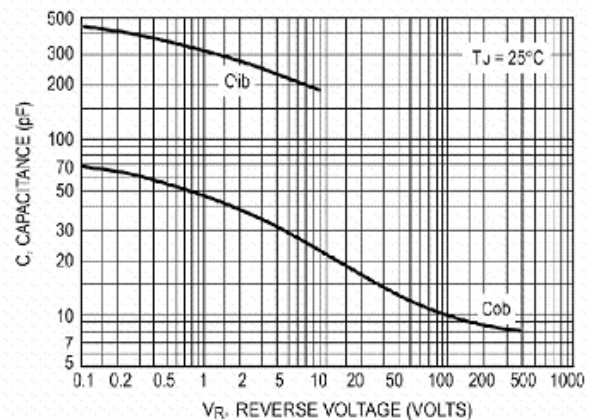

Capacitance



Micro Commercial Components

## Ordering Information

Device (Part Number)-BP	Packing Bulk;1Kpcs/Box
----------------------------	---------------------------

**\*\*\*IMPORTANT NOTICE\*\*\***

*Micro Commercial Components Corp.* reserves the right to make changes without further notice to any product herein to make corrections, modifications, enhancements, improvements, or other changes. *Micro Commercial Components Corp.* does not assume any liability arising out of the application or use of any product described herein; neither does it convey any license under its patent rights, nor the rights of others. The user of products in such applications shall assume all risks of such use and will agree to hold *Micro Commercial Components Corp.* and all the companies whose products are represented on our website, harmless against all damages.

**\*\*\*APPLICATIONS DISCLAIMER\*\*\***

Products offer by *Micro Commercial Components Corp.* are not intended for use in Medical, Aerospace or Military Applications.

[www.mccsemi.com](http://www.mccsemi.com)