



Micro Commercial Components

Micro Commercial Components
20736 Marilla Street Chatsworth
CA 91311
Phone: (818) 701-4933
Fax: (818) 701-4939

2SA1213
2SA1213-O
2SA1213-Y

Features

- Low Saturation voltage: $V_{CE(sat)}=0.5V(max.)(I_C=1.0A)$
- Small flat package
- $P_C=1.0$ to $2.0W$ (mounted on ceramic substrate)
- High Speed Switching Time : $t_{stg}=1.0\mu s(typ.)$
- Case Material: Molded Plastic. UL Flammability Classification Rating 94V-0 and MSL Rating 1

Maximum Ratings

Symbol	Rating	Rating	Unit
V_{CEO}	Collector-Emitter Voltage	-50	V
V_{CBO}	Collector-Base Voltage	-50	V
V_{EBO}	Emitter-Base Voltage	-5.0	V
I_C	Collector Current	-2.0	A
I_B	Base Current	-0.4	A
P_C	Collector power dissipation	0.5 1.0*	W
T_J	Junction Temperature	150	°C
T_{STG}	Storage Temperature	-55 to +150	°C

* Mounted on ceramic substrate ($250mm^2 \times 0.8t$)

Electrical Characteristics @ 25°C Unless Otherwise Specified

Symbol	Parameter	Min	Typ	Max	Units
--------	-----------	-----	-----	-----	-------

OFF CHARACTERISTICS

$V_{(BR)CEO}$	Collector-Emitter Breakdown Voltage ($I_C=10mA, I_B=0$)	-50	---	---	Vdc
I_{CBO}	Collector-Base Cutoff Current ($V_{CB}=50Vdc, I_E=0$)	---	---	-0.1	μA
I_{EBO}	Emitter-Base Cutoff Current ($V_{EB}=5.0Vdc, I_C=0$)	---	---	-0.1	μA

ON CHARACTERISTIC

$h_{FE(1)}$	DC Current Gain ($I_C=0.5A, V_{CE}=2.0Vdc$)	70	---	240	---
$h_{FE(2)}$	DC Current Gain * ($I_C=2.0A, V_{CE}=2.0Vdc$)	20	---	---	---
$V_{CE(sat)}$	Collector-Emitter Saturation Voltage ($I_C=1.0A, I_B=0.05A$)	---	---	-0.5	Vdc
$V_{BE(sat)}$	Base-Emitter Saturation Voltage ($I_C=1.0A, I_B=0.05A$)	---	---	-1.2	Vdc
f_T	Transition Frequency ($V_{CE}=2.0Vdc, I_C=0.5A$)	100	120	---	MHz
C_{ob}	Collector output capacitance ($V_{CB}=10Vdc, f=1.0MHz$)	---	40	---	pF

* $h_{FE(1)}$ classification O:70-140, Y:120-240

CLASSIFICATION OF $h_{FE(1)}$

Rank	O	Y
Range	70-140	120-240
Marking	NO	NY

PNP Silicon Epitaxial Transistors

SOT-89

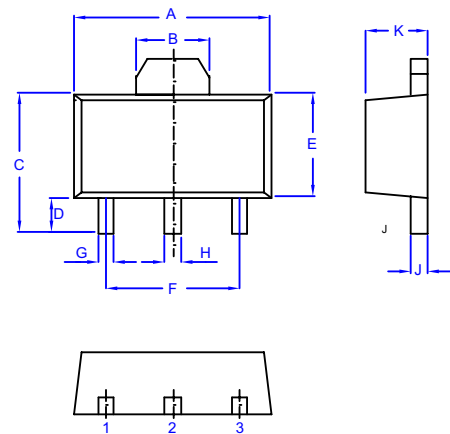

1. Emitter
2. Collector
3. Base

DIM	DIMENSIONS				NOTES
	INCHES		MM		
A	.173	.181	4.39	4.60	
B	.063	.071	1.60	1.80	
C	.154	.165	3.91	4.19	
D	.031	.039	0.80	1.00	
E	.092	.100	2.34	2.54	
F	.118	----	3.00	----	TYP
G	.013	.019	0.33	0.48	
H	.015	.021	0.38	0.53	
J	.015	.016	0.38	0.41	
K	.055	.063	1.40	1.60	

www.mccsemi.com

Typical Characteristic

2SA1213

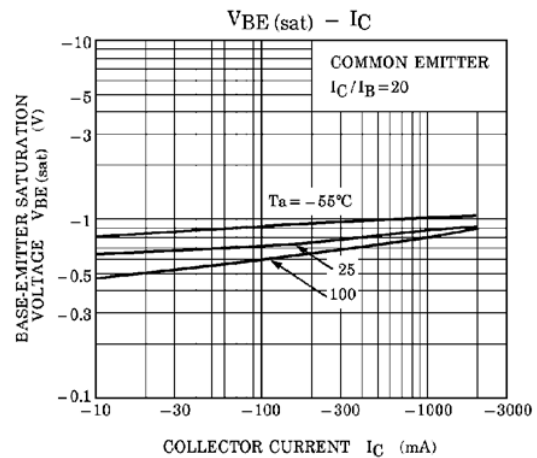
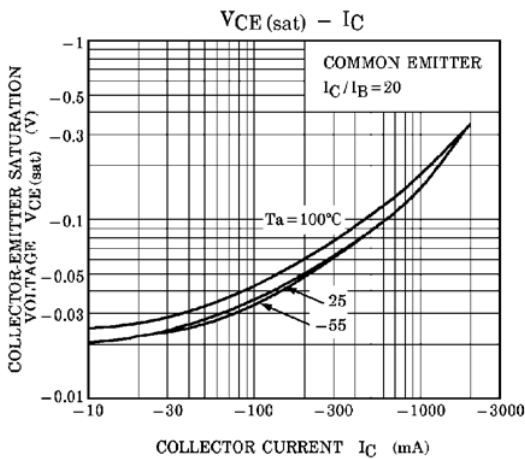
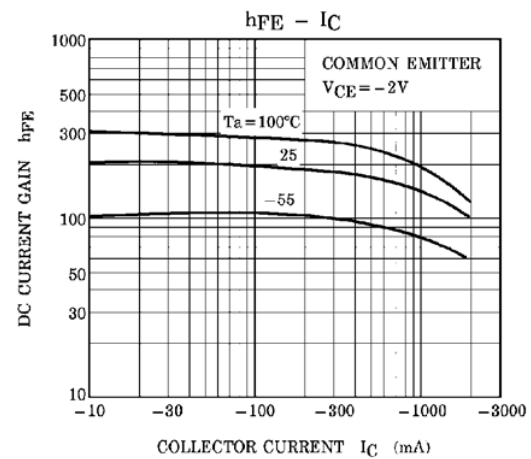
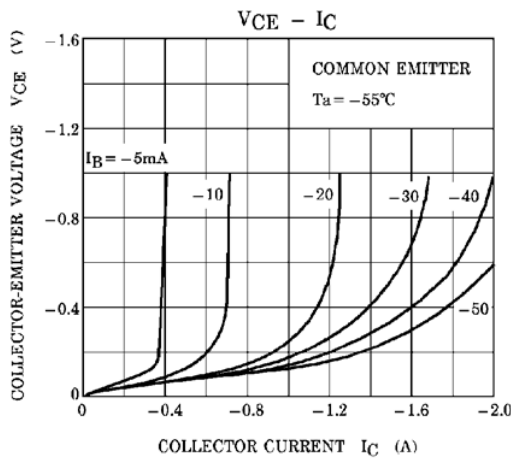
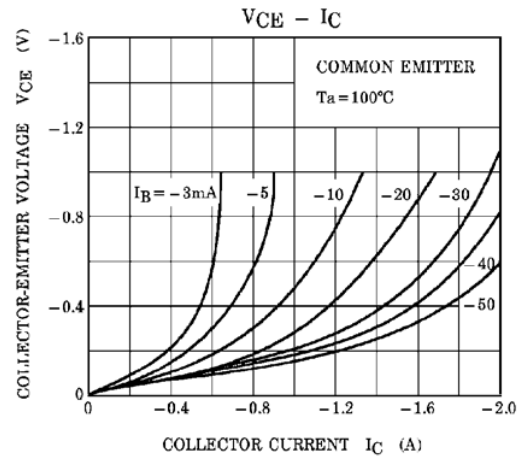
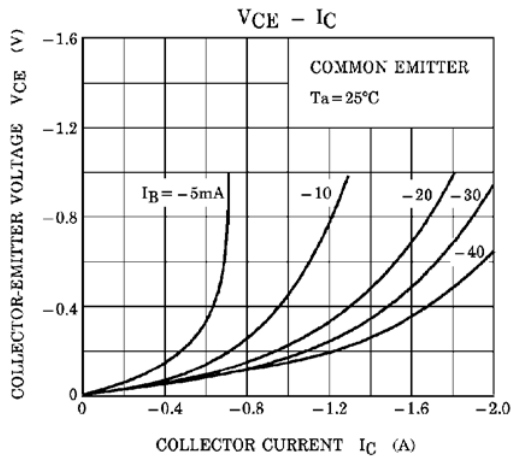

Typical Characteristics

2SA1213

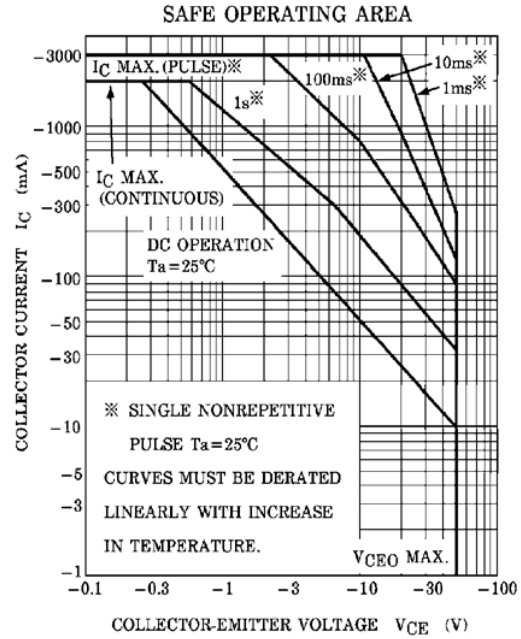
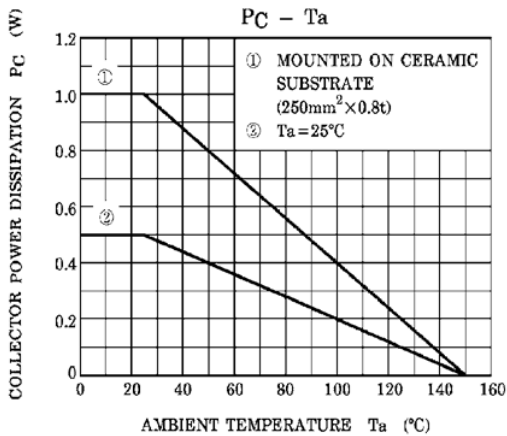
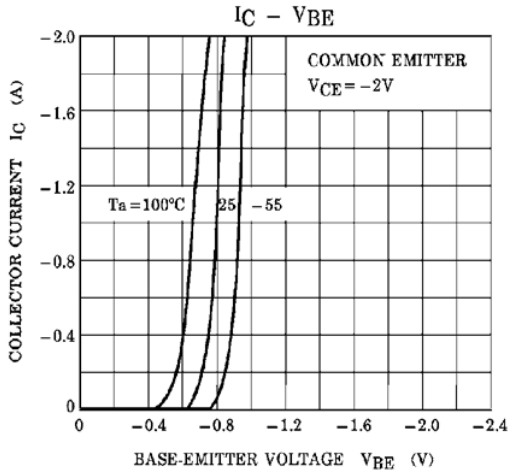



Micro Commercial Components

Ordering Information

Device	Packing
(Part Number)-TP	Tape&Reel;1Kpcs/Reel

IMPORTANT NOTICE

Micro Commercial Components Corp .reserves the right to make changes without further notice to any product herein to make corrections, modifications , enhancements , improvements , or other changes .
Micro Commercial Components Corp .does not assume any liability arising out of the application or use of any product described herein; neither does it convey any license under its patent rights ,nor the rights of others . The user of products in such applications shall assume all risks of such use and will agree to hold *Micro Commercial Components Corp* .and all the companies whose products are represented on our website, harmless against all damages.

APPLICATIONS DISCLAIMER

Products offer by *Micro Commercial Components Corp* . are not intended for use in Medical, Aerospace or Military Applications.