



Absolute Maximum Ratings at $T_A = 25^\circ\text{C}$

Parameter	Value
DC Forward Current ^[1]	350mA
Peak Pulsed Forward Current ^[2] (Duty Ratio = 1/10, Pulse Width = 10ms)	500mA
Reverse Voltage ($I_R = 10\mu\text{A}$)	>5V
LED Junction Temperature	120°C
Storage Temperature	-40°C to +100°C

Device Selection Guide

Part Number	Color Temperature(K) @ $I_F = 350\text{ mA}$			Total Lumincus Flux $\Phi_V(\text{lm})$ @ $I_F = 350\text{ mA}$		Forward Voltage V_F @ $I_F = 350\text{ mA}$		Viewing Angle $2\theta_{1/2}$	Epoxy Color
	Min.	Typ.	Max.	Min.	Typ.	Typ.	Max.	Typ.	
LM2525WC-E	5000	6500	10000	15	23	3.3	3.8	110	Clear

Package Dimensions

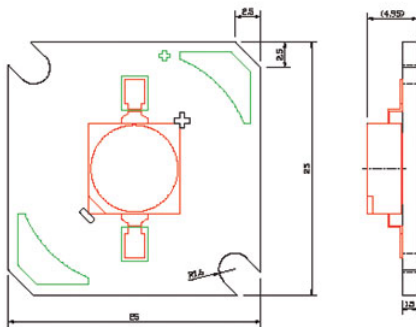

Notes:

- The cathode lead of the component is denoted by a chamfer shape on the top surface of plastic housing.
- All dimensions are in millimeters.
- All dimensions without tolerances are for reference only.

Beam Pattern

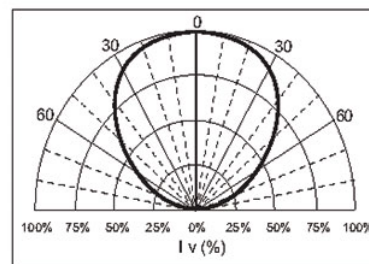



Electrical / Optical Characteristics

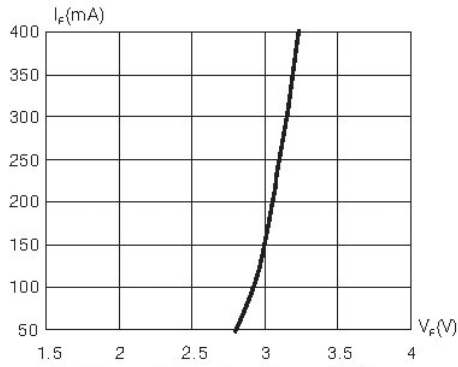

Fig.1 Forward Current vs. Forward Voltage

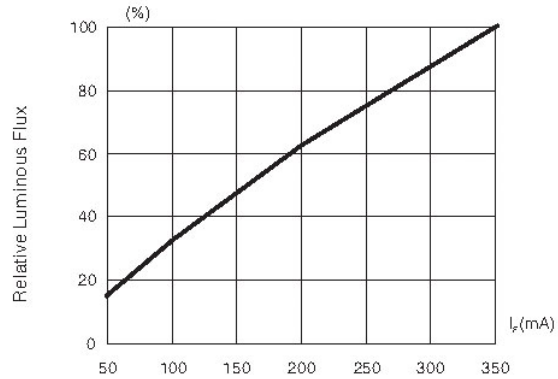

Fig.2 Luminous Flux vs. Forward Current

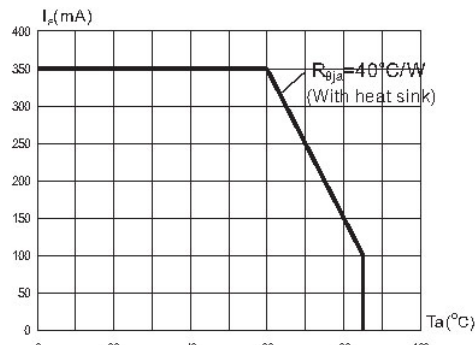

Fig.3 Allowable Forward Current vs. Ambient Temperature

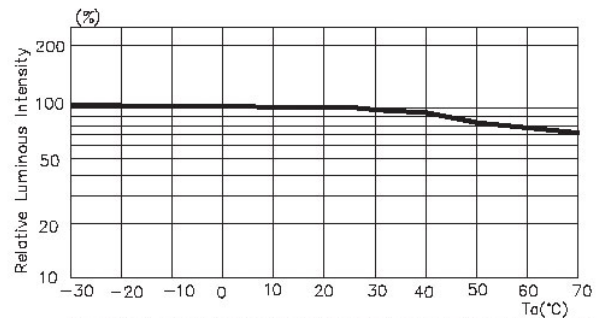

Fig.4 Luminous Intensity at $I_f=350\text{mA}$ vs. Ambient Temperature

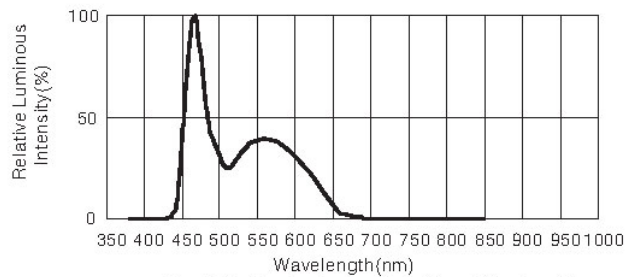

Fig.5 Relative Luminous Intensity vs. Wavelength