



1732.5 MHz Ceramic Bandpass Filter

P/N: AM1732B1194

Center frequency(F0)	1732.5 MHz
Bandwidth(BW)	F0 ±22.5MHz
Insertion Loss in BW	2.0 dB max
Ripple in BW	0.7 dB max
VSWR	1.7 : 1
Attenuation	50dB min 2017.2MHz~2062MHz 50dB min 3420MHz~3510MHz
In/Out Impedance	50 Ohm
Operating Temp Range	-20 ~ 70°C
Power Handling	2 watt min
This product is RoHs compliant	

DIMENSION:

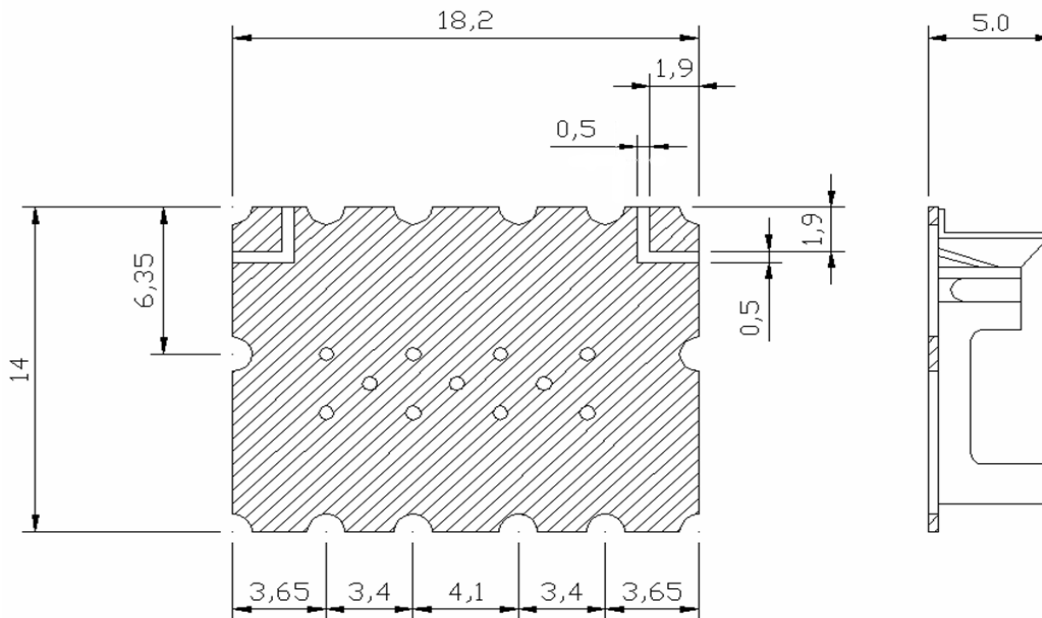

Unit : mm
Tolerance : ± 0.3

