

**Characteristics**

$C_N$	$\Delta$	3x 154 $\mu$ F $\pm$ 5 %	
$U_N$		AC 525 V	
$f_N$		50 Hz	60 Hz
$Q_N$		40 kvar	48 kvar
$I_N$		3x 44 A	53 A
$\tan\delta_0$		0,2 W/kvar (dielectric)	

**Maximum ratings**

$U_{max}$	AC 580 V, 8 h daily
	AC 680 V, 1 min
$I_{r(40)}$	3x 85 A ( $\Theta_A = 40^\circ\text{C}$ , $U_N$ )
$I_s$	13 kA
$(du/dt)_{max}$	20 V/ $\mu$ s
$(du/dt)_s$	50 V/ $\mu$ s

**Test data**

$U_{TT}$	AC 1150 V, 10 s
$U_{TC}$	AC 3000 V, 10 s
$\tan\delta$ (50 Hz)	$\leq$ 0,3 W/kvar (total)

**Climatic category -40/D**

$\Theta_{min}$	-40 °C
$\Theta_{max}$	+55 °C
Humidity	Max. relative Humidity $\leq$ 95 %
$\Theta_{stg}$	-55 bis +70 °C

**Life expectancy**

$t_{LD}$	100 000 h
----------	-----------

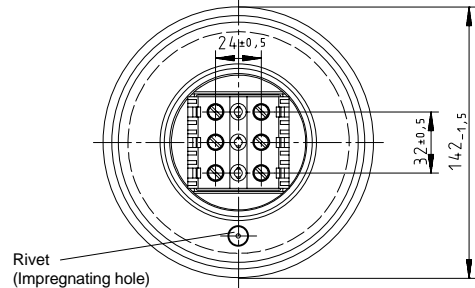
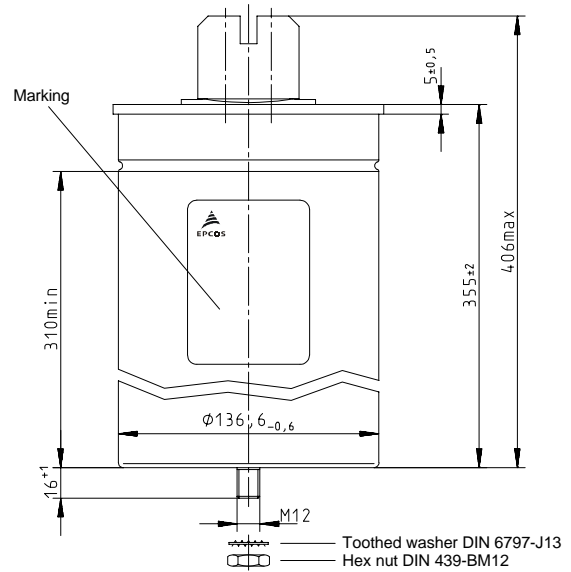

Dimensions in mm

**Design data**

Dimensions $\Phi$ x l	142 x 355 mm (5,59 x 13,98 in)
Approx. weight	4,7 kg (10,4 lb)
Impregnation	Gas
Fixing	Threaded bolt M12
Mounting hole	14 mm (0,55 in)
Max. torque	10 Nm
Terminals	Isolated terminal, IP20
Max. torque	2,5 Nm
Terminal cross section	35 mm <sup>2</sup> (2 AWG)
Creepage distance	15 mm (0,59 in)
Clearance	12 mm (0,47 in)
Overpressure disconnecter	
Upright mounting position	

**Remarks**

Natural cooling