

Switchbox TRG30RA Series

30W SINGLE OUTPUT AC/DC SWITCHING ADAPTER

Features

- Universal Input Range 90-264VAC
- Interchangeable AC Plugs
- Meets EN61204-3 Class B and CISPR/FCC Class B, Conducted
- Continuous Short Circuit Protection
- Over Voltage Protection
- CEC Level IV Compliant (Output Cable Length 1800mm) (TRG30RA090: Output Cable Length 1220mm)



Specifications

INPUT

Input range	90-264VAC.
Frequency	47-63 Hz.
Input current	0.8 max.
Inrush current	50A max @ 240VAC.
Isolation	4242VDC, input to output.
Leakage current	0,25mA max.

OUTPUT

Hold-up time	10mS typ. @ 115VAC.
Short circuit protection	Continuous (auto-recovery).
Over voltage protection	Yes.

ENVIRONMENTAL

Operating temperature	0°C to +40°C.
Storage temperature	-20°C to +85°C.
Cooling	Natural convection.

GENERAL

Dimensions	108,67 x 61,98 x 36,70 mm.
Weight	300g.



DERATING CURVE

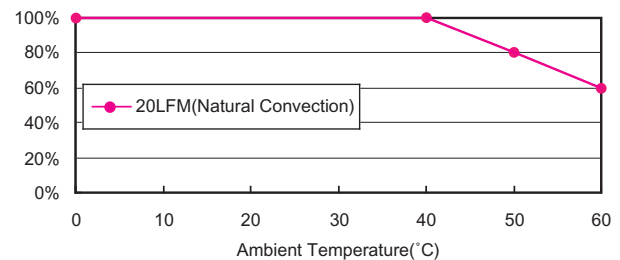

Note:

1. Voltage setpoint at 60% load.
2. Add a 0.1µF ceramic capacitor and a 10µF E.L. capacitor to output for Ripple & Noise measuring @20MHz BW
3. Line regulation measured from 100Vac to 240Vac, full load
4. Load regulation measured from 60% to full load and from 60% to 20% load (60% +/- 40% load)

ORDERING INFORMATION			
TRG30RAXXX - XX	E	XX	XX - BK
Model Number	DC Plug Type	DC Cable Length and Type	Colour of Overmold Case
	* Please see configuration datasheet for more detailed descriptions	01 : 720mm 02 : 1200mm 03 : 1800mm 11 : 720mm with Ferrite Core 12 : 1200mm with Ferrite Core 13 : 1800mm with Ferrite Core * 18AWG / UL1185	BE : Blue GY : Gray RD : Red PE : Purple OR : Orange

MODEL NUMBER	OUTPUT VOLTAGE	MAX LOAD	MIN LOAD	RIPPLE & NOISE	VOLTAGE ACCURACY	LINE REGULATION	LOAD REGULATION	SWITCHING FREQUENCY	EFFICIENCY MIN
TRG30RA090	9 V	3.3 A	0 A	±1%	±2%	±1%	±3%	60KHz typ	78%
TRG30RA120	12 V	2.5 A	0 A	±1%	±2%	±1%	±2%	60KHz typ	79%
TR1G30RA150	15 V	2.0 A	0 A	±1%	±2%	±1%	±2%	60KHz typ	81%
TRG30RA180	18 V	1.65 A	0 A	±1%	±2%	±1%	±2%	60KHz typ	81%
TRG30RA240	24 V	1.25 A	0 A	±1%	±2%	±1%	±2%	60KHz typ	83%

Switchbox TRG30RA Series

30W SINGLE OUTPUT AC/DC SWITCHING ADAPTER

All Dimensions In Inches(mm)
 Tolerance Inches: x.xxx= ±0.02
 Millimeters: x.xx= ±0.5

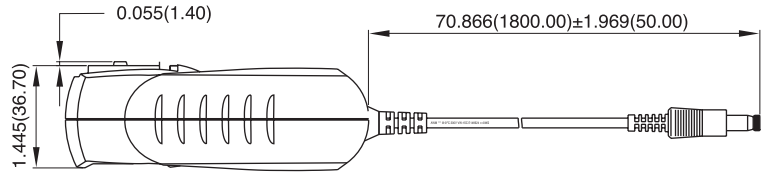
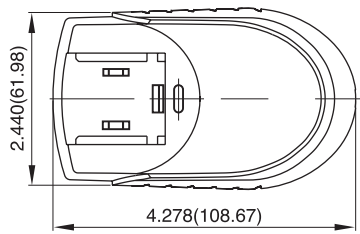

DC Plug type: V+ -- ● -- V-
 DC Plug: Straight (ø5.5/ø2.1) L12mm
 18AWG/1800mm

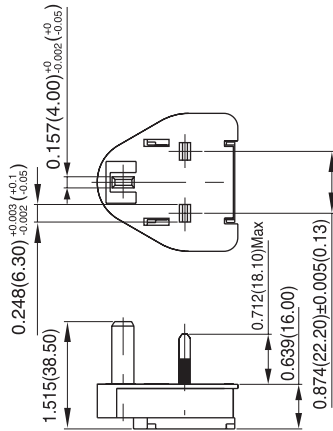

P/N: G8709302020

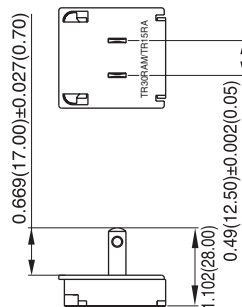

P/N: G8709102020

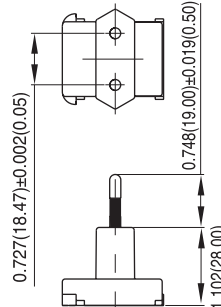

P/N: G8706402020

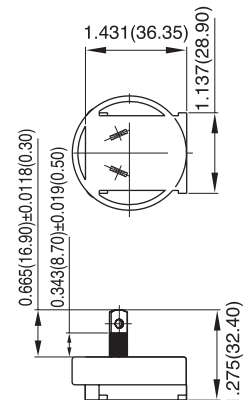

P/N: G8706602020

All specifications typical at nominal line, full load and 25°C unless otherwise noted.