

SPECIFICATIONS

CONTACT RATING:Q: 1A @120 VAC or 28 VDC
 ELECTRICAL LIFE: 50,000 make-and-break cycles at full load
 CONTACT RESISTANCE: 20 m Ω max. initial @2-4 VDC,100 mA
 INSULATION RESISTANCE: 1,000 M Ω min.
 DIELECTRIC STRENGTH: 1,500 V RMS @ sea level.
 OPERATING TEMPERATURE: -30 $^{\circ}$ C to 85 $^{\circ}$ C

MATERIALS

CASE - diallyl phthalate (DAP)
 PLUNGER - thermoplastic polyester
 BUSHING - Brass , nickel plated
 HOUSING - Stainless Steel
 CONTACT AND TERMINAL - Copper alloy , silver plated
 SWITCH SUPPORT - Brass , tin-lead

How do you build the switches you need!!

The TS-21 / TS-22 , please see the (A) ;

The TS-21A/TS-21B/TS-22A/TS-22B, please see the (B)

1

(A) TS - 21 - CV - 2 - S B Q - E - A5

Switches Function		Cap		Cap color	Bushing		Epoxy seal		Vertical support Bracket		
TS-21	SPST off-mon.	(none)	none	1	S	10-48 thd.(FLAT)	5.59	(none)	none seal	(none)	(std)straight type snap-in type
TS-22	SPDT on-mon.	CV	5.08	2	U	none thd.(FLAT)	5.59	E	epoxy seal	A5	
		CV1	7.62	3	T	none thd.(ROUND)	5.59			A5S	
		F22A	With frame	4	V	1/4-40 thd.	7.87				
				5	S9	flush					
				6	Termination						
				7	B	solder lug					
				8	C	P.C					
				9	D	wire wrap					
					Contact Material						
					Q	silver plated					
					R	gold plated					
					G	gold over silver					
					K	gold / tin-lead					

*The "F22A" only apply for "TS-21".

(B) TS - 21A - CV1 - 2 - U Q - E -

Horizon Right Angle	Vertical Right Angle	Switches Function	Cap		Bushing		Epoxy seal		
TS-21A	TS-21B	SPST off-mom.	(none)	none	S	10-48 thd.(FLAT)	5.59	(none)	none seal
TS-22A	TS-22B	SPDT on-mom.	CV	5.08	U	none thd.(FLAT)	5.59	E	epoxy seal
			CV1	7.62	T	none thd.(ROUND)	5.59		
					S9	flush			
			Cap color		Contact Material				
			1	white	Q	silver plated			
			2	black	R	gold plated			
			3	red	G	gold over silver			
			4	orange	K	gold / tin-lead			
			5	yellow					
			6	green					
			7	Blue					
			8	Brown					
			9	Gray					
					support Bracket				
					(none)	Std. straight type			
					S	snap-in type			

SPST

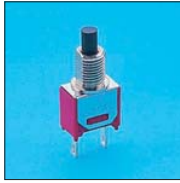

Model No.	Switching position	
TS-21	off	Mom
Term. Comm.	open	1-2

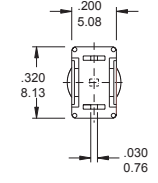
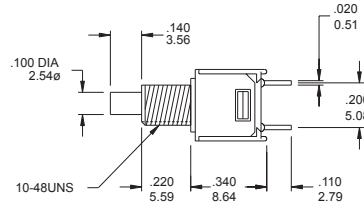
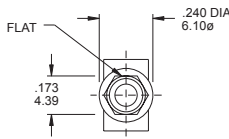
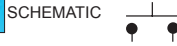

TS-21- SBQ

SPST



Model No.	Switching position	
TS-21A	off	Mom
Term. Comm.	open	1-2

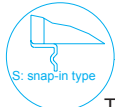
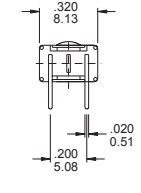
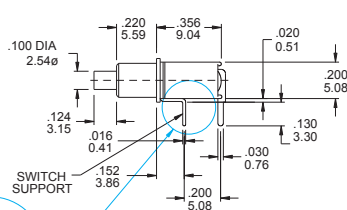
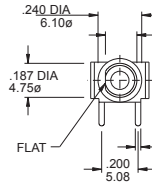
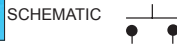

TS-21A- UQ /TS-21A-UQ-S

SPST



Model No.	Switching position	
TS-21B	off	Mom
Term. Comm.	open	1-2

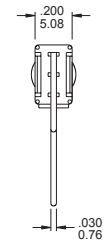
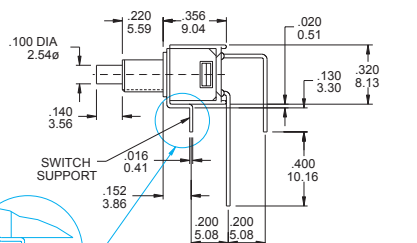
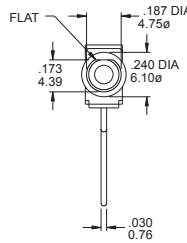

TS-21B- UQ / TS-21B-UQ-S

SPDT



Model No.	Switching position	
TS-22	On	Mom
Term. Comm.	2-1	2-3

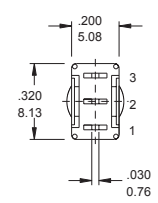
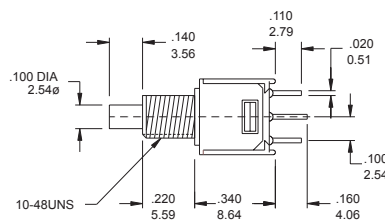
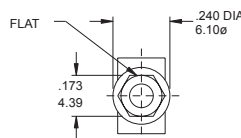

TS-22- SBQ

SPDT



Model No.	Switching position	
TS-22A	On	Mom
Term. Comm.	2-1	2-3

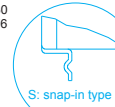
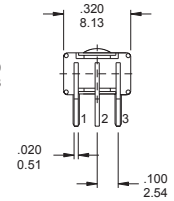
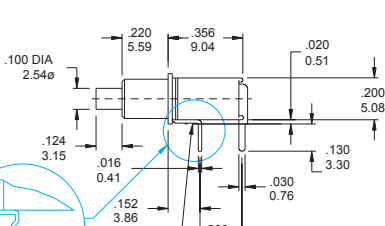
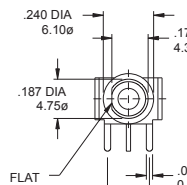

TS-22A- UQ / TS-22A-UQ-S

SPDT



Model No.	Switching position	
TS-22B	On	Mom
Term. Comm.	2-1	2-3

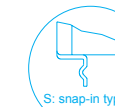
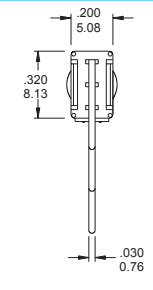
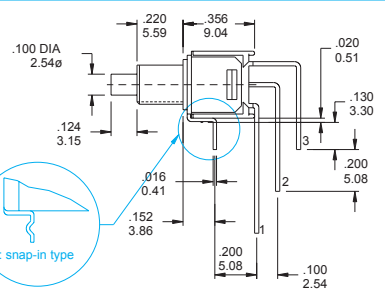
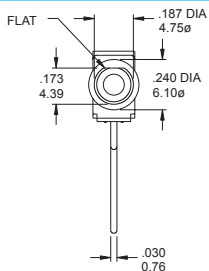

TS-22B- UQ / TS-22B-UQ-S

Cap and Actuator Option

Cap color Option

CV

CV1



F22A

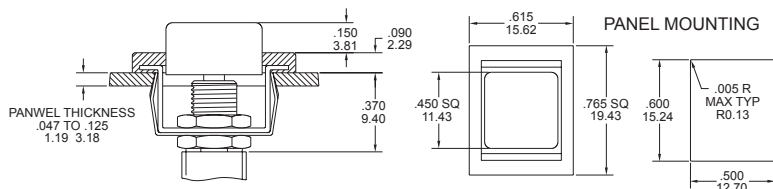

THIS ACTUATOR ONLY APPLY MODEL NO. TS-21 (SPST)

CAP & ACTUATOR OPTIONS	
1	White
2	Black(Std.)
3	Red
4	Orange
5	Yellow
6	Green
7	Blue
8	Brown
9	Gray

Bushing Option

S

U

T

V : thd.

S9

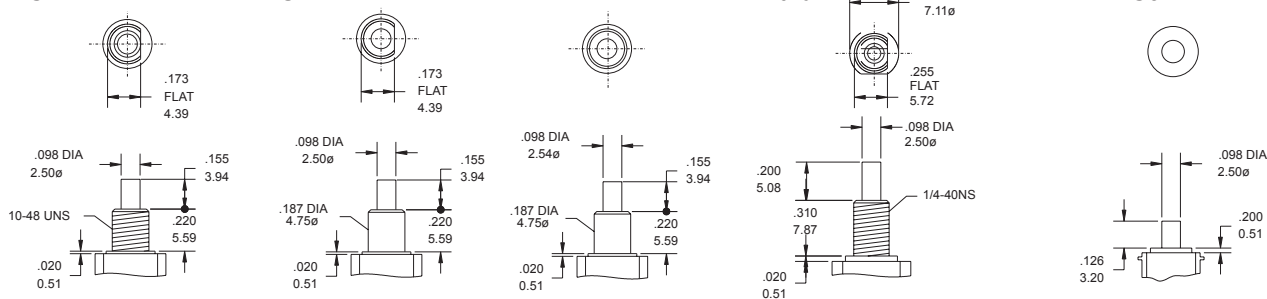

TERMINAL OPTION (ONLY FOR THE TS-21 / TS-22)

Terminal Seal Option

B Solder Lug(STD)

C PRINTED CIRCUIT

D Wire Wrap

DPDT

-E Terminal Seal

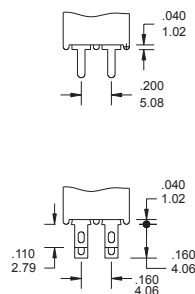
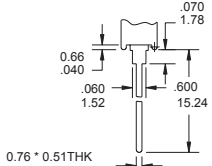
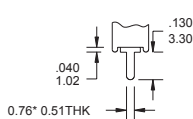
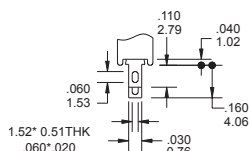

P.C.B MOUNTING DIMENSION

PANEL MOUNTING DIMENSION

TS-21 (PC terminal)

TS-21A

TS-21B

10-48 BUSHING

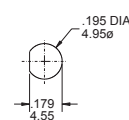
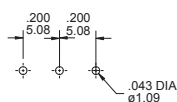
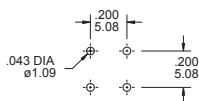
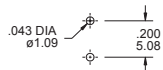

TS-22 (PC terminal)

TS-22A

TS-22B

1/4 IN. BUSHING

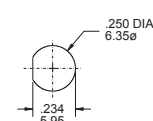
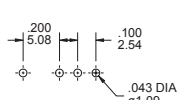
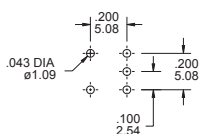
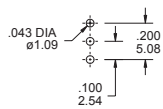

CONTACT MATERIAL OPTIONS

CODE	CONTACT MATERIAL	TERMINAL MATERIAL	RATING
Q	Silver plated	Silver plated	1 A @ 120V AC or 28 V DC;
R	Gold plated over nickel plated	Gold plated over nickel plated	0.4VA MAX @ 20 V AC or DC MAX
G	Gold plated over silver plated	Gold plated over silver plated	0.4 VA MAX @ 20 V AC or DC MAX or 1 A @ 120V AC or 28 V DC;
K	Gold plated over nickel plated	Tin-lead over nickel plated	0.4VA MAX @ 20 V AC or DC MAX

* THE K option is only for some special item. Please inquiry first when you need the "K" option

VERTICAL SUPPORT BRACKET OPTION
only for the TS21/TS22 . If you need the vertical support support bracket , Choose the terminal option in "C" code

A5/ A5S



SPST

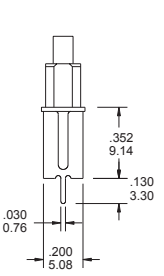

TS-21-UCQ-A5

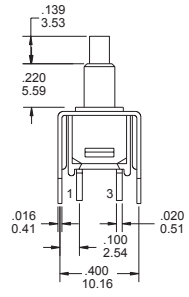

A5 (STD.)

P.C. MOUNTING

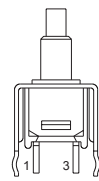
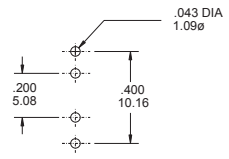

A5S (Snap-in)

A5/ A5S



SPDT

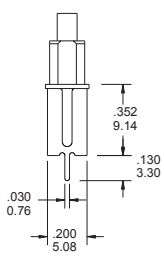

TS-22-UCQ-A5

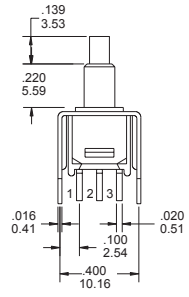

A5 (STD.)

P.C. MOUNTING

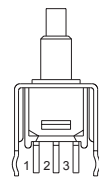
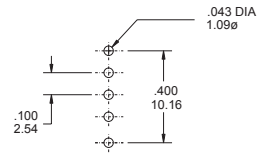

A5S (Snap-in)