

**SPECIFICATIONS**

Electrical Ratings	50mA @ 50VDC
Electrical Life	200,000 cycles typical
Contact Resistance	< 50 mΩ initial
Actuation Force	160 +/- 50gF 260 +/- 50gF
Actuator Travel	.15 +/- .05mm
Dielectric Strength	250Vrms min
Insulation Resistance	> 100MΩ min
Operating Temperature	-40°C to 85°C
Storage Temperature	-40°C to 85°C



**MATERIALS ←RoHS COMPLIANT**

Actuator	4/6 Nylon
Housing	4/6 Nylon
Cover	Stainless Steel
Contacts	Stainless Steel, Silver Plated
Terminals	Brass, Silver Plated

**ORDERING INFORMATION**

<b>1. Series:</b>	<b>CS1213</b>	<b>A</b>	<b>J</b>	<b>F160</b>
CS1213				
<b>2. Locating Boss Option:</b>				
A = Without Boss B = With Boss				
<b>3. Terminal Option:</b>				
G = Gull Wing J = J Lead L = 4 terminal Gull Wing LE = 4 terminal Gull Wing, with earth ground <b>**Not available with boss</b>				
<b>4. Actuation Force:</b>				
F160 = 160gF F260 = 260gF				

**DIMENSIONS**

**SCHEMATIC & PC LAYOUTS**

<p><b>CS1213AG</b></p>	<p><b>CS1213AJ</b></p>		
------------------------	------------------------	--	--

**DIMENSIONS**

**SCHEMATIC & PC LAYOUTS**

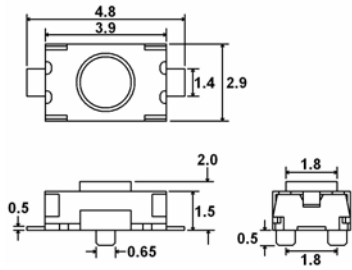

**CS1213BG**

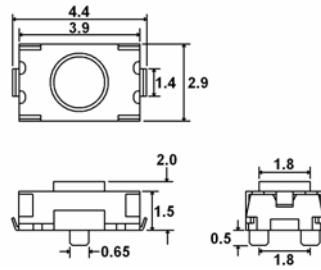

**CS1213BJ**

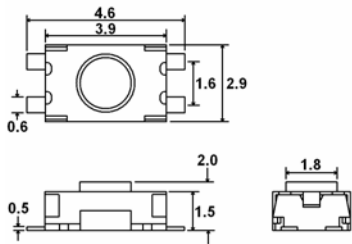
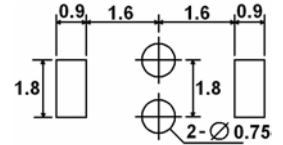
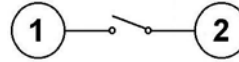

**CS1213AL**

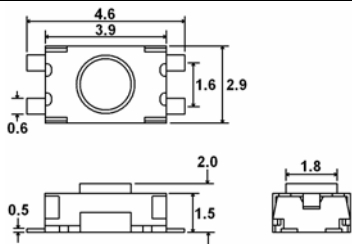
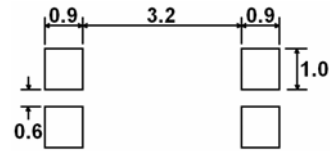
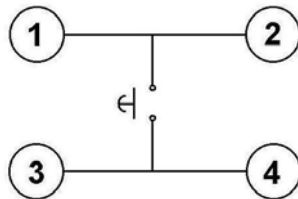

**CS1213ALE**

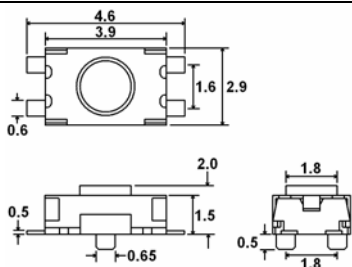
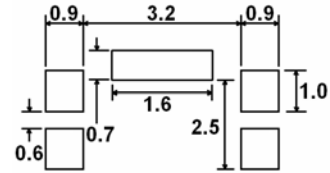
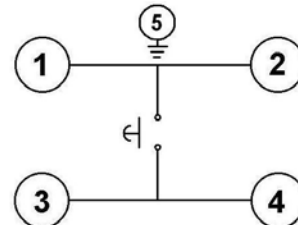

**CS1213BL**

