



Designers' Choice

# NYLON & FIBRE WASHERS

## FLAT WASHERS-NYLON & FIBRE

Quotations on other size washers furnished promptly upon receipt of sample, sketch or blue print.

**MATERIAL:**

**Fibre:** Commercial Grade per ASTM D710

**Nylon:** Grade 6/6 per ASTM D4066

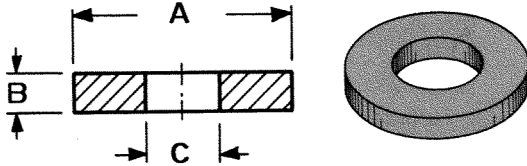

MATERIAL	SCREW SIZE	C I/D	A O/D	B THICKNESS		
				.032 Cat. No.	.047 Cat. No.	.062 Cat. No.
FIBRE	#2	.098	.187	3111	3148	3366
			.250	3112	3149	3367
			.312	3113	3150	3194
NYLON	#2	.098	.187	3114	3151	3356
			.250	3347*	3152	3357*
			.312	3115	3153	3195
FIBRE	#4	.120	.250	3116	3154	3368
			.312	348	3155	3196
			.375	3117	3156	3197
NYLON	#4	.120	.250	3348	345	3358
			.312	3359	3157	3198
			.375	3118	3158	3200
FIBRE	#6	.140	.250	3119	3159	3369
			.312	3120	3160	3370
			.375	3121	3161	3201
NYLON	#6	.140	.250	3122	3162	3360
			.312	3349	346	3361
			.375	3123	3163	3202
FIBRE	#8	.171	.312	3124	3164	3203
			.375	3125	3165	3372
			.437	3126	3166	3204
NYLON	#8	.171	.312	3127	3167	3205
			.375	3350	3168	3363
			.437	3128	3169	3206
FIBRE	#10	.196	.312	349	3170	3207
			.375	3129	3171	3208
			.437	3130	3172	3209
NYLON	#10	.196	.500	3131	3173	3210
			.312	3364	3174	3211
			.375	3352	3175	3212
FIBRE	1/4	.260	.437	3134	3178	3215
			.500	3135	3179	3373
			.625	3136	3180	3216
NYLON	1/4	.260	.750	3137	3181	3217
			.437	3138	3182	3218
			.500	3353	3183	3365
FIBRE	3/8	.385	.625	3139	3184	3219
			.750	3140	3185	3220
			1.000	3141	3186	3221
NYLON	3/8	.385	.500	3142	3187	3222
			.625	3143	3188	3223
			.750	3144	3189	3224
FIBRE	#10	.196	.312	3145	3190	3225
			.375	3354	3191	3226
			.437	3146	3192	3227
NYLON	#10	.196	.500	3147	3193	3228
			.312	3148	3194	3229
			.375	3149	3195	3230

\* .090 I.D.

## FIBRE SHOULDER WASHERS

**MATERIAL:** Fibre, Commercial Grade per ASTM D710

CAT. NO.	SCREW SIZE	L	A	B	C	D
3229	#2	.025	.250	.047	.093	.123
3061	#2	.025	.250	.047	.093	.123
344	#4	.015	.312	.062	.125	.203
343	#4	.025	.312	.062	.125	.203
3062	#4	.031	.250	.031	.115	.187
3230	#4	.031	.281	.062	.115	.175
3231	#4	.031	.312	.062	.120	.180
4698	#6	.031	.250	.062	.140	.187
3064	#6	.031	.312	.062	.140	.187
3232	#6	.031	.375	.062	.140	.210
3233	#6	.031	.375	.062	.140	.240
3234	#6	.031	.500	.062	.140	.240
3065	#8	.031	.375	.062	.170	.246
3066	#8	.031	.417	.062	.170	.210
3235	#8	.031	.312	.062	.170	.218
3236	#8	.031	.375	.062	.170	.215
3237	#8	.031	.500	.062	.170	.240
4702	#10	.031	.375	.062	.170	.308
3238	#10	.031	.375	.062	.194	.240
3239	#10	.031	.500	.062	.196	.240
4711	1/4	.031	.500	.062	.253	.308
3240	1/4	.031	.625	.062	.265	.359
3069	3/8	.031	.625	.062	.385	.498
3241	3/8	.031	.750	.062	.385	.498

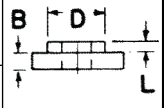
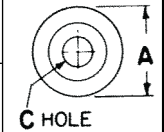
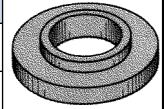

## NYLON SHOULDER WASHERS/BUSHINGS

**MATERIAL:** Nylon 6/6 per ASTM D4066

CAT. NO.	SCREW SIZE	L	A	B	C	D
7680	#2	.025	.260	.030	.095	.154
3051	#2	.125	.181	.047	.090	.120
3101	#2	.187	.181	.047	.090	.120
3052	#2	.250	.181	.047	.090	.120
3049	#4	.031	.218	.040	.115	.135
7681	#4	.047	.250	.032	.115	.185
3053	#4	.093	.235	.047	.115	.145
3102	#4	.125	.235	.047	.115	.145
3103	#4	.187	.235	.047	.115	.145
340	#4	.250	.235	.047	.115	.145
7682	#6	.032	.385	.062	.145	.240
7683	#6	.032	.250	.062	.140	.187
7684	#6	.032	.312	.062	.140	.187
3054	#6	.125	.290	.047	.140	.170
3104	#6	.187	.290	.047	.140	.170
341	#6	.250	.290	.047	.140	.170
3055	#6	.500	.290	.047	.140	.170
7685	#8	.032	.375	.032	.171	.250
3056	#8	.140	.344	.062	.171	.205
3105	#8	.250	.344	.062	.171	.205
342	#8	.375	.344	.062	.171	.205
3106	#8	.500	.344	.062	.171	.205
7686	#10	.032	.375	.032	.200	.308
3107	#10	.093	.438	.062	.200	.260
3108	#10	.250	.399	.062	.200	.260
3057	#10	.500	.399	.062	.200	.260
3058	#10	.750	.399	.062	.200	.260
7687	1/4	.032	.437	.032	.253	.310
7688	1/4	.078	.492	.032	.260	.312
3059	1/4	.187	.513	.062	.260	.312
3109	1/4	.250	.513	.062	.260	.312
3110	1/4	.375	.513	.062	.260	.312
3060	1/4	.500	.513	.062	.260	.312

