

PART NO.	"B"	THREAD	"C"	HEAD STYLE
NSS-4-#-01	.07 (1.8)	#4-40	.21 (5.3)	SLOTTED PAN
NSS-6-#-01	.08 (2.0)	#6-32	.27 (6.9)	
NSS-8-#-01	.08 (2.0)	#8-32	.32 (8.1)	
NSP-4-#-01	.08 (2.0)	#4-40	.21 (5.3)	PHILLIPS PAN
NSP-6-#-01	.09 (2.3)	#6-32	.26 (6.6)	
NSP-8-#-01	.11 (2.8)	#8-32	.32 (8.1)	

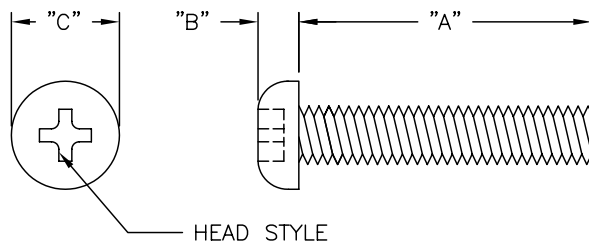

-#-	"A" ⁺ +0.000 -0.030 (+0.00 -0.76)
-2-	1/8 (3.2)
-3-	3/16 (4.8)
-4-	1/4 (6.4)
-5-	5/16 (7.9)
-6-	3/8 (9.5)
-7-	7/16 (11.1)
-8-	1/2 (12.7)
-10-	5/8 (15.9)
-12-	3/4 (19.1)
-14-	7/8 (22.2)
-16-	1.00 (25.4)

NOTES:

1. MATERIAL: NYLON 6/6 (RMS-01).
2. COLOR: NATURAL.

TOLERANCES UNLESS NOTED XX=±.010 .XXX=±.005 FRAC=±1/64 ANG=±1°		FILE # NSS-NSP MAT'L: SEE NOTES RE: RICHCO, INC.	DWN: J.B. DT: 01-16-97	APP: DT:	 FINAL	
SEE ECN #1025 FOR CHANGES		RICHCO INC. PO BOX 804238, CHICAGO, 60680 (773) 539-4060		PART # SEE TABLE		PRINT TYPE CA
B	SK 07.15.05					
A	SM 08.16.02					
REV	DESCRIPTION	ENGR	DATE			