

PART NUMBER	"A" (HOLE DIAMETER)	"B" (PANEL THICKNESS)	"C"	"D" REF.	"E"	FIGURE
USR-1131	.197 (5.0)	.059-.236 (1.5-6.0)	.472 (12.0)	.433 (11.0)	.153 (3.9)	1.
USR-1132	.236 (6.0)		.630 (16.0)			2.
USR-1133	.315 (8.0)	.118-.394 (3.0-10.0)	.787 (20.0)	.551 (14.0)	.157 (4.0)	3.

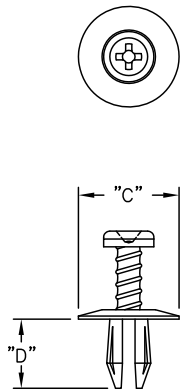

FIG. 1.

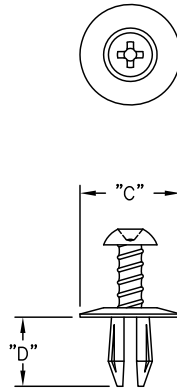

FIG. 2.

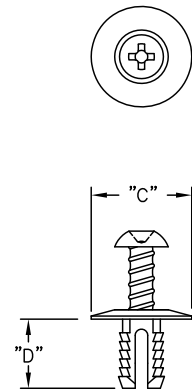
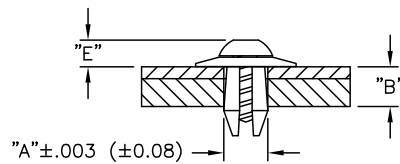

FIG. 3.



TYPICAL ASSEMBLY

NOTES:

1. MATERIAL: NYLON 6/6 (RMS-115).
2. COLOR: BLACK.

TITLE: UNSCREWING SNAP RIVETS				DWG IN IN.(MM)		FINAL		PRINT TYPE	
E	USR-1131	PANEL THCK CHANGED,CO 200648	SK 04.01.11	FILE #	USR	DWN:	S.M.	APP:	
D	USR-1132	PANEL THCK CHANGED,CO 200530	SK 05.10.10	MAT'L:	SEE NOTES	DT:	10/30/00	DT:	
C		TABLE CORRECTED	SM 01.18.02	RE:	RICHCO INC.	RICHCO INC.		PART #	USR-SERIES
B		ADDED RMS-115 AND CHANGED FILE NO.	S.M 03.29.01	RICHCO INC.		PO BOX 804238,CHICAGO,60680		PRINT TYPE	CA
A		COMPLETELY RE-DRAWN	SM 11.01.00	FRAC=1/32		(773) 539-4060			
REV		DESCRIPTION	ENGR DATE	ANG=±1°					