

PART NO.	DIM. "A" ±.015(0.4)	BOARD HOLE DIA.
KSLSP1-3-01	3/16 (4.8)	TO SNAP-LOCK IN A .156±.003 (4.00±0.08) DIA. HOLE IN A .062 (1.57) THICK BOARD
KSLSP1-4-01	1/4 (6.4)	
KSLSP1-6-01	3/8 (9.5)	
KSLSP1-8-01	1/2 (12.7)	
KSLSP1-10-01	5/8 (15.9)	
*KSLSP1-12-01	3/4 (19.1)	
*KSLSP1-14-01	7/8 (22.2)	TO SNAP-LOCK IN A .187±.003 (4.75±0.08) DIA. HOLE IN A .062 (1.57) THICK BOARD
*KSLSP1-16-01	1 (25.4)	
KSLSP2-3-01	3/16 (4.8)	
KSLSP2-4-01	1/4 (6.4)	
KSLSP2-6-01	3/8 (9.5)	
KSLSP2-8-01	1/2 (12.7)	
KSLSP2-10-01	5/8 (15.9)	*PARTS AVAILABLE BY SPECIAL ORDER ONLY
*KSLSP2-12-01	3/4 (19.1)	
*KSLSP2-14-01	7/8 (22.2)	
*KSLSP2-16-01	1 (25.4)	

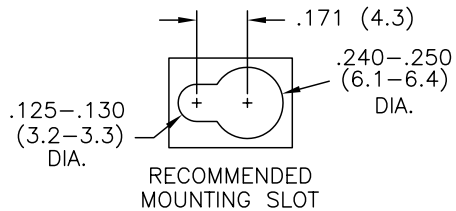

NOTES:

- MATERIAL: NYLON 6/6 (RMS-01).
FLAME RETARDANT, NYLON (RMS-19),
AVAILABLE BY SPECIAL ORDER ONLY.
- COLOR: NATURAL

TITLE: KEY SLOT LOCKING SUPPORT POST				DWG IN IN (MM)	FINAL	PR
TOLERANCES UNLESS NOTED .XX=±.010 .XXX=±.005 FRAC=±1/64 ANG=±1°	FILE # KSLSP	DWN: P.B.	APP:	PART #		
MAT'L: SEE NOTES	RE: RICHCO, INC.	DT: 05-02-94	DT:	SEE TABLE		
RICHCO INC. PO BOX 804238, CHICAGO, 60680 (773) 539-4060				PRINT TYPE CA		

REV	DESCRIPTION	ENGR	DATE
C	SEE ECN #914 FOR CHANGES	SK	01.14.05
B	SEE ECN #818 FOR CHANGES	SM	10.01.04
A	CHANGED FILE NO. AND TITLE BLOCK	SM	05.04.01