



# SAW filters for mobile communications

## Series/Type: B7845

The following products presented in this data sheet are being withdrawn.

Ordering Code	Substitute Product	Date of Withdrawal	Deadline Last Orders	Last Shipments
B39881B7845K410	B39881B9400K610	2009-04-30	2009-10-31	2010-01-31

For further information please contact your nearest EPCOS sales office, which will also support you in selecting a suitable substitute. The addresses of our worldwide sales network are presented at [www.epcos.com/sales](http://www.epcos.com/sales).



**SAW Components**

**B7845**

**Low-Loss Filter for Mobile Communication**

**881,5 MHz**

**Data Sheet**



**Features**

- Low-loss RF filter for mobile telephone GSM850 systems, receive path
- Very low insertion attenuation
- Low amplitude ripple
- Usable passband 25 MHz
- Unbalanced to balanced operation
- Impedance transformation from 50 Ω to 150 Ω
- Suitable for GPRS Class 1 to 12
- Ceramic Package for Surface Mounted Technology (SMT)

**Chip sized SAW package QCS5E**

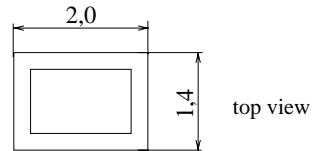
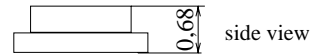
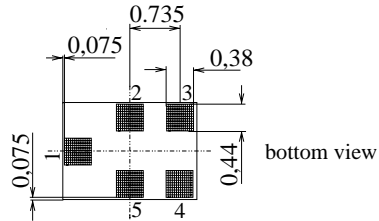

Dimensions in mm, approx. weight 0,007 g

**Terminals**

- Ni, gold-plated

**Pin configuration**

- 1 Input, unbalanced
- 3, 4 Output, balanced
- 2, 5 Case ground

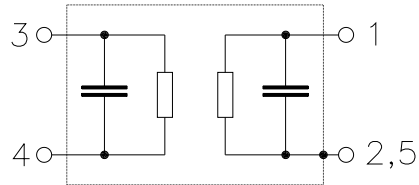

Type	Ordering code	Marking and Package according to	Packing according to
B7845	B39881-B7845-K410	C61157-A7-A131	F61074-V8151-Z000

**Electrostatic Sensitive Device (ESD)**

**Maximum ratings**

Operable temperature range	$T$	- 40 / + 85	°C	machine model, 10 pulses peak power of GSM signal, duty cycle 4:8
Storage temperature range	$T_{stg}$	- 40 / + 85	°C	
DC voltage	$V_{DC}$	5	V	
ESD voltage	$V_{ESD}^*$	100*	V	
Input power at GSM850, GSM900 GSM1800 and GSM1900 Tx bands	$P_{IN}$	15	dBm	

\* acc. to JESD22-A115A (Machine Model), 10 negative & 10 positive pulses

**SAW Components**
**B7845**
**Low-Loss Filter for Mobile Communication**
**881,5 MHz**
**Data Sheet**

**Characteristics**

Operating temperature range:  $T = 25\text{ °C}$   
 Terminating source impedance:  $Z_S = 50\ \Omega$   
 Terminating load impedance:  $Z_L = 150\ \Omega \parallel 82\text{ nH (balanced)}$

			min.	typ.	max.	
<b>Center frequency</b>	$f_C$		—	881,5	—	MHz
<b>Maximum insertion attenuation</b>	$\alpha_{max}$	869,0 ... 894,0 MHz	—	1,2	1,5	dB
<b>Amplitude ripple (p-p)</b>	$\Delta\alpha$	869,0 ... 894,0 MHz	—	0,4	0,6	dB
<b>Input VSWR</b>		869,0 ... 894,0 MHz	—	1,5	1,8	
<b>Output VSWR</b>		869,0 ... 894,0 MHz	—	1,5	1,8	
<b>Attenuation</b>		0,0 ... 434,0 MHz	45	54	—	dB
		434,0 ... 447,0 MHz	45	52	—	dB
		447,0 ... 849,0 MHz	30	35	—	dB
		914,0 ... 1000,0 MHz	26	29	—	dB
		1000,0 ... 1738,0 MHz	28	38	—	dB
		1738,0 ... 6000,0 MHz	40	46	—	dB
<b>Amplitude balance (<math> S_{31}/S_{21} </math>)</b>		869,0 ... 894,0 MHz	-1,0	-0,5 ... 0,0	1,0	dB
<b>Phase balance (<math>\phi(S_{31}) - \phi(S_{21}) + 180^\circ</math>)</b>		869,0 ... 894,0 MHz	-5	-3,0 ... 1,5	5	degree
<b>Common mode suppression</b>	$S_{sc12}$	869,0 ... 894,0 MHz	20	26	—	dB
		824,0 ... 995,0 MHz	20	26	—	dB
		1648,0 ... 1990,0 MHz	22	40	—	dB
		3296,0 ... 3980,0 MHz	20	35	—	dB

**SAW Components**
**B7845**
**Low-Loss Filter for Mobile Communication**
**881,5 MHz**
**Data Sheet**

**Characteristics**

Operating temperature range:  $T = -20$  to  $+75$  °C  
 Terminating source impedance:  $Z_S = 50$  Ω  
 Terminating load impedance:  $Z_L = 150$  Ω || 82 nH (balanced)

			min.	typ.	max.	
<b>Center frequency</b>	$f_C$		—	881,5	—	MHz
<b>Maximum insertion attenuation</b>	$\alpha_{max}$	869,0 ... 894,0 MHz	—	1,3	1,6	dB
<b>Amplitude ripple (p-p)</b>	$\Delta\alpha$	869,0 ... 894,0 MHz	—	0,6	0,8	dB
<b>Input VSWR</b>		869,0 ... 894,0 MHz	—	1,6	1,8	
<b>Output VSWR</b>		869,0 ... 894,0 MHz	—	1,6	1,8	
<b>Attenuation</b>		0,0 ... 434,0 MHz	45	54	—	dB
		434,0 ... 447,0 MHz	45	52	—	dB
		447,0 ... 849,0 MHz	30	35	—	dB
		914,0 ... 1000,0 MHz	26	29	—	dB
		1000,0 ... 1738,0 MHz	28	38	—	dB
		1738,0 ... 6000,0 MHz	40	46	—	dB
<b>Amplitude balance</b> ( $ S_{31}/S_{21} $ )		869,0 ... 894,0 MHz	-1,0	-0,6 ... 0,0	1,0	dB
<b>Phase balance</b> ( $\phi(S_{31}) - \phi(S_{21}) + 180^\circ$ )		869,0 ... 894,0 MHz	-5	-3,0 ... 1,5	5	degree
<b>Common mode suppression</b>	$S_{sc12}$	869,0 ... 894,0 MHz	20	26	—	dB
		824,0 ... 995,0 MHz	20	26	—	dB
		1648,0 ... 1990,0 MHz	22	40	—	dB
		3296,0 ... 3980,0 MHz	20	35	—	dB



Transfer function (narrow band)

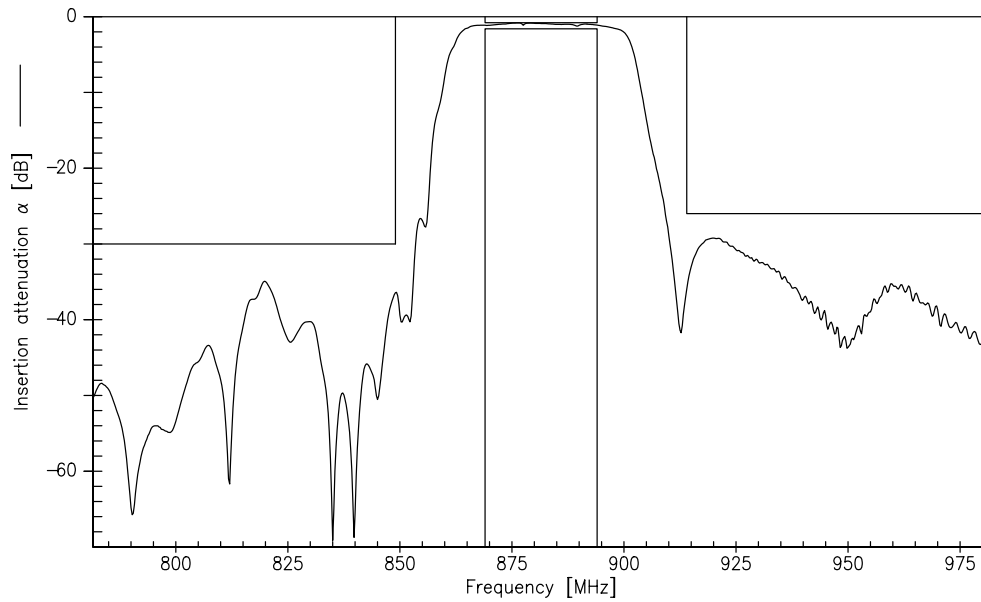

Transfer function (wideband)

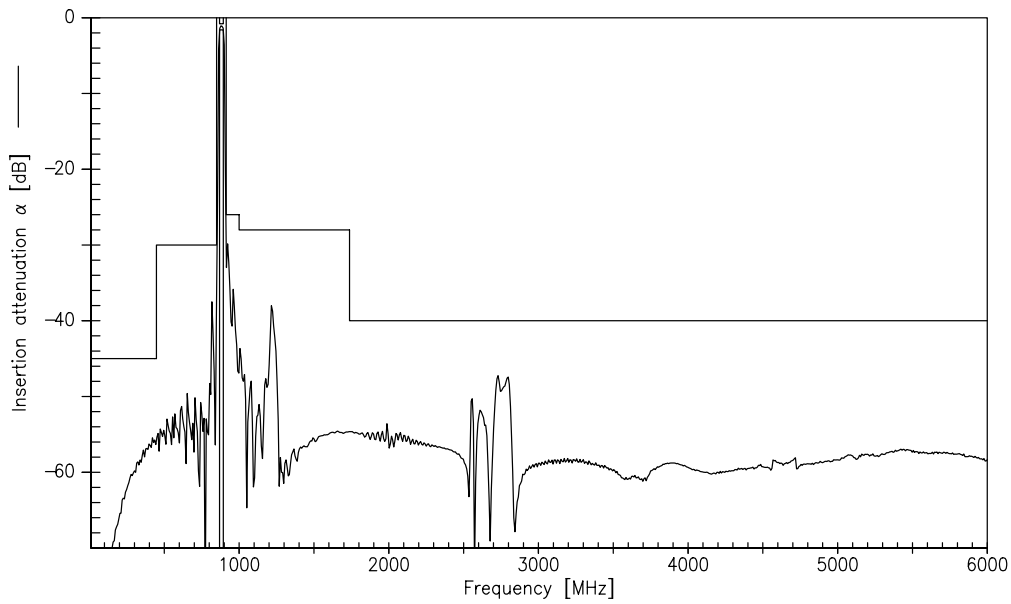



**SAW Components**

**B7845**

**Low-Loss Filter for Mobile Communication**

**881,5 MHz**

Data Sheet



**Published by EPCOS AG**

**Surface Acoustic Wave Components Division, SAW MC WT**

**P.O. Box 80 17 09, D-81617 München**

© EPCOS AG 2005. Reproduction, publication and dissemination of this brochure and the information contained therein without EPCOS' prior express consent is prohibited.

Purchase orders are subject to the General Conditions for the Supply of Products and Services of the Electrical and Electronics Industry recommended by the ZVEI (German Electrical and Electronic Manufacturers' Association), unless otherwise agreed.

This brochure replaces the previous edition.

For questions on technology, prices and delivery please contact the Sales Offices of EPCOS AG or the international Representatives.

Due to technical requirements components may contain dangerous substances. For information on the type in question please also contact one of our Sales Offices.