

**MARKETING SALES DRAWING**  
**DIMENSIONS IN INCHES - DO NOT SCALE THIS DRAWING**  
**DIMENSIONS IN METRIC - [ ]**

Electrical Testing  
per Tusonix standard  
test plans and Mil-Std-202  
Test Methods.

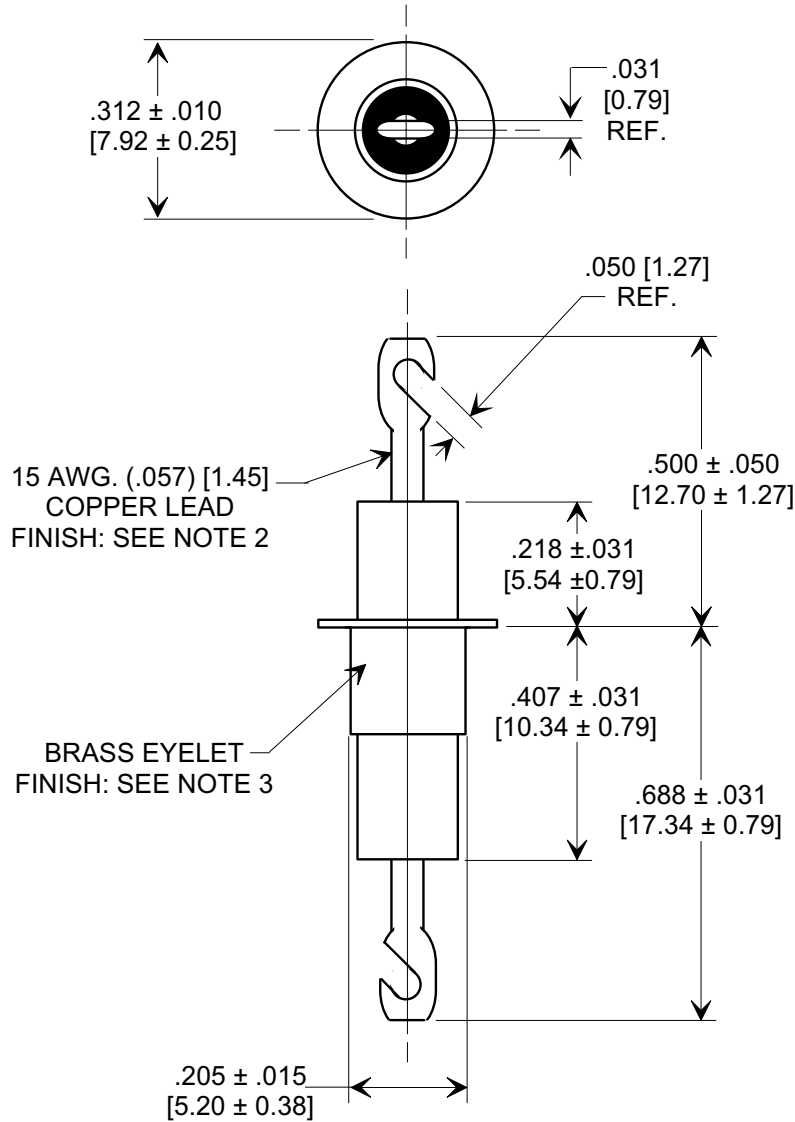
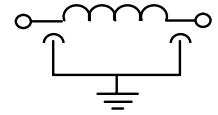
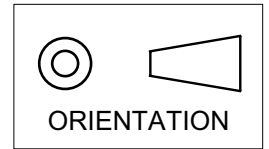

**NOTES:**

- TUSONIX STANDARD PART NUMBER: 4106-000.  
TUSONIX RoHS COMPLIANT PART NUMBER: 4106-000 LF.  
CUSTOMER MUST SPECIFY STANDARD OR RoHS PART NUMBER WHEN ORDERING.
- LEAD FINISH: STANDARD PART #: 60/40 SOLDER PLATED. RoHS PART #: SILVER PLATED.
- EYELET FINISH: STANDARD PART #: 60/40 SOLDER PLATED. RoHS PART #: SILVER PLATED.
- PART MARKING: STANDARD PART: NO MARKING. RoHS PART: GREEN DOT IDENTIFIER.

MIN. CAP (pF)	WORKING VOLTAGE (WVDC)		CURRENT Idc	I.R. MIN. @ 100 (VDC)	DWV	MINIMUM NO-LOAD INSERTION LOSS			
	85°C	125°C				10 MHz	100 MHz	1 GHz	10 GHz
3000	500 DC 350 AC	500 DC 350 AC	25A	10 G	1250 VDC	----	50	50	50

<b>X-2015 Rev-0</b> <b>REVISION RECORD</b> Original Release C.O. <b>20040219-2-01</b> ADDED NOTES 1-4. S.M. 07-26-05 <b>20050718-3-02</b>	0	<b>REVISION RECORD</b> Original Release C.O. <b>20040219-2-01</b> ADDED NOTES 1-4. S.M. 07-26-05 <b>20050718-3-02</b>	1	<b>TUSONIX</b> TUCSON, ARIZONA	<b>--TOLERANCES--</b> Unless Otherwise Specified DECIMAL ± // // // ANGLES ± // // //	Title <b>EYELET STYLE EMI FILTER</b>			
	Drawn L.E. 02-19-04		Scale 3 X						
	Approved T.C. 02-19-04								
	<b>A</b>		<b>4106-000</b>						