

UNCONTROLLED DOCUMENT

IMPEDANCE (Z) NET ^{SEE NOTE 1}

FREQUENCY	500 KHz	1 MHz	5 MHz
NOMINAL (REF.) 1 TURN	16 Ω	34 Ω	26 Ω
MINIMUM (SPEC.) 1 TURN	- Ω	25 Ω	- Ω
NOMINAL (REF.) 2 TURNS	70 Ω	105 Ω	80 Ω
NOMINAL (REF.) 3 TURNS	155 Ω	240 Ω	180 Ω

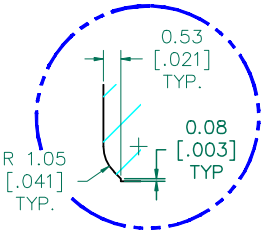

DETAIL "A"
CHAMFER
SCALE=6:1

SEE DETAIL "A"

SECTION A--A
Z vs. FREQUENCY
1 TURN, 2, AND 3 TURNS
(REF. ONLY)

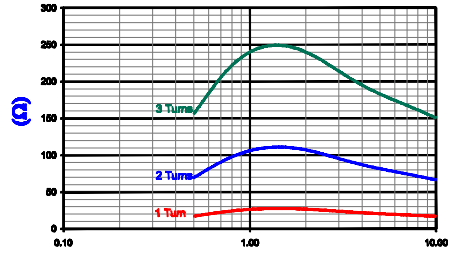

HP 4396A Impedance Analyzer
HP 16092A Test Fixture REF 2497

TEST CRITERIA

METER HP4396A OR EQUIVALENT
FIXTURE HP16092A OR EQUIVALENT

NOTES:

- NET IMPEDANCE IS IMPEDANCE OF THE FERRITE CORE ONLY. ALL IMPEDANCE CONTRIBUTION FROM TEST WIRE AND FIXTURES HAS BEEN REMOVED.

FERRITE CORE DIMENSIONS (SPEC):

A	25.00 [.984]	±	0.38 [.015]
B	15.00 [.591]	±	0.38 [.015]
C	13.00 [.512]	±	0.25 [.010]

WEIGHT/1000 19.11 kgs [42.13 Lbs]

DIMENSIONS ARE IN mm [INCHES].				This print is the property of Laird Tech. and is loaned in confidence subject to return upon request and with the understanding that no copies shall be made without the written consent of Laird Tech. All rights to design or invention are reserved.	
D	UPDATE COMPANY LOGO	07/13/08	TMB	PROJECT/PART NUMBER:	LFB250150-000
C	REMOVE MIN SPEC @ 500 KHz	02/10/06	JRK	REV	D
B	ADJUST TOLERANCES ADD TEST REF #	12/28/04	JRK	PART TYPE:	FERRITE CORE
A	ORIGINAL DRAFT	09/30/02	TMB	DATE:	09/30/02
REV	DESCRIPTION	DATE	INT	CAD #	LF
				SCALE:	2:1
				TOOL #	B0984
				MATERIAL:	LF
				DRAWN BY:	TMB

