



HI1206T161R-10

UNCONTROLLED DOCUMENT

PHYSICAL DIMENSIONS:

A	3.20 [.126]	+ 0.20 [.008]
B	1.60 [.063]	+ 0.20 [.008]
C	1.60 [.063]	+ 0.20 [.008]
D	0.51 [.020]	+ 0.25 [.010]

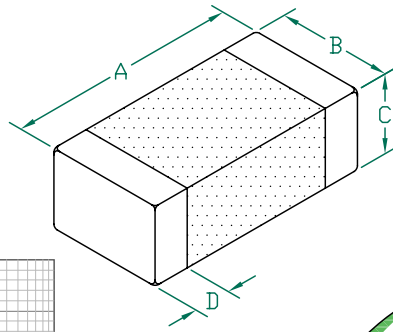

ELECTRICAL CHARACTERISTICS:

	Z @ 100MHz (Ω)	DCR (Ω)	Rated Current
Nominal	160		
Minimum	120		
Maximum	208	0.018	6000 mA

- NOTES: UNLESS OTHERWISE SPECIFIED
1. TAPED AND REELED per CURRENT EIA SPECIFICATIONS 7" REELS, 2000 PCS/REEL, EMBOSSED PLASTIC TAPE.
 2. COMPONENTS SHOULD BE ADEQUATELY PREHEATED BEFORE SOLDERING.
 3. TERMINATION FINISH IS 100% TIN.

Z vs FREQUENCY
IMPEDANCE UNDER DC BIAS

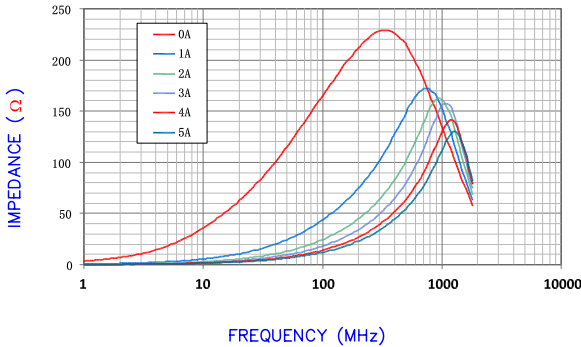

LAND PATTERNS FOR REFLOW SOLDERING

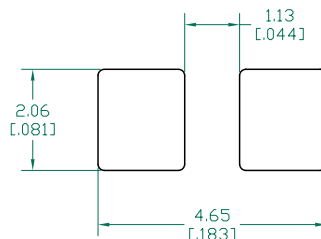

(For wave soldering, add 0.762 [0.030] to this dimension)

RECOMMENDED SOLDERING CONDITIONS

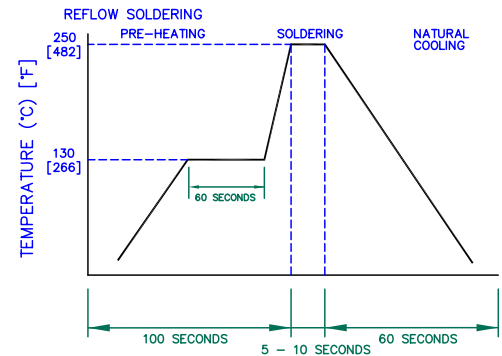

FREQUENCY (MHz)
|Z|, R, AND X vs. FREQUENCY

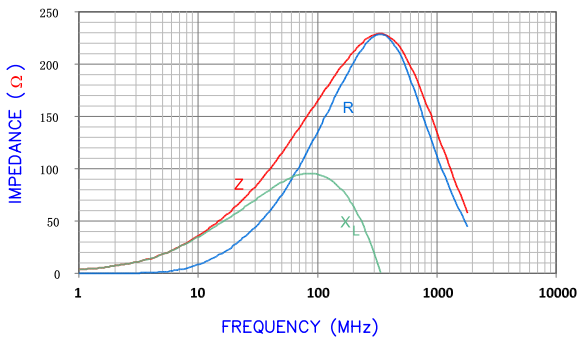

AGILENT E4991A RF Impedance/Material Analyzer
HP 16194A Test Fixture. TEST REF. 6308

DIMENSIONS ARE IN mm [INCHES].

<p>This print is the property of Laird Tech. and is loaned in confidence subject to return upon request and with the understanding that no copies shall be made without the written consent of Laird Tech. All rights to design or invention are reserved.</p>					
G	UPDATE CURVES AND REF NUMBER	07/08/10	JUN	REV	G
F	UPDATE COMPANY LOGO	10/09/08	TMB	PART TYPE:	CO-FIRE
E	ADD EMBOSSED PLASTIC TAPE TO NOTE 1	01/19/07	JRK	PROJECT/PART NUMBER:	HI1206T161R-10
D	CHANGE C DIMENSION	01/15/07	JRK	SCALE:	NTS
C	CHG REEL QTY ADD ROHS SYMBOL	08/28/06	JRK	DATE:	01/13/04
B	CHANGE MAXIMUM IMPEDANCE FROM 200	01/11/05	JRK	DATE:	01/13/04
A	ORIGINAL DRAFT	01/13/04	JRK	DATE:	01/13/04
REV	DESCRIPTION	DATE	INT	CAD #	HI1206T161R-10-G
				TOOL #	-
				SHEET:	2 of 2
				DRAWN BY:	JRK