

CM1812R600R-10

UNCONTROLLED DOCUMENT

PHYSICAL DIMENSIONS:

A	4.57 [.180]	± 0.25 [.010]
B	3.05 [.120]	± 0.25 [.010]
C	2.36 [.093]	± 0.25 [.010]
D	1.14 [.045]	± 0.13 [.005]
E	0.58 [.023]	± 0.18 [.007]

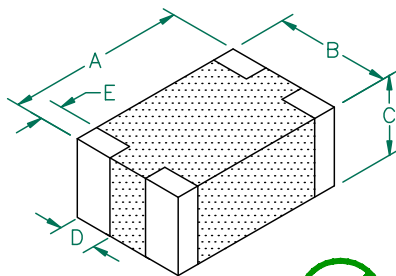

COMMON MODE ELECTRICAL CHARACTERISTICS:			
COMMON MODE Z @ 100 MHz (Ω)	COMMON MODE Z @ 500 MHz (Ω)	DCR (Ω)	CONTINUOUS Rated Current
Nominal (Ref)	60	Nominal (Ref)	85
Minimum	45	-	-
Maximum	75	-	0.005 5,000 mA

- NOTES: UNLESS OTHERWISE SPECIFIED
- TAPED AND REELED per CURRENT EIA SPECIFICATIONS 13" REELS, 2500 PCS/REEL.
 - COMPONENTS SHOULD BE ADEQUATELY PREHEATED BEFORE SOLDERING.
 - U.S. PATENT 6,288,626 SHOULD APPEAR ON THE LABEL OF EACH REEL OF PACKAGED PARTS.
 - MINIMUM LINE TO LINE RESISTANCE 1 MΩ
 - TERMINATION FINISH IS 100% TIN.



LAND PATTERNS FOR REFLOW SOLDERING

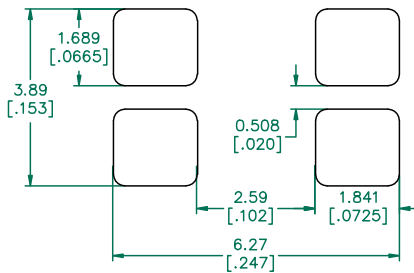

DURING AND AFTER SOLDERING OPERATION SOLDER MUST NOT BE ALLOWED TO BRIDGE CONTACTS. CONTACT SEPARATION MUST BE MAINTAINED.

RECOMMENDED SOLDERING CONDITIONS

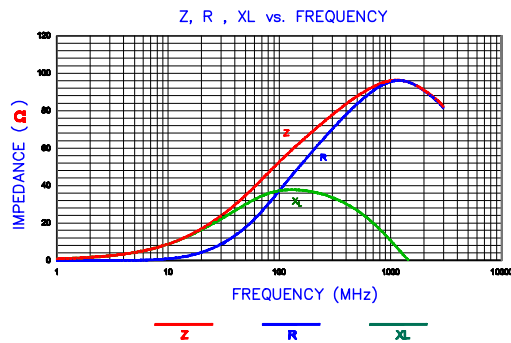
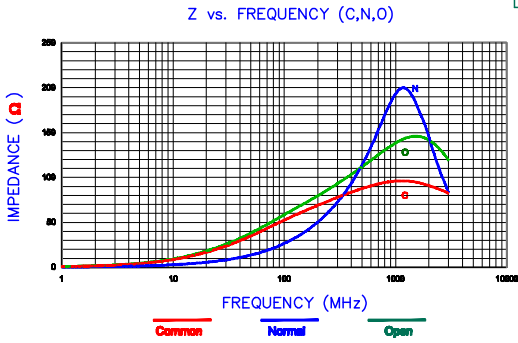
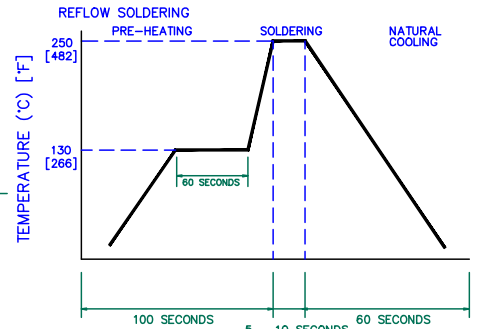

DIMENSIONS ARE IN mm [INCHES].			THIS DOCUMENT CONTAINS INFORMATION WHICH IS PROPRIETARY AND CONFIDENTIAL TO STEWARD. NO PRODUCTION OR PUBLICATION OF THIS DOCUMENT IN WHOLE OR IN PART SHALL BE MADE WITHOUT WRITTEN AUTHORIZATION FROM STEWARD.		
			Steward <small>Land</small>		
PROJECT/PART NUMBER:			REV	PART TYPE:	DRAWN BY:
CM1812R600R-10			C	CO-FIRE	JRK
C	UPDATE COMPANY LOGO	05/15/07	JRK		
B	CHANGE MIN LINE RESISTANCE	09/28/05	JRK	DATE:	03/02/05
A	ORIGINAL DRAFT	03/02/05	JRK	SCALE:	NTS
REV	DESCRIPTION	DATE	INT	DWG #	CM1812R600R-10-C
				TOOL #	CM1812
				SHEET:	2 of 2

AGILENT E4991A RF Impedance/Material Analyzer
HP 16194A Test Fixture. TEST REF. 4219