

4

3

2

1

THIS DRAWING IS UNPUBLISHED. RELEASED FOR PUBLICATION 20
 © COPYRIGHT 20 BY TYCO ELECTRONICS CORPORATION. ALL RIGHTS RESERVED.

LOC		DIST		REVISIONS				
P	LTR	DESCRIPTION		DATE	DWN	APVD		
	A	REVISED PER ECR-09-027009		12DEC09	HMR	DD		

⚠ MATERIAL: ELECTRICALLY INSULATING, THERMALLY CONDUCTIVE,
 SOFT TACK ELEASTOMER

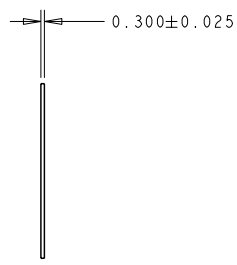
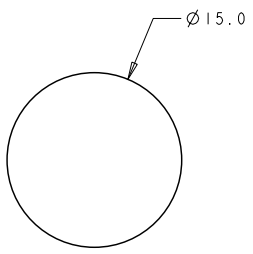

AS SHOWN	2058329-1
DESCRIPTION	PART NUMBER

<small>THIS DRAWING IS A CONTROLLED DOCUMENT FOR TYCO ELECTRONICS CORPORATION IT IS SUBJECT TO CHANGE AND THE CONTROLLING ENGINEERING ORGANIZATION SHOULD BE CONTACTED FOR THE LATEST REVISION.</small>		DWN R BROWN 12MAY2008 CHK C GINGRICH 12MAY2008 APVD C GINGRICH 12MAY2008	Tyco Electronics Harrisburg, PA 17105-3608
DIMENSIONS: mm	TOLERANCES UNLESS OTHERWISE SPECIFIED: 0 PLC ± 1 PLC ±0.5 2 PLC ±0.13 3 PLC ±0.013 4 PLC ±0.0001 ANGLES 0°	NAME C GINGRICH PRODUCT SPEC APPLICATION SPEC WEIGHT	PAD, SOFT TACK ELASTOMER, ELECTRICALLY INSULATING, THERMALLY CONDUCTIVE
MATERIAL 	FINISH	SIZE CAGE CODE DRAWING NO A3 00779 C-2058329	RESTRICTED TO CUSTOMER DRAWING
		SCALE 3:1	SHEET 1 OF 1 REV A