

# EMI Filter Shields for QLM Sleeves



**Material:** High-grade steel (spring V2a) / Material No. 1.4310

**Material Thickness:** 0.2mm to 0.3mm

The filter guard EMI-shield sheet is required to avoid intake of the filter into the fan should there be only one large air intake opening. It also protects against EMI/RFI transmissions if needed. The EMI filter shield can be mounted on the inside or the outside of the panel housing.

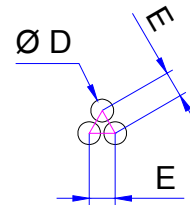
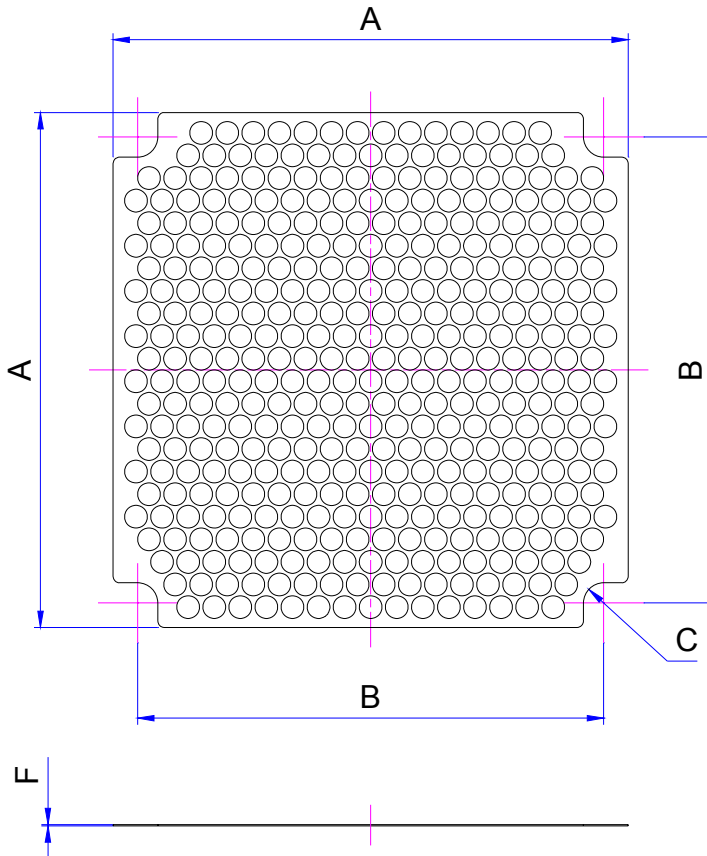

roundhole removed  
(free cross-section: ca. 75%)

Ordering Information:



Part Number	A Inch / mm	B Inch / mm	C Inch / mm	D Inch / mm	E Inch / mm	F Inch / mm
QSB-40-01	1.654 / 42.0	1.260 / 32.0	R .094 / 2.4	.098 / 2.5	.118 / 3.0	.008 / 0.2
QSB-60-01	2.441 / 62.0	1.969 / 50.0	R .106 / 2.7	.138 / 3.5	.157 / 4.0	.008 / 0.2
QSB-80-01	3.228 / 82.0	2.815 / 71.5	R .126 / 3.2	.138 / 3.5	.157 / 4.0	.008 / 0.2
QSB-92-01	3.700 / 94.0	3.248 / 82.5	R .126 / 3.2	.157 / 4.0	.177 / 4.5	.008 / 0.2
QSB-119-01	4.764 / 121.0	4.133 / 105.0	R .165 / 4.2	.157 / 4.0	.217 / 5.5	.012 / 0.3

7675 Jenther Drive,  
Mentor, OH 44060  
Phone: 1-440-951-3300,  
Fax: 1-440-951-7252

**Qualtek** Electronics Corporation

E-Mail: mailbox@qualtekusa.com  
Web: www.qualtekusa.com

REV. QSB002