

PLEASE CHECK WWW.MOLEX.COM FOR LATEST PART INFORMATION

Part Number: [0192160003](#)
Status: **Active**
Overview: [splice](#)
Description: Multi-Lock Connector for 14-16 AWG Wire

Documents:

[Drawing \(PDF\)](#) [Product Specification PS-19902-013 \(PDF\)](#)
[Product Specification PS-19902-011 \(PDF\)](#) [RoHS Certificate of Compliance \(PDF\)](#)

Agency Certification

UL E32244

General

Product Family Splices
 Series [19216](#)
 Comments .550" x .375" when closed
 Crimp Quality Equipment Yes
 Mil-Spec N/A
 MolexKits Yes
 Overview [splice](#)
 Product Name Multi-Lock

Physical

Barrel Type Closed
 Flammability 94V-0
 Insulation Polypropylene
 Packaging Type Bag
 Temperature Range - Operating 105°C
 Wire Insulation Diameter 3.3mm (.13") & 4.1mm (.17"), t
 Wire Size AWG 14, 16
 Wire Size mm² N/A

Electrical

Voltage - Maximum 600V

Material Info

Old Part Number ML-1614

Reference - Drawing Numbers

Product Specification PS-19902-011, PS-19902-013
 Sales Drawing SD-19216-003

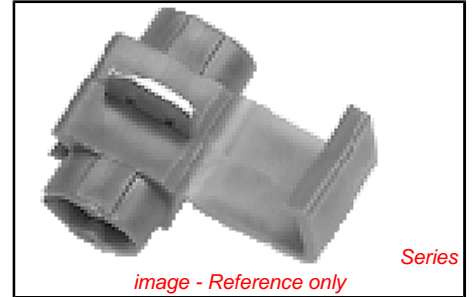

<p>EU RoHS ELV and RoHS Compliant REACH SVHC Not Reviewed Low-Halogen Status Not Reviewed</p>	<p>China RoHS</p>
--	--------------------------

Need more information on product environmental compliance?

Email productcompliance@molex.com
 For a multiple part number RoHS Certificate of Compliance, [click here](#)

Please visit the [Contact Us](#) section for any non-product compliance questions.

Search Parts in this Series
[19216Series](#)

PLEASE CHECK WWW.MOLEX.COM FOR LATEST PART INFORMATION