



THE POWER TO PRINT

Able Systems Limited

Denton Drive
Northwich
Cheshire
CW9 7TU
England

T: +44 (0) 1606 48621
F: +44 (0) 1606 44903

www.able-systems.com

PSA1310V2, Ap1200PSAV2 and Ap800PSAV2 **PSU Specification (RoHS Compliant)**

1. INPUT Specification

Rated AC input voltage: **100-240Vac**
Operating range: **90-264Vac**
Rated input frequency: **50/60Hz**
Rated input current: **0.8A max.**
Maximum input power: **38.42W**
Input current (no loading): **≤15mA**
Power consumption (no loading): **Max. 0.5W**
Primary current protection: **Internal fuse on the AC input line.**



INVESTOR IN PEOPLE

2. OUTPUT Specification

Nominal DC output voltage: **+7.5V**
Rated load current: **3.33A**
Rated output power: **25W**
Regulation type: **Voltage**

Output safety protection; over-voltage, short-circuit and over current.

3 Regulatory Standard

The power supply complies with the following international regulatory standards:

Abbreviation	Country	Standard
UL	USA	UL 60950-1
CSA	Canada	CSA C22.2 NO.950
TUV	Europe	TUV/VDE-EN60950-1
CE	Europe	Declared& CE Mark
PSE	Japan	J60950(H14)/J55001(H14)
BSMI	Taiwan	CNS13438
CCC	CHINA	GB4943-2001
UK	Britain	EN60950-1:2004

4. Environmental Requirements

Temperature

- Operating: **0 °C to +40 °C**
- Non-Operating: **-20 °C to +80 °C**

Humidity

- Operating: **10%~90%** (Non Condensing)
- Non-Operating: **10%~90%** (Non Condensing)

5. Output Connection

PSU Part Number:	PSA1310V2	Ap1200PSAV2	Ap800PSAV2	Ap800PSABLKV2
Output connector :	5.5*2.1*10mm Center“+”	Part 09-91-0300 (3 Way Molex Housing)	Ap800 Battery Pack Eliminator	

6. Enclosure And Layout

Plastic case: UL94V-1
 Weight : 181 g (Max.)
 Dimensions: 93x47x41.2 mm (allow for output cable strain relief)
 Colour : BLACK (LEAD-FREE)

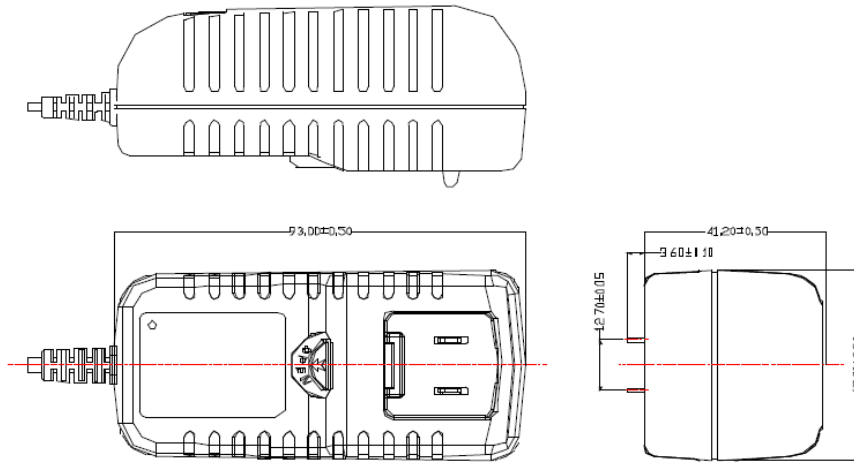

SAA PLUG

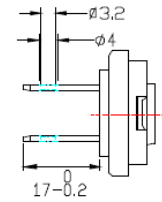
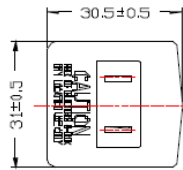
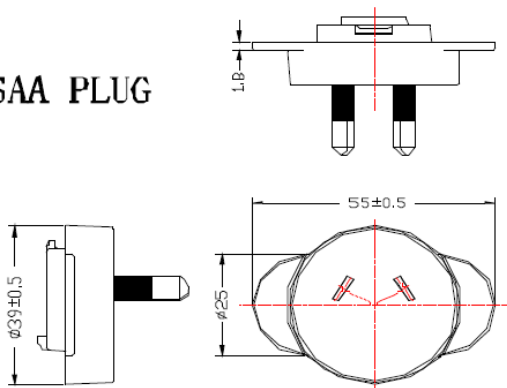

UL PLUG

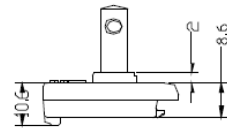

UP PLUG

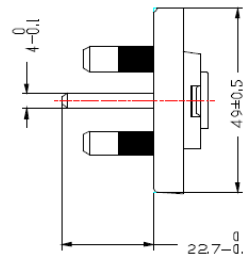
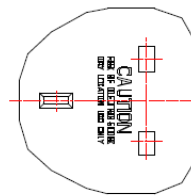
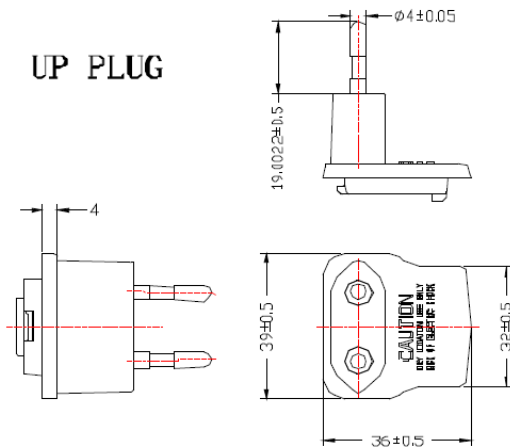

UK PLUG

