



**General data**

**LUMOTAST 25 pushbutton range**

- Illuminable pushbuttons and signal lamps. Please order lamps/LEDs separately.
- Mounting hole diameter: 16.2 mm
- 42 V/100 mA max.
- Water-jet proof IP65
- Low profile
- Lamp socket Bi-Pin T 1 for LEDs and filament lamps
- Keyed socket connector and flat ribbon cable or PCB plug-in socket
- Ring nut or click fixing method.

**Content**

<b>LUMOTAST 25 illuminated pushbutton</b>	<b>1 - 22</b>
LUMOTAST 25 illuminated pushbutton with flush lens, "Click" quick-assembly feature	1 - 24
LUMOTAST 25 illuminated pushbutton with flush lens, ring nut fixing	1 - 24
LUMOTAST 25 illuminated pushbutton with protruding lens, "Click" quick-assembly feature	1 - 25
LUMOTAST 25 illuminated pushbutton with protruding lens, ring nut fixing	1 - 25
LUMOTAST 25 illuminated pushbutton with protruding collar, "Click" quick-assembly feature	1 - 26
LUMOTAST 25 illuminated pushbutton with protruding collar, ring nut fixing	1 - 26
<b>LUMOTAST 25 selector switch</b>	<b>1 - 28</b>
LUMOTAST 25 selector switch, ring nut fixing	1 - 29
<b>LUMOTAST 25 keylock switch</b>	<b>1 - 30</b>
LUMOTAST 25 keylock switch	1 - 31
<b>LUMOTAST 25 emergency stop pushbutton</b>	<b>1 - 32</b>
LUMOTAST 25 emergency stop pushbutton, ring nut fixing	1 - 33
<b>LUMOTAST 25 signal lamp</b>	<b>1 - 34</b>
LUMOTAST 25 signal lamp, 24 V, "Click" quick-assembly feature	1 - 35
LUMOTAST 25 signal lamp, 24 V, ring nut fixing	1 - 36

# Series LUMOTAST25

16.2 mm mounting hole diameter

1

## Design Click-Version

LUMO  
25

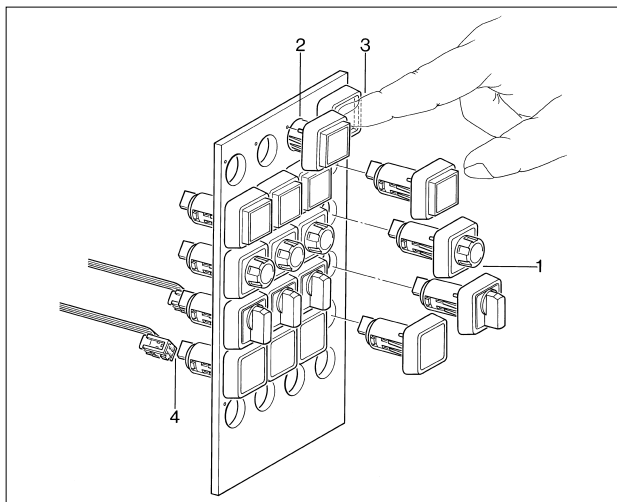

1. As delivered
2. Insert pushbutton in hole
3. Actuate once
4. Insert connector with flat-ribbon cable

## Disassembly Click-Version

Click-Version from front (only for pushbuttons and signal lamps with special tool for dismounting)

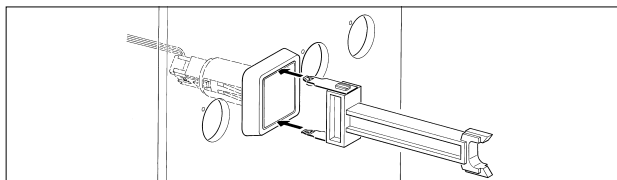

1. Grip body/lens

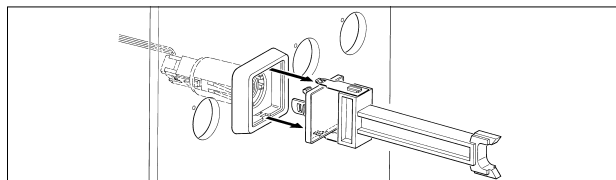

2. Pull out body/lens

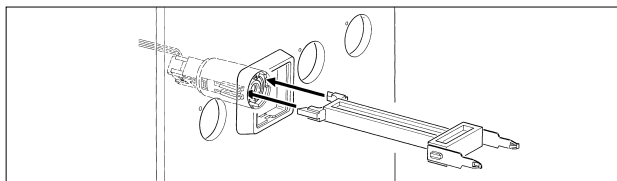

3. Release click lever

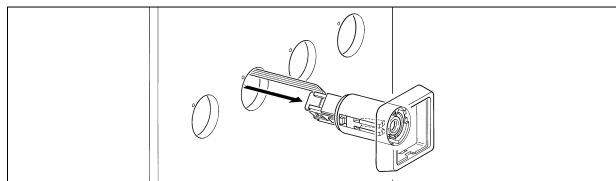

4. Pull out pushbutton/signal lamp with cable

# Series LUMOTAST25

16.2 mm mounting hole diameter

1

## Design Click-Version

LUMO  
25

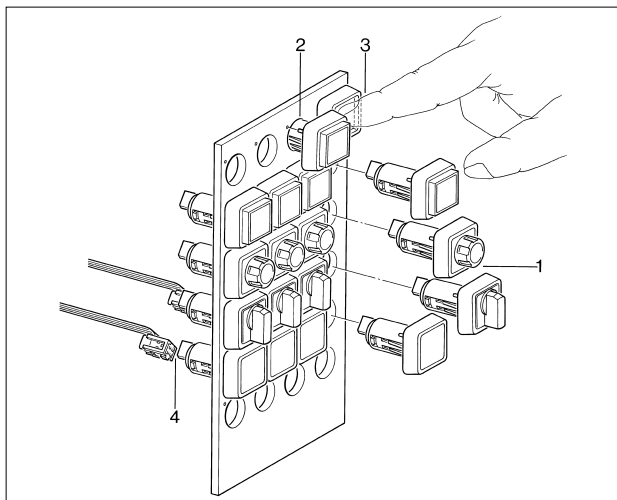

1. As delivered
2. Insert pushbutton in hole
3. Actuate once
4. Insert connector with flat-ribbon cable

## Disassembly Click-Version

Click-Version from front (only for pushbuttons and signal lamps with special tool for dismounting)

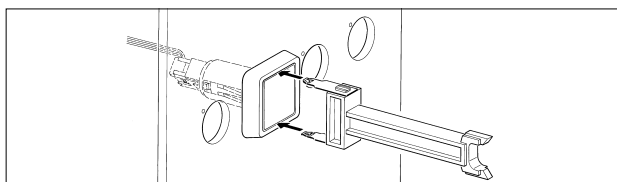

1. Grip body/lens

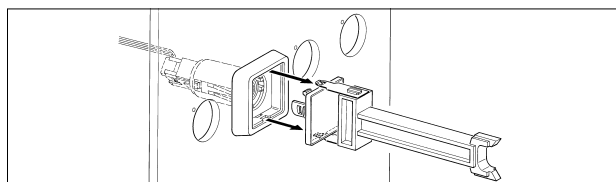

2. Pull out body/lens

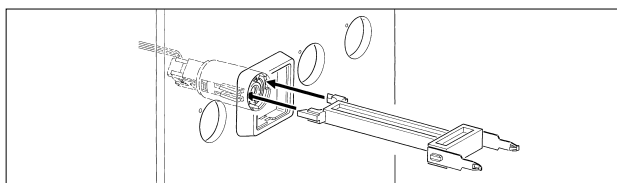

3. Release click lever

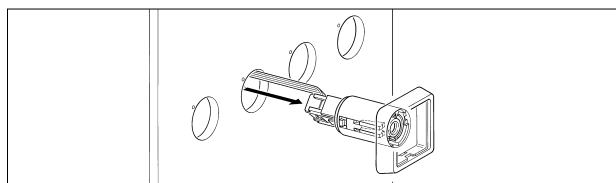

4. Pull out pushbutton/signal lamp with cable

**Dimensional drawing**

With quick connector and flat-ribbon cable

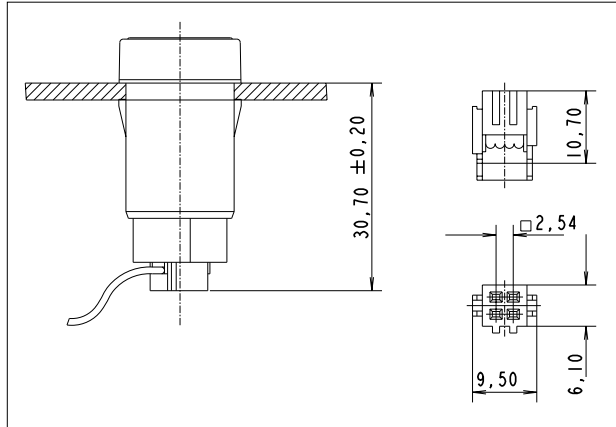

Connection diagram (PCB top view)

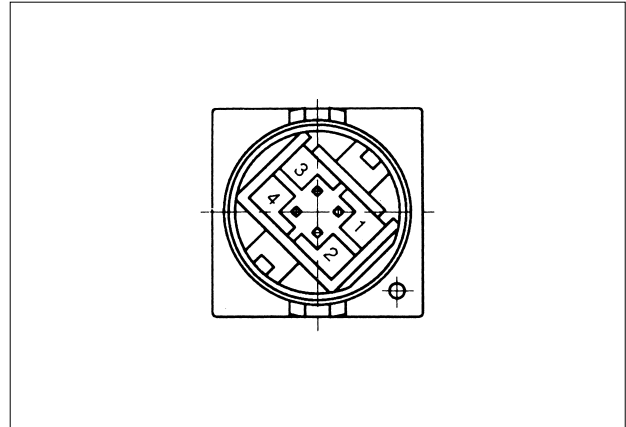

1 + 4 = pushbutton connection 2 + 3 = lamp connection

1

LUMO  
25

With plug-in socket

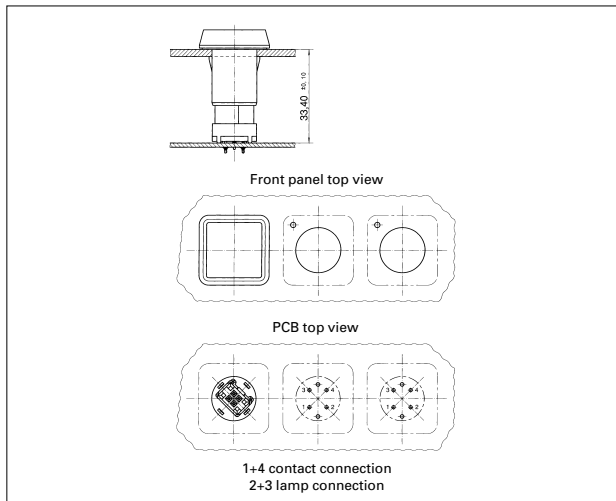

Plug-in socket for PCB

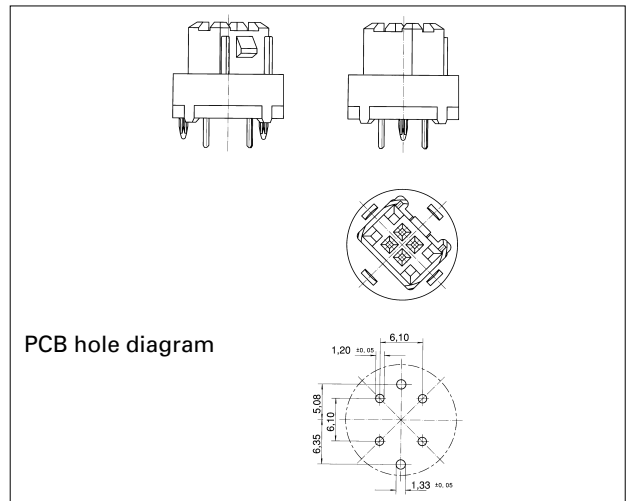

PCB hole diagram

1

**LUMOTAST 25 illuminated pushbutton**



**Technical data**

LUMO  
25

**General information**

Form of lens see order block  
 Colour of lens see order block  
 Form of collar square

**Dimensions**

Length of collar 25 mm  
 Width of collar 25 mm  
 Overall height 7.1 mm  
 Mounting depth with connector 30.7 mm  
 Mounting depth with plug-in socket 33.4 mm  
 Mounting hole 16.2 mm

**Mechanical design**

Mounting see order block  
 Terminals pin connector 4-pol./ plug-in socket  
 Contact system snap-action contact momentary  
 Contact function 1 NO  
 Contact arrangement Au  
 Contact materials yes  
 Illuminability Bi-Pin T 1/T 1¼

**Mechanical characteristics**

Operating force max. 6 N  
 Operating travel 3 mm  
 Switching travel 2 mm  
 Robustness min. 100 N

**Electrical characteristics**

Rated voltage AC/DC max. 42 V  
 Rated voltage AC/DC min. 0.02 V  
 Rated current AC/DC max. 100 mA  
 Rated current AC/DC min. 0.01 mA  
 Contact resistance max. 100 mΩ  
 Bouncing time max. 5 ms

















**Other specifications**

Operating life (operations) 1,000,000  
 Degree of protection from front side IP65  
 Ambient temp. operating without lamp min. -25 °C  
 Ambient temp. operating without lamp max. +70 °C  
 Ambient temp. operating with lamp min. -25 °C  
 Ambient temp. operating with lamp max. +55 °C  
 Storage temperature min. -40 °C  
 Storage temperature max. +80 °C  
 Resistance to climate acc. to IEC 600 68-2-3 und 2-30 according to IEC 600 68-2-3 and 2-30  
 Resistance at variable environment acc. to IEC 600 68-2-14 und 2-33 according to IEC 600 68-2-14 and 2-33  
 Weight 7 g

**Accessories LUMOTAST 25 illuminated pushbutton**

Description	Photo	Order no.	Page
Filament lamp, Bi-Pin T 1¼ base, 12 V		<b>1.90.180.474/0000</b>	5 - 5
Filament lamp, Bi-Pin T 1¼ base, 28 V		<b>1.90.180.475/0000</b>	5 - 5
LED Bi-Pin T 1 superbright, red, 24 V		<b>1.90.690.351/0000</b>	5 - 17

**Accessories LUMOTAST 25 illuminated pushbutton**

Description	Photo	Order no.	Page
LED Bi-Pin T 1 superbright, green, 24 V		<b>1.90.690.352/0000</b>	5 - 17
LED Bi-Pin T 1 superbright, yellow, 24 V		<b>1.90.690.353/0000</b>	5 - 17
LED Bi-Pin T 1 superbright, blue, 24 V		<b>1.90.690.354/0000</b>	5 - 17
LED Bi-Pin T 1 superbright, white, 24 V		<b>1.90.690.355/0000</b>	5 - 17
LED Bi-Pin T 1, red, 3 V		<b>1.90.691.026/0000</b>	5 - 17
LED Bi-Pin T 1, green, 3 V		<b>1.90.691.027/0000</b>	5 - 17
LED Bi-Pin T 1, yellow, 3 V		<b>1.90.691.028/0000</b>	5 - 17
Plug-in socket for PCB		<b>5.00.645.036/0000</b>	5 - 25
Cable (flat ribbon cable 10 cm with socket connector and male quick connector, AMP 4-pin)		<b>5.03.771.306/0000</b>	5 - 24
Disassembly tool for LUMOTAST 25, RAFIX 16		<b>5.05.800.042/0000</b>	2 - 65 5 - 24
Blanking cap complete with sealing disc and ring nut, square		<b>5.05.800.049/0100</b>	5 - 29
Label holder, flush, for square collar		<b>5.07.620.004/0000</b>	2 - 66
Flat ribbon cable, 4-wire, 1 m long		<b>5.37.700.124/0000</b>	5 - 25
Fixing spanner M 15, M 16		<b>5.58.002.019/0105</b>	5 - 23
Legend insert, blank, use only for transparent lenses		<b>5.70.635.000/2000</b>	
Legend label 23 x 16 for label holder, without legend		<b>5.73.111.000/0000</b>	2 - 66
Socket connector, 4-pin		<b>5.92.025.368/0000</b>	5 - 24

1

LUMO  
25

1

**LUMOTAST 25 illuminated pushbutton with flush lens, „Click“ quick-assembly feature**

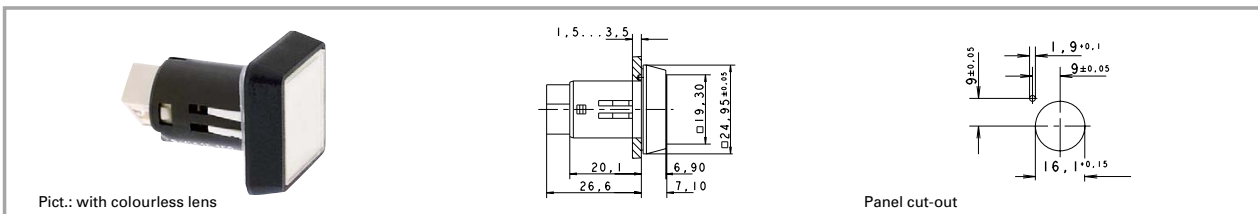

Contact function	Contact arrangement	Order no. without lens	Note
momentary	1 NO	<b>1.15.150.506/0000</b>	Please include the desired lens in your order.

LUMO  
25

Technical data see page 1 - 22

**Lenses:**

- Lens, square, transparent colourless: **5.49.077.011/1002**
- Lens, square, transparent red: **5.49.077.011/1306**
- Lens, square, transparent yellow: **5.49.077.011/1403**
- Lens, square, transparent green: **5.49.077.011/1505**
- Lens, square, transparent blue: **5.49.077.011/1607**

Note when using LEDs: A notch on the lamp socket identifies the cathode side.

**LUMOTAST 25 illuminated pushbutton with flush lens, ring nut fixing**

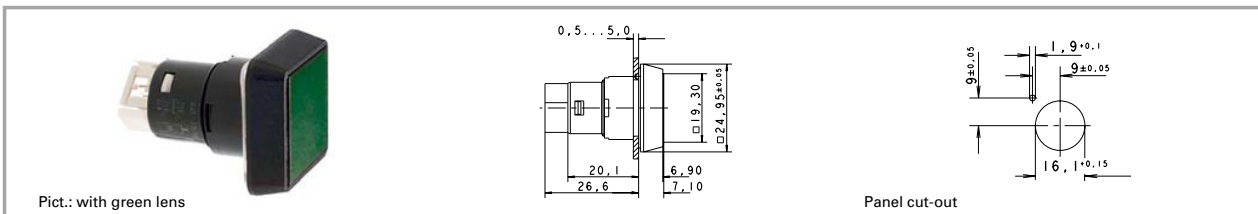

Contact function	Contact arrangement	Order no. without lens	Note
momentary	1 NO	<b>1.15.150.556/0000</b>	Please include the desired lens in your order.

Technical data see page 1 - 22

**Lenses:**

- Lens, square, transparent colourless: **5.49.077.011/1002**
- Lens, square, transparent red: **5.49.077.011/1306**
- Lens, square, transparent yellow: **5.49.077.011/1403**
- Lens, square, transparent green: **5.49.077.011/1505**
- Lens, square, transparent blue: **5.49.077.011/1607**

Note when using LEDs: A notch on the lamp socket identifies the cathode side.

**LUMOTAST 25 illuminated pushbutton with protruding lens, „Click“ quick-assembly feature**

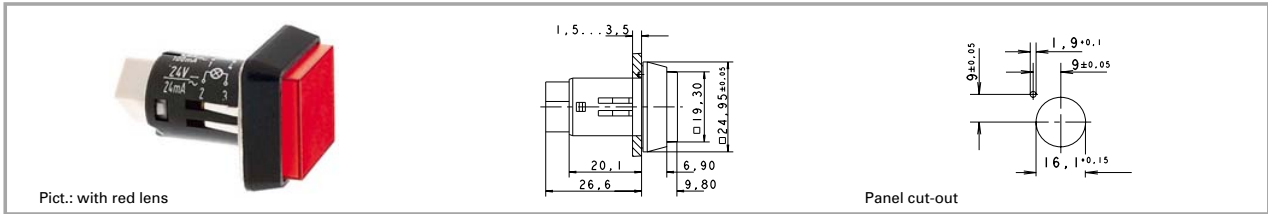

Contact function	Contact arrangement	Order no. without lens	Note
momentary	1 NO	1.15.150.606/0000	Please include the desired lens in your order.

Technical data see page 1 - 22

**Lenses:**

- Lens, square, transparent colourless: **5.49.077.012/1002**
- Lens, square, transparent red: **5.49.077.012/1306**
- Lens, square, transparent yellow: **5.49.077.012/1403**
- Lens, square, transparent green: **5.49.077.012/1505**
- Lens, square, transparent blue: **5.49.077.012/1607**

Note when using LEDs: A notch on the lamp socket identifies the cathode side.

1

LUMO  
25

**LUMOTAST 25 illuminated pushbutton with protruding lens, ring nut fixing**

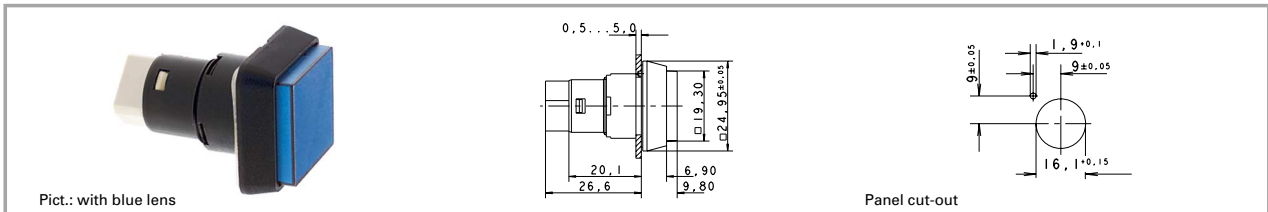

Contact function	Contact arrangement	Order no. without lens	Note
momentary	1 NO	1.15.150.656/0000	Please include the desired lens in your order.

Technical data see page 1 - 22

**Lenses:**

- Lens, square, transparent colourless: **5.49.077.012/1002**
- Lens, square, transparent red: **5.49.077.012/1306**
- Lens, square, transparent yellow: **5.49.077.012/1403**
- Lens, square, transparent green: **5.49.077.012/1505**
- Lens, square, transparent blue: **5.49.077.012/1607**

Note when using LEDs: A notch on the lamp socket identifies the cathode side.



1

**LUMOTAST 25 illuminated pushbutton with protruding collar, „Click“ quick-assembly feature**

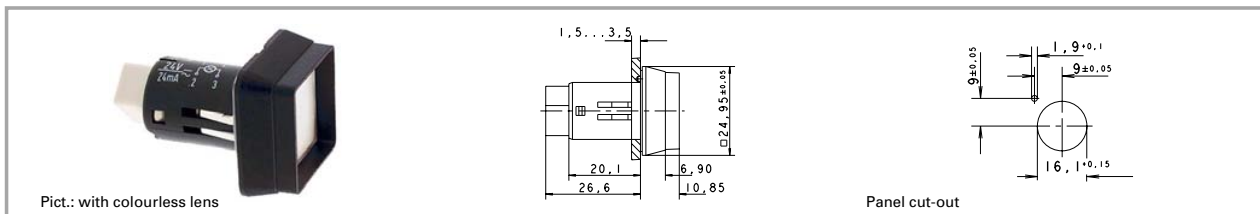

Contact function	Contact arrangement	Order no. without lens	Note
momentary	1 NO	1.15.150.706/0000	Please include the desired lens in your order.

LUMO  
25

Technical data see page 1 - 22

**Lenses:**

- Lens, square, transparent colourless: **5.49.077.011/1002**
- Lens, square, transparent red: **5.49.077.011/1306**
- Lens, square, transparent yellow: **5.49.077.011/1403**
- Lens, square, transparent green: **5.49.077.011/1505**
- Lens, square, transparent blue: **5.49.077.011/1607**

Note when using LEDs: A notch on the lamp socket identifies the cathode side.

**LUMOTAST 25 illuminated pushbutton with protruding collar, ring nut fixing**



Contact function	Contact arrangement	Order no. without lens	Note
momentary	1 NO	1.15.150.756/0000	Please include the desired lens in your order.

Technical data see page 1 - 22

**Lenses:**

- Lens, square, transparent colourless: **5.49.077.011/1002**
- Lens, square, transparent red: **5.49.077.011/1306**
- Lens, square, transparent yellow: **5.49.077.011/1403**
- Lens, square, transparent green: **5.49.077.011/1505**
- Lens, square, transparent blue: **5.49.077.011/1607**

Note when using LEDs: A notch on the lamp socket identifies the cathode side.

1

**LUMOTAST 25 selector switch**



Panel cut-out

**Technical data**

LUMO  
25

**General information**

Form of lens handle  
Colour of handle black opaque  
Form of collar square

**Dimensions**

Length of collar 25 mm  
Width of collar 25 mm  
Overall height 17 mm  
Mounting depth with connector 30.7 mm  
Mounting depth with plug-in socket 33.4 mm  
Mounting hole 16.2 mm

**Mechanical design**

Mounting see order block  
Terminals pin connector 4-pol./ plug-in socket  
Contact system snap-action contact  
Contact function see order block  
Contact arrangement 1 NO  
Contact materials Au  
Illuminability no

**Mechanical characteristics**

Operating force min. 0,03 Nm  
Rotating angle see order block  
Robustness max. 1,5 Nm

**Electrical characteristics**

Rated voltage AC/DC max. 42 V  
Rated voltage AC/DC min. 0.02 V  
Rated current AC/DC max. 100 mA  
Rated current AC/DC min. 0.01 mA  
Contact resistance max. 100 mΩ  
Bouncing time max. 5 ms



**Other specifications**

Operating life (operations) 500000  
Degree of protection from front side IP65  
Ambient temp. operating min. -25 °C  
Ambient temp. operating max. +70 °C  
Storage temperature min. -40 °C  
Storage temperature max. +80 °C  
Resistance to constant environment according to IEC 600 68-2-3 and 2-30  
Resistance at variable environment according to IEC 600 68-2-14 and 2-33  
Weight 8 g

**Accessories LUMOTAST 25 selector switch**

Description	Photo	Order no.	Page
Plug-in socket for PCB		<b>5.00.645.036/0000</b>	5 - 25
Cable (flat ribbon cable 10 cm with socket connector and male quick connector, AMP 4-pin)		<b>5.03.771.306/0000</b>	5 - 24
Blanking cap complete with sealing disc and ring nut, square		<b>5.05.800.049/0100</b>	5 - 29
Label holder, flush, for square collar		<b>5.07.620.004/0000</b>	2 - 66

**Accessories LUMOTAST 25 selector switch**

Description	Photo	Order no.	Page
Flat ribbon cable, 4-wire, 1 m long		5.37.700.124/0000	5 - 25
Fixing spanner M 15, M 16		5.58.002.019/0105	5 - 23
Socket connector, 4-pin		5.92.025.368/0000	5 - 24

1

**LUMOTAST 25 selector switch, ring nut fixing**

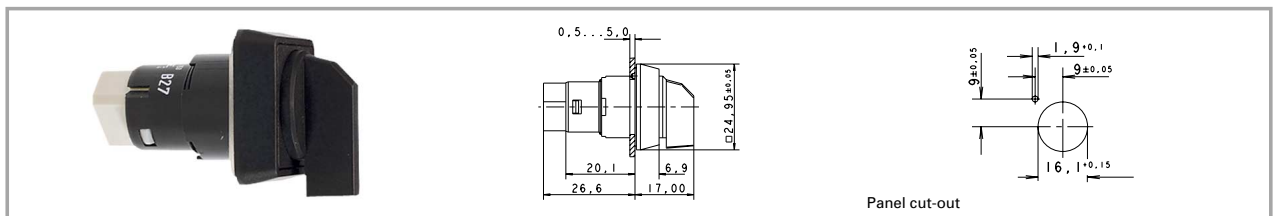

LUMO  
25

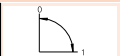
Contact arrangement	Contact function	Rotating angle	Form of lens	Order no.
1 NO	latching	right, 1 x 90°		1.15.153.106/0100

Technical data see page 1 - 28

1

**LUMOTAST 25 keylock switch**



**Technical data**

LUMO  
25

**General information**

Colour of lens black opaque  
Form of collar square

**Dimensions**

Length of collar 25 mm  
Width of collar 25 mm  
Overall height 32.3 mm  
Mounting depth with connector 30.7 mm  
Mounting depth with plug-in socket 33.4 mm  
Mounting hole 16.2 mm

**Mechanical design**

Mounting ring nut  
Terminals pin connector 4-pol./ plug-in socket  
Contact system snap-action contact  
Contact function latching  
Contact arrangement 1 NO  
Contact materials Au  
Illuminability no  
Lamp socket no  
Lock cylinder lock  
Wafers 8 pins  
Lock type 5201  
Number of locking positions 10000  
Main key yes  
Symmetric key yes  
Key removal position see order block

**Mechanical characteristics**

Operating force max. 1,5 Nm  
Rotating angle 90°

**Electrical characteristics**

Rated voltage AC/DC max. 42 V  
Rated voltage AC/DC min. 0.02 V  
Rated current AC/DC max. 100 mA  
Rated current AC/DC min. 0.01 mA  
Contact resistance max. 100 mΩ  
Bouncing time max. 5 ms

**Other specifications**

Operating life (operations) 50000  
Degree of protection from front side IP65  
Ambient temp. operating min. -25 °C  
Ambient temp. operating max. +70 °C  
Storage temperature min. -40 °C  
Storage temperature max. +80 °C  
Resistance to constant environment according to IEC 600 68-2-3 and 2-30  
Resistance at variable environment according to IEC 600 68-2-14 and 2-33  
Weight 20 g

**Accessories LUMOTAST 25 keylock switch**

Description	Photo	Order no.	Page
Plug-in socket for PCB		<b>5.00.645.036/0000</b>	5 - 25
Cable (flat ribbon cable 10 cm with socket connector and male quick connector, AMP 4-pin)		<b>5.03.771.306/0000</b>	5 - 24
Blanking cap complete with sealing disc and ring nut, square		<b>5.05.800.049/0100</b>	5 - 29

**Accessories LUMOTAST 25 keylock switch**

Description	Photo	Order no.	Page
Label holder, flush, for square collar		<b>5.07.620.004/0000</b>	2 - 66
Flat ribbon cable, 4-wire, 1 m long		5.37.700.124/0000	5 - 25
Fixing spanner M 15, M 16		<b>5.58.002.019/0105</b>	5 - 23
Spare key		5.58.015.201/0000	
Legend label 23 x 16 for label holder, without legend		<b>5.73.111.000/0000</b>	2 - 66
Socket connector, 4-pin		<b>5.92.025.368/0000</b>	5 - 24

1

LUMO  
25

**LUMOTAST 25 keylock switch**

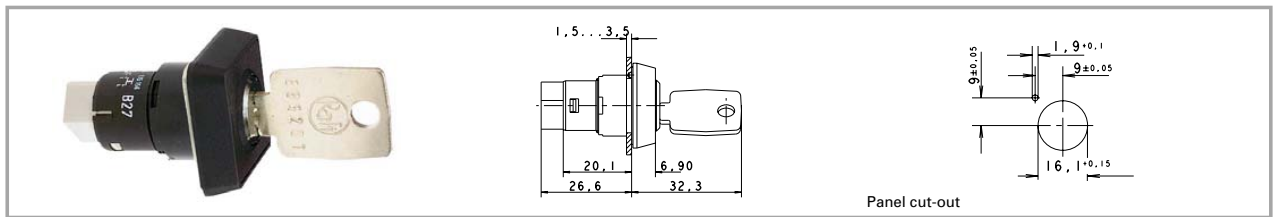

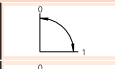
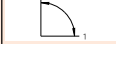
Contact arrangement	Contact function	Rotating angle	Key removal position	Colour of lens	Order no.
1 NO	latching	90°		black opaque	<b>1.15.156.001/0000</b>
1 NO	latching	90°		black opaque	<b>1.15.156.011/0000</b>

Technical data see page 1 - 30

Included: 2 keys.

1

**LUMOTAST 25 emergency stop pushbutton**



Pict.: black collar

yellow collar

Panel cut-out

**Technical data**

LUMO  
25

**General information**

Colour of lens                    opaque red  
Form of collar                    square  
Colour of collar                 see order block

**Dimensions**

Length of collar                 25 mm  
Width of collar                 25 mm  
Overall height                 18.5 mm  
Mounting depth with connector                 30.7 mm  
Mounting depth with plug-in socket                 33.4 mm  
Mounting hole                 16.2 mm

**Mechanical design**

Mounting                         ring nut  
Terminals                        pin connector 4-pol./ plug-in socket  
Contact system                 snap-action contact  
Contact function                latching  
Contact arrangement           2 NC (forcibly actuated)  
Contact materials               Au  
Illuminability                    no

**Mechanical characteristics**

Operating force max.           10 N  
Operating travel                2.6 mm  
Switching travel                2 mm  
Robustness min.                100 N

**Electrical characteristics**

Rated voltage AC/DC max.    25 V  
Rated voltage AC/DC min.    0.02 V  
Rated current AC/DC max.    100 mA  
    (1A short-circuit current)  
Rated current AC/DC min.    0.01 mA  
Contact resistance max.       100 mΩ  
Bouncing time max.            10 ms





**Other specifications**

Operating life                    15000  
Degree of protection from front side                 IP65  
Ambient temp. operating min.                            -25 °C  
Ambient temp. operating max.                            +70 °C  
Storage temperature min.                                 -40 °C  
Storage temperature max.                                 +80 °C  
Resistance to constant environment                    according to IEC 600 68-2-3 and 2-30  
Resistance at variable environment                    according to IEC 600 68-2-14 and 2-33  
Weight                                9 g  
Approvals                            TUV/UL according to EN 60947-5-5 and -5-1/A2, UL 508

**Accessories LUMOTAST 25 emergency stop pushbutton**

Description	Photo	Order no.	Page
Plug-in socket for PCB		<b>5.00.645.036/0000</b>	5 - 25
Cable (flat ribbon cable 10 cm with socket connector and male quick connector, AMP 4-pin)		<b>5.03.771.306/0000</b>	5 - 24
Blanking cap complete with sealing disc and ring nut, square		<b>5.05.800.049/0100</b>	5 - 29
Label holder, flush, for square collar		<b>5.07.620.004/0000</b>	2 - 66

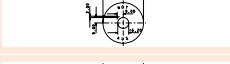
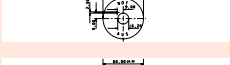
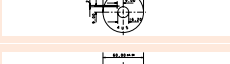
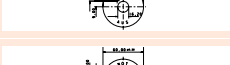
**Accessories LUMOTAST 25 emergency stop pushbutton**

Description	Photo	Order no.	Page
Flat ribbon cable, 4-wire, 1 m long		5.37.700.124/0000	5 - 25
Fixing spanner M 15, M 16		5.58.002.019/0105	5 - 23
Legend label 23 x 16 for label holder, without legend		5.73.111.000/0000	2 - 66
Emergency stop label, yellow, adhesive, round 60 mm, without legend		5.76.204.425/0400	
Emergency stop label, yellow, adhesive, round 60 mm, with legend „NOT-AUS“		5.76.204.426/0400	
Emergency stop label, yellow, adhesive, round 60 mm, with legend „ARRET-D'URGENCE“		5.76.204.427/0400	
Emergency stop label, yellow, adhesive, round 60 mm, with legend „EMERGENCY-STOP“		5.76.204.428/0400	
Emergency stop label, yellow, adhesive, round 60 mm, with legend „ARRESTO-D'EMERGENZA“		5.76.204.429/0400	
Socket connector, 4-pin		5.92.025.368/0000	5 - 24

1

LUMO  
25

**LUMOTAST 25 emergency stop pushbutton, ring nut fixing**

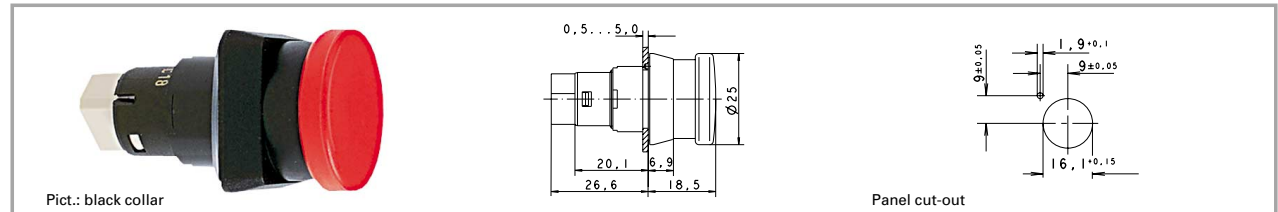

Contact function	Contact arrangement	Colour of collar	Order no. complete	Order no. single parts	
				Housing	Lens
latching	2 NC (forcibly actuated)	black	<b>1.15.154.006/0301</b>	-	-
latching	2 NC (forcibly actuated)	yellow	<b>1.15.154.016/0301</b>	-	-

Technical data see page 1 - 32

# 1

## LUMOTAST 25 signal lamp

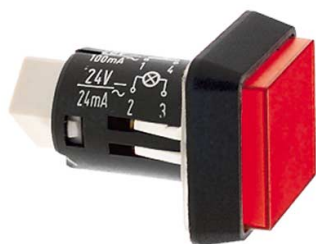

Pict.: with red lens

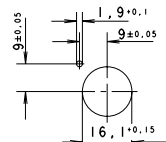

Panel cut-out

### Technical data

LUMO  
25

#### General information

Form of lens square  
Colour of lens see order block

#### Dimensions

Length of collar 25 mm  
Width of collar 25 mm  
Overall height 9.8 mm  
Mounting depth with connector 30.7 mm  
Mounting depth with plug-in socket 33.4 mm  
Mounting hole 16.2 mm

#### Mechanical design

Mounting see order block  
Terminals pin connector 4-pol./ plug-in socket  
Lamp socket Bi-Pin T 1/T 1 1/4  
Lamp filament lamp / LED

#### Electrical characteristics

Voltage limit max. 24 V  
Power limit max. 0,7 W

#### Other specifications

Degree of protection from front side IP65  
Weight 7 g  
Ambient temp. operating min. -25 °C  
Ambient temp. operating max. +70 °C  
Storage temperature min. -40 °C  
Storage temperature max. +80 °C

### Accessories LUMOTAST 25 signal lamp

Description	Photo	Order no.	Page
Filament lamp, Bi-Pin T 1 1/4 base, 12 V		<b>1.90.180.474/0000</b>	5 - 5
Filament lamp, Bi-Pin T 1 1/4 base, 28 V		<b>1.90.180.475/0000</b>	5 - 5
LED Bi-Pin T 1 superbright, red, 24 V		<b>1.90.690.351/0000</b>	5 - 17
LED Bi-Pin T 1 superbright, green, 24 V		<b>1.90.690.352/0000</b>	5 - 17
LED Bi-Pin T 1 superbright, yellow, 24 V		<b>1.90.690.353/0000</b>	5 - 17
LED Bi-Pin T 1 superbright, blue, 24 V		<b>1.90.690.354/0000</b>	5 - 17
LED Bi-Pin T 1 superbright, white, 24 V		<b>1.90.690.355/0000</b>	5 - 17
LED Bi-Pin T 1, red, 3 V		<b>1.90.691.026/0000</b>	5 - 17



**Accessories LUMOTAST 25 signal lamp**

Description	Photo	Order no.	Page
LED Bi-Pin T 1, green, 3 V		<b>1.90.691.027/0000</b>	5 - 17
LED Bi-Pin T 1, yellow, 3 V		<b>1.90.691.028/0000</b>	5 - 17
Plug-in socket for PCB		<b>5.00.645.036/0000</b>	5 - 25
Cable (flat ribbon cable 10 cm with socket connector and male quick connector, AMP 4-pin)		<b>5.03.771.306/0000</b>	5 - 24
Disassembly tool for LUMOTAST 25, RAFIX 16		<b>5.05.800.042/0000</b>	2 - 65 5 - 24
Blanking cap complete with sealing disc and ring nut, square		<b>5.05.800.049/0100</b>	5 - 29
Label holder, flush, for square collar		<b>5.07.620.004/0000</b>	2 - 66
Flat ribbon cable, 4-wire, 1 m long		5.37.700.124/0000	5 - 25
Fixing spanner M 15, M 16		<b>5.58.002.019/0105</b>	5 - 23
Legend insert, blank, use only for transparent lenses		<b>5.70.635.000/2000</b>	
Legend label 23 x 16 for label holder, without legend		<b>5.73.111.000/0000</b>	2 - 66
Socket connector, 4-pin		<b>5.92.025.368/0000</b>	5 - 24

1

LUMO  
25

**LUMOTAST 25 signal lamp, 24 V, „Click“ quick-assembly feature**

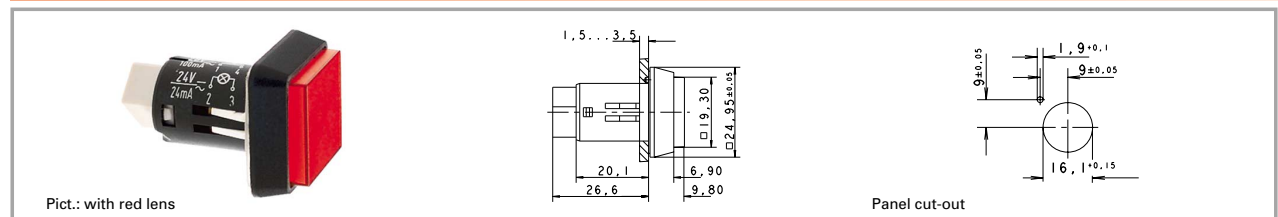

Voltage limit max.	Power limit max.	Lamp socket	Order no. without lens	Note
24 V	0.7 W	Bi-Pin T 1/T 1 1/4	1.65.122.906/0000	Please include the desired lens in your order.

Technical data see page 1 - 34

**Lenses:**

- Lens, square, transparent colourless: **5.49.077.014/1002**
- Lens, square, transparent red: **5.49.077.014/1306**
- Lens, square, transparent yellow: **5.49.077.014/1403**
- Blende quadratisch, transparent grün: **5.49.077.014/1505**
- Lens, square, transparent blue: **5.49.077.014/1607**

Do not press in lens in disassembled condition. Note when using a LED: A notch on the lamp identifies the cathode side.

Pushbuttons

**Stock items** are marked by **bold printed** order numbers.

1

**LUMOTAST 25 signal lamp, 24 V, ring nut fixing**

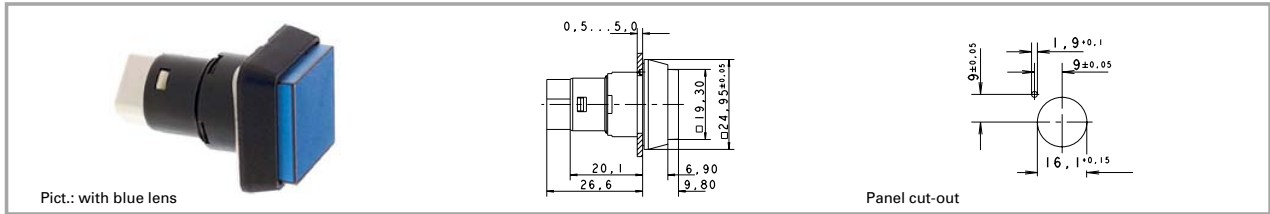

Voltage limit max.	Power limit max.	Lamp socket	Order no. without lens	Note
24 V	0.7 W	Bi-Pin T 1/T 1¼	1.65.122.956/0000	Please include the desired lens in your order.

LUMO  
25

Technical data see page 1 - 34

**Lenses:**

- Lens, square, transparent colourless: **5.49.077.014/1002**
- Lens, square, transparent red: **5.49.077.014/1306**
- Lens, square, transparent yellow: **5.49.077.014/1403**
- Lens, square, transparent green: **5.49.077.014/1505**
- Lens, square, transparent blue: **5.49.077.014/1607**

Do not press in lens in disassembled condition. Note when using LED: A notch on the lamp socket identifies the cathode side.