

# 120 to 175 CFM, 115 & 230 Volt AC Dual Inlet Centrifugal Blowers

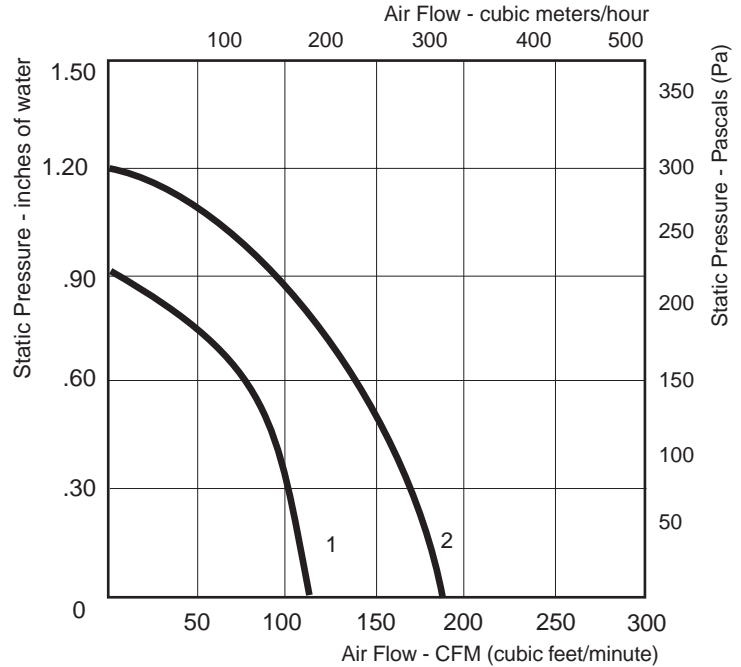

Curve Number	PART NUMBER	Volts	Hertz	Watts	Flange	Rotation**	CFM @ 0"	dBa	Temp. Max °C	Wgt. (lbs.)	Wiring Dgm#	Capacitor (µf)
1	<b>D2E097-CB11-32</b>	115	50/60	43	Yes	L	120	47	60	2.7	A	5
	<b>D2E097-CB01-12</b>	230	50/60	42	Yes	L	109	47	60	2.9	A	1.5
1	<b>D2E097-CB11-26</b>	115	60	43	No	L	120	47	60	2.7	A	5
	<b>D2E097-CB01-02</b>	230	50/60	42	No	L	109	47	60	2.9	A	1.5
2	<b>D2E097-BE11-77</b>	115	60	50	Yes	L	156	45	45	3.5	A	6
	<b>D2E097-BE01-65</b>	230	50/60	54	Yes	L	175	47	50	3.3	A	2

\*\*Rotation as viewed from side opposite the lead exit: R = clockwise; L = counter-clockwise

## Dimensions

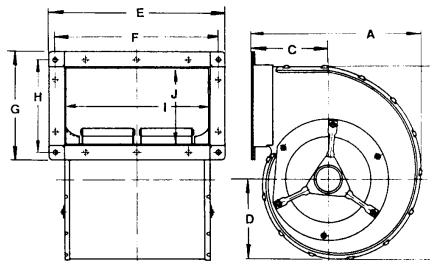

Type	Dimensions inches & (millimeters)									
	A	B	C	D	E	F	G	H	I	J
D2E097-CB	5.67 (144)	5.39 (137)	2.99 (76)	2.44 (62)	5.51 (140)	5.04 (128)	3.07 (78)	2.60 (66)	4.25 (108)	1.81 (46)
D2E097-BE	6.38 (162)	6.50 (165)	3.39 (86)	2.68 (68)	7.09 (180)	6.61 (168)	3.94 (100)	3.46 (88)	5.75 (146)	2.64 (67)

## Wiring Diagram

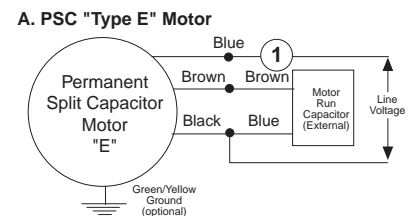

① An extra capacitor can be connected in series to yield lower RPM for multi-speed requirements