



















Style	Surface Mount Fuse	Surface Mount Fuse	Surface Mount Fuse	Surface Mount Fuse
Dimensions	1.6 x 0.8 mm	3.2 x 1.6 mm	3.2 x 1.6 mm	10.1 x 3 mm
Product picture				
Type	USF 0603	USF 1206	MGA	UMT 250
Rated Voltage	32 VAC/DC	32/63 VAC/DC	32 - 125 VAC/DC	250/125 VAC/DC
Rated Current	0.5 - 5 A	0.375 - 4 A	0.2 - 5 A	0.315 - 4 A
Breaking Capacity	50 A	50 A	50 A	200 A
Comment			ESA approved type on request	
Characteristic	Super-Quick-Acting FF	Super-Quick-Acting FF	Super-Quick-Acting FF	Time-Lag T
Approvals	 CCC	 CCC	 CCC	    CCC 
Catalogue page	xxx	xxx	xxx	xxx

Style	Surface Mount Fuse	Surface Mount Fuse	Surface Mount Fuse	Surface Mount Fuse
Dimensions	7 x 2 mm	7 x 2.54 mm	7 x 2 mm	7 x 2.54 mm
Product picture				
Type	172876	MKF	MSB	MKT
Rated Voltage	63 - 125 VAC/DC	63 - 125 VAC/DC	65 - 125 VAC/DC	65 - 125 VAC/DC
Rated Current	0.063 - 15 A	0.063 - 15 A	0.75 - 15 A	2 - 15 A
Breaking Capacity	300 A	300 A	50 A - 150 A	50 A - 150 A
Comment				
Characteristic	Quick-Acting F	Quick-Acting F	Time-Lag T	Time-Lag T
Approvals				
Catalogue page	xxx	xxx	xxx	xxx

Style	Surface Mount Fuse	Surface Mount Fuse	Surface Mount Fuse	Surface Mount Fuse
Dimensions	7.4 x 3.1 mm	12 x 5.2 mm	7.4 x 3.1 mm	12 x 5.2 mm
Product picture				
Type	OMF 63	OMK 63	OMF 125	OMK 125
Rated Voltage	63 VAC/DC	63 VAC/DC	125 VAC/DC	125 VAC/DC
Rated Current	0.063 - 10 A	0.063 - 5 A	0.063 - 10 A	0.063 - 5 A
Breaking Capacity	50 A	50 A	100 A	100 A
Comment				
Characteristic	Quick-Acting F	Quick-Acting F	Quick-Acting F	Quick-Acting F
Approvals	  CCC	CCC	 CCC	CCC
Catalogue page	xxx	xxx	xxx	xxx

USF 1206



UL 248-14 · 32/63 VAC/DC · Super-Quick-Acting

**Description**

- Directly solderable on printed circuit boards

Standards

- UL 248-14
- CSA C22.2 no. 248.14

Approvals

- UL File Number: E41599

Technical Data

Rated Voltage	32/63 VAC/DC
Rated Current	0.375 - 4 A
Breaking Capacity	50 A
Characteristic	Super-Quick-Acting FF
Mounting	PCB,SMT
Admissible Ambient Air Temp.	-55 °C to 90 °C
Climatic Category	55/090/21 acc. to IEC 60068-1
Material: Housing	Epoxyd Glass, UL 94V-0
Material: Terminals	Tin-Plated Copper
Unit Weight	0.006 g
Stock Conditions	0 °C to 60 °C, max. 70% r.h.
Product Marking	Letter (see variants)

Soldering Methods	Reflow
Solderability	245 °C / 3 sec acc. to IEC 60068-2-58, Test Td
Resistance to Soldering Heat	260 °C / 10 sec acc. to IEC 60068-2-58, Test Td
Life Test	MIL-STD-202, Method 108A (1000h @ 0.42*In @ 70°C)
Load Humidity Test	MIL-STD-202, Method 103B (1000h @ 0.1*In @ 0.85 r.H. @ 85°C)
Moisture Resistance Test	MIL-STD-202, Method 106E (50 cycles in a temp./mister chamber)
Terminal Strength	MIL-STD-202, Method 211A (Deflection of board 1 mm for 1 minute)
Thermal Shock	MIL-STD-202, Method 107D (200 air-to-air cycles from -55 to +125°C)
Case Resistance	acc. to EIA/IS-722, Test 4.7 >100 MΩ (between leads and body)
Mechanical Shock	MIL-STD-202, Method 213B (Shock 50gn, half sine wave, 11 ms)
Vibration, High Frequency	MIL-STD-202, Method 204D (Shock 20 gn, 20 min, 10-2 kHz, 12 cyc.)
Resistance to Solvents	MIL-STD-202, Method 215A
Flammability	min. UL 94V-1 (acc. to EIA/IS-722, Test 4.12)

USF 1206

Dimensions

Length H 3.2 mm

Solder pads

Pre-Arcing Time

Rated Current In	1.0 x In min.	2.0 x In max.
0.375 A - 5 A	4 h	60 s

Variants

Order Number	Rated Current [A]	Rated Voltage [V]	Rated Voltage [VDC]	Marking	Breaking Capacity	Voltage Drop 1.0 In max [mV]	Voltage Drop 1.0 In typ [mV]	Cold Resistance typ [mΩ]	Melting Pt 8.0 In typ [A ² s]	cULus CCC	
3413.0112.xx	0.375	32	63	E	1)	200	125	315	0.01		
3413.0113.xx	0.5	32	63	F	1)	140	100	190	0.02	●	●
3413.0114.xx	0.75	32	63	G	1)	140	100	120	0.05	●	●
3413.0115.xx	1	32	63	H	1)	140	100	84	0.07	●	●
3413.0116.xx	1.25	32	63	J	1)	140	100	48	0.12	●	●
3413.0117.xx	1.5	32	63	K	1)	140	100	41.5	0.24	●	●
3413.0119.xx	2	32	63	N	1)	120	85	35	0.13	●	●
3413.0120.xx	2.5	32	63	O	1)	120	85	20.5	0.35	●	●
3413.0121.xx	3	32	63	P	1)	120	85	17	0.8	●	●
3413.0123.xx	4	32	63	S	1)	100	80	14	0.3	●	●

1) 50 A @ 32 VAC , p.f. ≥ 0.95 / 50 A @ 63 VDC

Packaging Unit

- .22 Blister Tape 18 cm Reel (1000 pcs.)
- .24 Blister Tape 18 cm Reel (5000 pcs.)
- .26 Blister Tape 33 cm Reel (15000 pcs.)

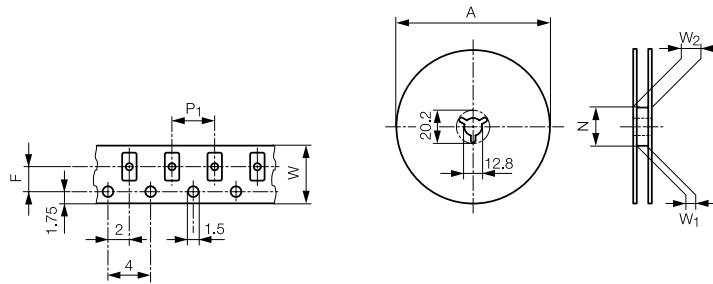

Blister tape and Reel Dimensions

according to IEC 60286-3

Type	P1 [mm]	F [mm]	W [mm]	N [mm]	W1 [mm]	W2 [mm]	A							
							750 Pcs.	1000 Pcs.	1500 Pcs.	2000 Pcs.	3000 Pcs.	5000 Pcs.	10000 Pcs.	15000 Pcs.
USF 0603	4	3.5	8	62	8.4	14.4	180 mm							
USF 1206	4	3.5	8	62	8.4	14.4	180 mm							
MGA	4	3.5	8	62	8.4	14.4	180 mm			180 mm				330 mm
UMT 250	8	11.5	24	62	24.4	30.4	330 mm							
172876	4	5.5	12	62	12.4	18.4	180 mm			330 mm				
MKF	4	5.5	12	62	12.4	18.4	180 mm [500 Pcs.]		180 mm					
MSB	4	5.5	12	62	12.4	18.4	180 mm			330 mm				
MKT	4	5.5	12	62	12.4	18.4	180 mm [500 Pcs.]		180 mm					
OMF 63	8	7.5	16	62	16.4	22.4	180 mm			330 mm				
OMK 63	8	11.5	24	62	24.4	30.4	330 mm							
OMF 125	8	7.5	16	62	16.4	22.4	180 mm			330 mm				
OMK 125	8	11.5	24	62	24.4	30.4	180 mm		330 mm					
OMT 125	8	7.5	16	62	16.4	22.4	180 mm			330 mm				
OMZ 125	8	11.5	24	62	24.4	30.4	180 mm		330 mm					
OMF 250	8	11.5	24	62	24.4	30.4	330 mm							
OMT 250	8	11.5	24	62	24.4	30.4	330 mm							
TF 600	8	11.5	24	62	24.4	30.4	330 mm							
OSU 125	8	7.5	16	62	16.4	22.4	180 mm			330 mm				
OSU 250	8	11.5	24	62	24.4	30.4	330 mm							
OMH 125	8	11.5	24	62	24.4	30.4	180 mm		330 mm					
PFNF	4	3.5	8	62	8.4	14.4	180 mm							
PFMF	8	5.5	12	62	12.4	18.4	180 mm		180 mm					
PFDF	8	7.5	16	62	16.4	22.4	360 mm							
PFSM	8/12	7.5	16	62	16.4	22.4	360 mm		360 mm					
PFHT	8/12	7.5	16	62	16.4	22.4	360 mm		360 mm					

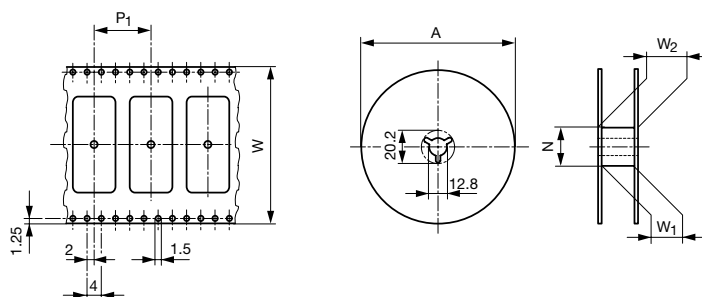

Blister tape and Reel Dimensions

according to IEC 60286-3

Type	P1 [mm]	W [mm]	N [mm]	W1 [mm]	W2 [mm]	A		
						250 Pcs.	400 Pcs.	2000 Pcs.
SMD-FST	8	32	100	32.4	38.4	380 mm		
SMD-SPT	8	32	100	32.4	38.4	380 mm		
SMD-FTT	8	32	100	32.4	38.4	380 mm		
OGN-SMD	16	44	100	44.4	50.4	380 mm		
FPG7	16	56	150	56.4	62.4	380 mm		