



CML INNOVATIVE TECHNOLOGIES
WHERE INNOVATION COMES TO LIGHT

[Home](#)

[About CML](#)

[Service](#)

[Media Center](#)

[Contact](#)

[Access CML](#)

Products

Aviation Incandescent Lamps

CML incandescent lamps offer high performance. Primary advantages include their bright white light output and their relatively low cost.

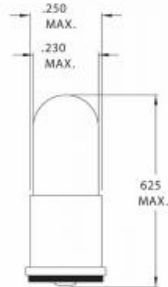

Part Number: CM328
Serial Number: T-1 MF
Type: T-1 3/4
Base: Midget Flanged
Volts (V): 6
AMP +/- 10%: 0.2
MSCP nom.: .6
Avg life: 1000
Special Features:
Military Reference: MS6363/8-4
RoHS Status: Yes

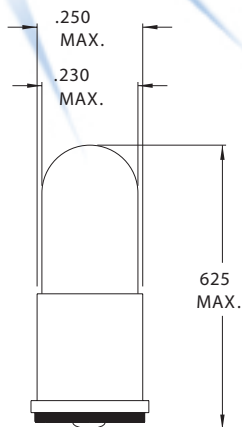
T-1 3/4 Midget Flange Base

Part Number	Design Voltage	Amps	MSCP	Life Hours	Filament Type
CM331	1.35	.060	.010	500	C-6
CM268	2.50	.350	.200	10,000	C-2R
CM343	2.50	.400	.550	30	C-2R
CM368	2.50	.200	.220	500	C-2R
CM338	2.70	.060	.040	6,000	C-2R
CM375	3.00	.015	.004	10,000	C-6
CM8848	3.00	.350	.300	10,000	C-2R
CM7331	4.50	.120	.050	25,000	C-2R
CM3150	5.00	.060	.150	5,000	C-2R
CM7332	5.00	.060	.030	60,000	C-2R
CM7333	5.00	.060	.050	25,000	C-2R
CM7334	5.00	.190	.450	1,000	C-2R
CM7335	5.00	.115	.150	40,000	C-2R
CM328	6.00	.200	.600*	1,000	C-2R
CM345	6.00	.040	.030	10,000	C-2V
CM7336	6.00	.200	.100	50,000	C-2F
CM349	6.30	.200	.550	5,000	C-2R
CM350	6.30	.150	.450	3,000	C-2R
CM377	6.30	.075	.230	1,000	C-2R
CM380	6.30	.040	.020	20,000	C-2V
CM381	6.30	.200	.400	20,000	C-2F
CM344	10.0	.014	.002	50,000	C-2F
CM367	10.0	.040	.080	5,000	C-2F
CM7338	11.0	.022	.030	10,000	C-2F
CM394	12.0	.040	.120	10,000	C-2F
CM330	14.0	.080	.500	1,500	C-2F
CM382	14.0	.080	.300	15,000	C-2F
CM8918	14.0	.100	.500	10,000	C-2F
CM370	18.0	.040	.150	10,000	C-2F
CM459	22.0	.040	.300	2,000	C-2F
CM8176	24.0	.050	.500	1,000	C-2F
CM327	28.0	.040	.340	4,000	C-2F
CM376	28.0	.060	.340	25,000	C-2F
CM385	28.0	.040	.150	10,000	C-2F
CM387	28.0	.040	.300	7,000	C-2F
CM6034	28.0	.024	.150	4,000	CC-2F
CM7341	28.0	.065	.650	5,000	C-2F
CM269	32.0	.040	.300	4,000	C-2F
CM6848	48.0	.025	.200	5,000	CC-2F

* Lamp MSCP is .340 @ 5.0V