

Our Products

- 7/16
- [BNC](#)
- [D-Sub](#)
- [FME](#)
- [MCX](#)
- [MMCX](#)
- [SMA](#)
- [SMB](#)
- [SMC](#)
- [TNC](#)
- [Twin BNC](#)
- [Type F](#)
- [Type N](#)
- [UHF](#)

Search Results for: BNC Plug/TNC Jack

Please note: Images are for reference only



Part Number: 242148
Family/Series: Between Series Adapters
Product Type: Between Series Adapters
Description: BNC Plug/TNC Jack
Cable: Non Applicable **

Cable Group: N/A
Finish: N/A
Insulation: N/A
Impedance: N/A
Crimp Tool: [N/A](#)

[Add to Cart](#) | [Product Specs](#) | [Customer Drawing](#)

- [Between-Series Adapters](#)
- [Shielded Terminations](#)
- [Strain-Relief Boots](#)
- [Tools](#)

[View All Products](#)

Copyright © 2001 - 2008 Amphenol Connex. All rights reserved.

[Copyright](#) | [Terms & Conditions](#) | [Contact Us](#) | [Amphenol.com](#)



BETWEEN SERIES ADAPTERS

Connex between series adapters are used to join two connectors of different series. They are designed to offer the lowest VSWR rating of the two series involved. Here is a listing of all adapters shown in this section. In-series adapters can be found at the end of each series listed.

Description	P/N	Page	Description	P/N	Page	Description	P/N	Page
SMA Plug/BNC Jack	242102	172	SMA Plug/Mini-UHF Jack			N Plug/TNC Jack	242130	176
SMA Jack/BNC Plug	242103	172		242116	174	N Jack/TNC Plug	242131	176
SMA Jack/BNC Jack	242123	172	SMA Jack/Mini-UHF Plug			N Jack/TNC Jack	242132	177
SMA Plug/BNC Plug	242104	172		242117	174	N Plug/TNC Plug	242133	177
			SMA Plug/Mini-UHF Plug			N Jack/F Jack	242120	177
SMA Plug/TNC Jack	242124	172		242118	174	N Jack/F Plug	242152	177
SMA Jack/TNC Plug	242105	172	SMA Jack/Mini-UHF Jack			WATERPROOF		
SMA Plug/TNC Plug	242106	172		242119	175	N Plug/F Jack	242156	—
SMA Jack/TNC Jack	242107	172	SMA Plug/MCX Jack	242126	175	WATERPROOF		
SMA Jack/TNC Jack (Bulkhead)			SMA Jack/MCX Plug	242127	175	N Plug/F Plug	242157	—
	242178	—	SMA Plug/MCX Plug	242128	175	N Right Angle Plug/F Jack		—
			SMA Jack/MCX Jack	242129	175	WATERPROOF	242158	
SMA Plug/SMB Jack	242144	173				N Plug/7/16 Jack	242135	177
SMA Jack/SMB Plug	242145	173	SMA Plug/MMCX Jack			N Jack/7/16 Plug	242136	177
SMA Plug/SMB Plug	242146	173		242140	175	N Jack/7/16 Jack	242137	177
SMA Jack/SMB Jack	242147	173	SMA Jack/MMCX Plug			N Plug/7/16 Plug	242138	177
				242141	175			
SMA Plug/SMC Jack	242174	—	SMA (Reverse Polarized)			N Plug/UHF Jack	242155	178
SMA Jack/SMC Plug	242175	—	Jack/MMCX Plug	242141RP	175			
SMA Jack/SMC Jack	242176	—	SMA Plug/MMCX Plug			BNC Plug/TNC Jack	242148	178
SMA Plug/SMC Plug	242177	—		242142	176	BNC Jack/TNC Plug	242149	178
			SMA Jack/MMCX Jack			BNC Jack/TNC Jack	242150	178
				242143	176	BNC Plug/TNC Plug	242151	178
SMA Plug/N Jack	242112	173						
SMA Jack/N Plug	242113	173	N Plug/MCX Jack	242170	—	BNC Plug/UHF Jack	242134	179
SMA Plug/N Plug	242114	173	N Jack/MCX Plug	242171	—	BNC Plug/UHF Plug	242139	179
SMA Jack/N Jack	242115	173	N Jack/MCX Jack	242172	—	BNC Jack/UHF Plug	242164	—
SMA Jack/N Jack (Bulkhead)			N Plug/MCX Plug	242173	—	BNC Jack/UHF Jack	242165	—
	242125	174						
SMA Jack/N Jack (Panel)			N Plug/MMCX Jack	242166	—	BNC Plug/F Jack	242154	179
	242163	—	N Jack/MMCX Plug	242167	—	BNC Jack/F Jack	242161	—
			N Jack/MMCX Jack	242168	—			
SMA Plug/UHF Jack	242108	174	N Plug/MMCX Plug	242169	—	Mini-UHF Plug/UHF Jack		
SMA Jack/UHF Plug	242109	174					242153	179
SMA Plug/UHF Plug	242110	174	N Plug/BNC Jack	242121	176			
SMA Jack/UHF Jack	242111	174	N Jack/BNC Plug	242101	176			
			N Jack/BNC Jack	242100	176			
			N Jack/BNC Jack (Bulkhead)					
				242162	—			
			N Plug/BNC Plug	242122	176			

For Reverse Polarized connectors, add RP to standard part number. Contact Connex marketing for availability.
For Reverse Threaded connectors, add RT to standard part number. Contact Connex marketing for availability.

BETWEEN SERIES ADAPTERS

P.N.	Description
242155	N Plug/UHF Jack

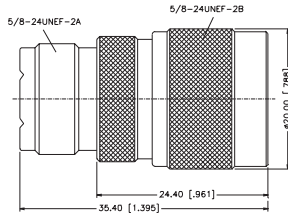

P.N.	Description
242150	BNC Jack/TNC Jack

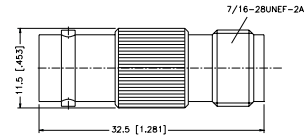

P.N.	Description
242148	BNC Plug/TNC Jack

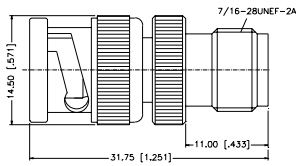

P.N.	Description
242151	BNC Plug/TNC Plug

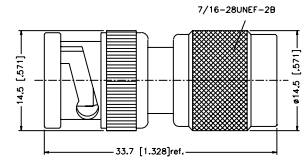
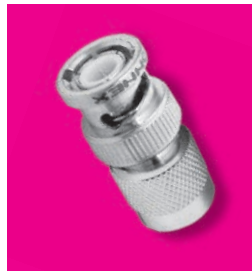

P.N.	Description
242149	BNC Jack/TNC Plug

