

IEC plug connector E, rewirable, angled



Description

- Rewireable plug, Screw-on
- Inlet, Pin temperature 70 °C, Protection class I
- Cable

Approvals

- UL License Number: E96454
- CSA License Number: 70111

Technical Data

| | | | |
|---------------------------|---|-------------------------|---|
| Ratings IEC | 10A / 250VAC; 50Hz | Appliance-Inlet/-Outlet | E following IEC/EN 60320-2-2, UL 498, CSA C22.2 no. 42 (for cold conditions) pin-temperature 70 °C, 10A, Protection class I |
| Ratings UL/CSA | 10A / 250VAC; 60Hz | | |
| Dielectric Strength | > 2 kVAC between L-N > 2 kVAC between L/N-PE (1 min/50Hz) | | |
| Allowable Operation Temp. | -25 °C to 70 °C | | |
| Protection Class | Suitable for appliances with protection class I acc. to IEC 61140 | | |
| Terminal | Cable | | |
| Material: Housing | Thermoplastic, black, UL 94V-0 | | |

Dimensions

Length 75.4 mm

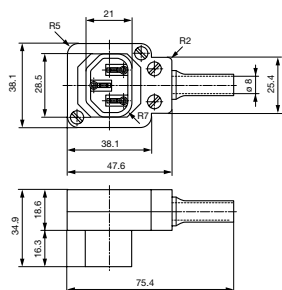

Variants

| Color | Max. cable diameter | Max. wire size | Order Number |
|-------|---------------------|------------------------------------|--------------|
| black | 8.5 mm | 3 x 1 mm ² / 3 x 18 AWG | 4300.0401 |

Max. torque for screws: Terminal: 0.5 Nm, Cable clamp: 0.3 Nm, Cover: 0.3 Nm

Cord retaining clamp see accessories

Packaging unit 20 Pcs