



D2E133 Series Centrifugal Blower

Ø 133mm

- AC dual inlet, forward curved centrifugal blower. Via a bracket, the integrated external-rotor motor is mounted on one side of the housing.
- Direction of rotation is CW as seen from inlet opposite the cable exit. Insulation class "B".
- Housing and impeller made of galvanised sheet-steel. Forward curved impellers are directly press-fitted onto the rotor of the external-rotor motor.
- Maintenance-free ball bearings.
- UL, CSA, VDE approvals on some models, please contact application engineering.

Part Number	Curve	CFM @ 0	VAC	Hertz	Power (W)	dB(A)	Max Amb. Temp. C	Bearing Type	Features	Capacitor (µF)	Wgt. (lbs)
D2E133-BI40-50	1	180	230	50/60	110	49	50	Ball	Leads	2	6.50
D2E133-AM47-01	3	300	230	50/60	200	56	40	Ball	Leads	3	7.69
D2E133-AM47-23	3	300	230	50/60	200	56	40	Ball	Leads	3	7.69
D2E133-DM47-01	4	353	230	50/60	195	55	40	Ball	Leads	3	9.69
D2E133-DM47-23	4	353	230	50/60	195	55	40	Ball	Leads	3	9.69
D2E133-DM47-A3	4	353	230	50/60	195	55	40	Ball	Leads	3	9.69
<hr/>											
D2E133-DM67-78	4	420	115	60	205	55	40	Ball	Leads	12	9.00

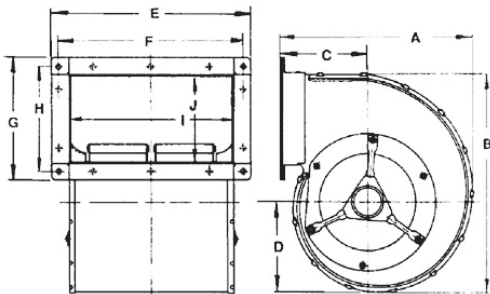

DIMENSIONS - Inches (mm)

PART NUMBER	A	B	C	D	E	F	G	H	I	J
D2E133-BE	6.73 (171)	7.09 (180)	3.46 (88)	3.15 (80)	7.63 (194)	7.01 (178)	4.25 (108)	3.62 (92)	6.10 (155)	2.72 (69)
D2E133-AA	6.73 (171)	7.09 (180)	3.46 (88)	2.99 (76)	10.0 (254)	9.37 (238)	4.25 (108)	3.62 (92)	8.46 (215)	2.72 (69)
D2E133-AB&AM	6.73 (171)	7.09 (180)	3.46 (88)	2.99 (76)	10.0 (254)	9.37 (238)	4.25 (108)	3.62 (92)	8.46 (215)	2.72 (69)
D2E133-DB&DM	8.03 (204)	8.39 (213)	3.82 (97)	3.86 (98)	10.63 (270)	10.0 (254)	5.59 (142)	4.96 (126)	9.13 (232)	4.02 (102)

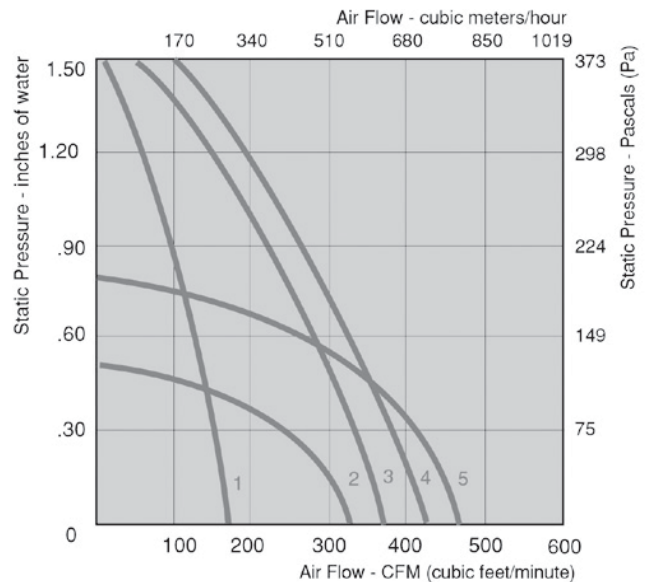

e-mail: sales@us.ebmpapst.com - TEL: 860-674-1515 - FAX: 860-674-8536

ebm-papst Inc., 100 Hyde Road, Farmington, CT 06034 USA

ebm-papst Inc., 2004 © ebm-papst Inc. reserves the right to change any specifications or data without notice