

## Features

- Compatible with TTL Gates
- Push-On Connector Terminals
- Mounts on a TO3 Transistor Heat Sink

# RS2 Series



## Printed Circuit Board Mountable Solid State Relay, 7 Amp.

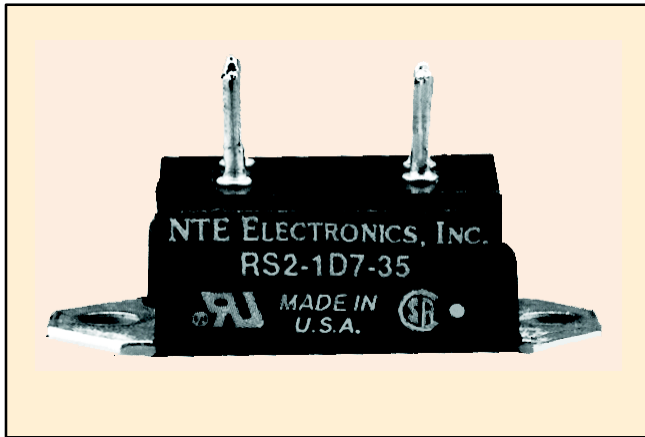

### D37

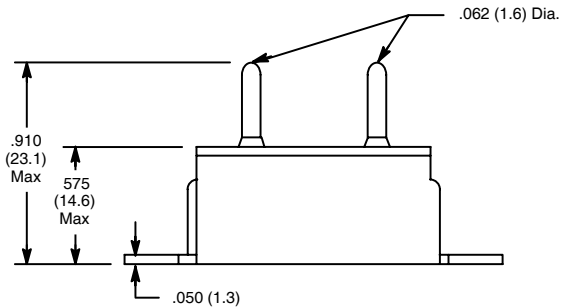
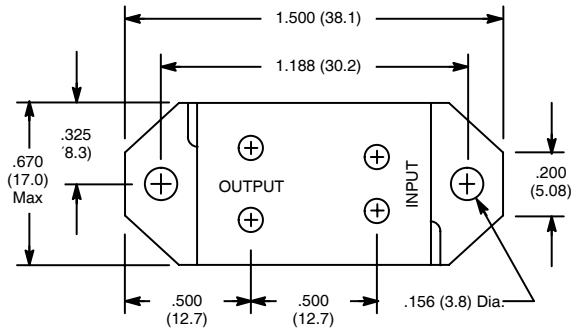

## Input Specifications

### Control Voltage:

RS2-1D7-33	5VDC
RS2-1D7-35	12VDC

### Max Pick-up Voltage:

RS2-1D7-33	4.3VDC
RS2-1D7-35	10.3VDC

### Min Drop-out Voltage: 1.5VDC

### Max Input Current: 15mADC

## Output Specifications

<b>Nom. Off-State Voltage:</b>	120V (RMS)
<b>Non-Repetitive Peak Voltage:</b>	400V
<b>Min-Max Off-State Voltage:</b>	20V to 260V (RMS)
<b>Rated Load Current:</b>	7A (RMS)
<b>Min. Load Current:</b>	20mA (RMS)
<b>Non-Repetitive Surge Current:</b>	50A
<b>Max. Off-State Leakage Current:</b>	100 $\mu$ A (RMS)
<b>Max. On-State Voltage:</b>	1.8V (RMS)

## Electrical Specifications

### Operational Characteristics

<b>Response Time:</b>	Turn-On	16mS Max
	Turn-Off	60mS Max

### Max. Rate of Rise of Off-State Voltage:

Blocking	100V/ $\mu$ S
Commutating	4V/ $\mu$ S

### Dielectric Strength (Input-Output Isolation): 2500VAC

### Insulation Resistance (@ 500VDC): 10,000M $\Omega$

### Max. I<sup>2</sup>t for Fusing (8.3mS): 24

### Environmental Characteristics

**Operating:** -40°C to +65°C

**Storage:** -40°C to +100°C

### Schematic showing typical TTL input connections

