

THIS DOCUMENT IS THE PROPERTY OF  
KEYSTONE ELECTRONICS CORP. AND  
SHALL NOT BE REPRODUCED, DISTRIBUTED  
OR USED AS A BASIS FOR MANUFACTURE  
WITHOUT PRIOR WRITTEN PERMISSION  
FROM KEYSTONE ELECTRONICS CORP.

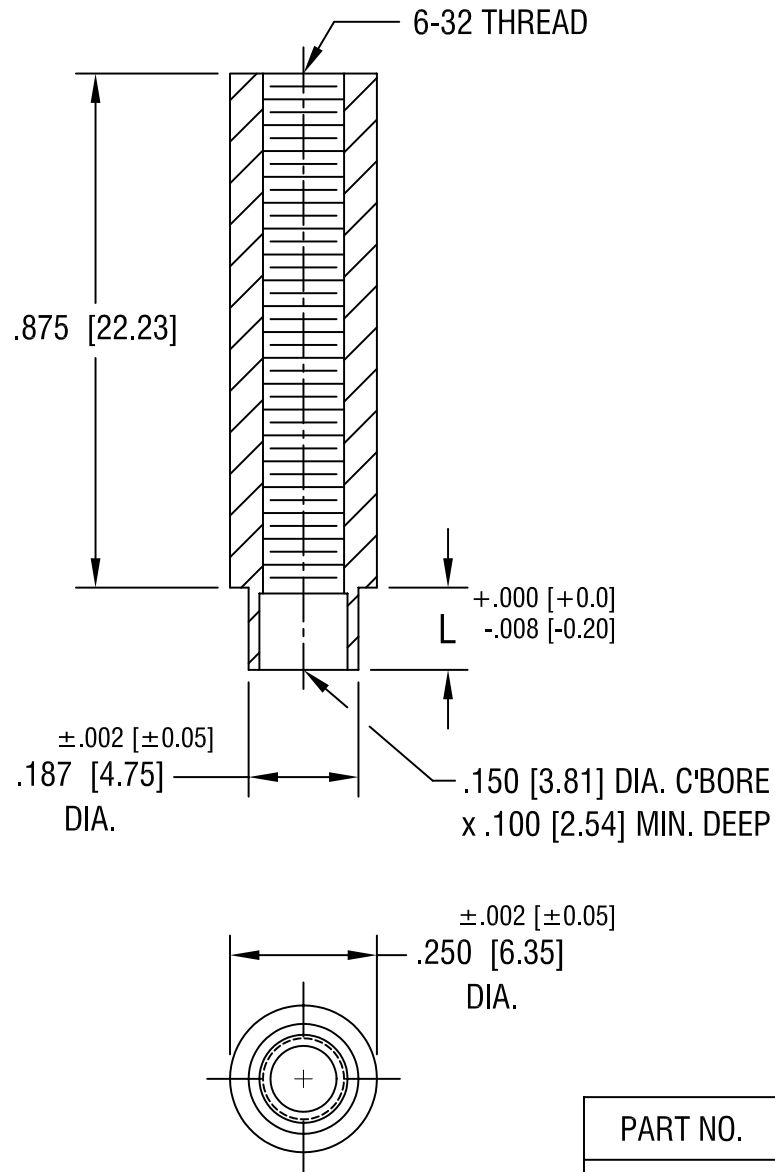

| PART NO. | 'L' DIM.    |
|----------|-------------|
| 1796-2   | .109 [2.77] |
| 1796-3   | .140 [3.56] |
| 1796-4   | .171 [4.34] |

| <b>KEYSTONE ELECTRONICS CORP.</b>    |  |                 |                 |
|--------------------------------------|--|-----------------|-----------------|
| ASTORIA, N.Y. 11105-2017             |  |                 |                 |
| PART NAME<br>SWAGE THREADED STANDOFF |  |                 |                 |
| MATERIAL<br>BRASS                    |  |                 |                 |
| FINISH<br>DUCTILE<br>NICKEL PLATE    |  | DRN BY<br>BOONE | DATE<br>5.14.02 |
|                                      |  | APP'D           | SCALE<br>3X     |
| TOLERANCES INCH [MM]                 |  | CODE            | DWG NO.         |
| DECIMAL ± .005 [± 0.15]              |  | C/M             | 1796-           |
| ANGULAR ± 1°                         |  |                 |                 |
| UNLESS OTHERWISE SPECIFIED           |  |                 |                 |

| DATE | DESCRIPTION | REV. |
|------|-------------|------|
|      |             |      |