



PLC2S-S6-M



- For indoor use
- Used to secure a cable bundle to another surface such as a control panel, communication rack, wall or ceiling
- Design allows for bundling before or after screwing clamp in place
- One-piece construction for consistent performance and reliability
- Curved tip is easy to pick up from flat surfaces and allows faster initial threading to speed installation

▪ Part Number	PLC2S-S6-M
▪ RoHS Compliancy Status	Compliant
▪ Part Description	Clamp Tie, 7.9", Standard cross section
▪ Product Type	Cable Ties
▪ Material	Nylon 6.6
▪ Color	Natural
▪ CSA Certified	Yes
▪ UL Listed (File #E56854)	Yes
▪ UL Recognized (File #E56854)	Yes
▪ Length (In.)	7.9
▪ Length (mm)	201
▪ Width (In.)	.190
▪ Width (mm)	4.8
▪ Boss Height (In.)	.160
▪ Boss Height (mm)	4.1
▪ Boss Width (In.)	.373
▪ Boss Width (mm)	9.5
▪ CE Compliant	Yes
▪ Cross Section	Standard
▪ Locking Style	Locking
▪ Material Flammability Rating	UL 94V-2
▪ Max. Bundle Diameter (In.)	1.84
▪ Max. Bundle Diameter (mm)	47
▪ Max. Continuous Use Temperature	185°F (85°C)
▪ Min. Loop Tensile Strength (Lbs.)	50
▪ Min. Loop Tensile Strength (N)	222

▪ Nominal Hole Diameter (In.)	.148
▪ Nominal Hole Diameter (mm)	3.8
▪ Pricing Description	Clamp Tie, 7.9"L (201mm), #6 (M3) Screw, Standard, Nylon, Natural
▪ Screw Size	#6
▪ Screw Size Metric	M3
▪ Thickness (In.)	.047
▪ Thickness (mm)	1.2
▪ Tool	GTS, GTSL, GS2B, GTH, GS4H, PTS, PTH, PPTS, STS2, STH2
▪ Min. Order UOM	PC
▪ Min. Order Qty.	1000
▪ BOM Qty. (# of Pkgs.)	

THIS COPY IS PROVIDED ON A RESTRICTED BASIS AND IS NOT TO BE USED IN ANY WAY DETRIMENTAL TO THE INTERESTS OF PANDUIT CORP.

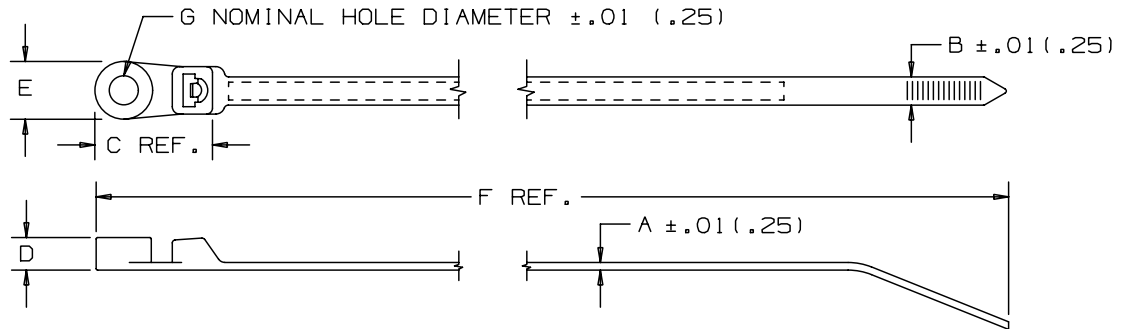
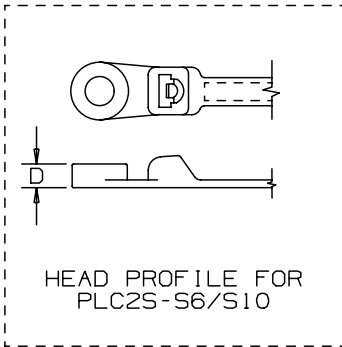

PANDUIT PART NO. *	BUNDLE DIA.		A In (mm)	B In (mm)	C In (mm)	D In (mm)	E In (mm)	F In (mm)	G In (mm)	MIN. LOOP TENSILE lbs (N)	CROSS- SECTION	RECM. FASTENER	WEIGHT lbs/100pcs (g)
	MIN. In (mm)	MAX. In (mm)											
PLC1M-S4	.06 (1.5)	.75 (19)	.045 (1.1)	.100 (2.5)	.542 (13.8)	.153 (3.9)	.239 (6.1)	4.3 (109.2)	.122 (3.1)	18 (80)	MINIATURE	#4 (M2.5) SCREW	.08 (36)
PLC1.5I-S8	.06 (1.5)	1.25 (32)	.045 (1.1)	.135 (3.4)	.694 (17.6)	.166 (4.2)	.335 (8.5)	6.1 (154.9)	.174 (4.4)	40 (178)	INTERMEDIATE	#8 (M4) SCREW	.18 (82)
PLC2S-S6	.06 (1.5)	1.84 (47)	.047 (1.2)	.190 (4.8)	.765 (19.4)	.180 (4.1)	.373 (9.5)	7.9 (200.7)	.148 (3.8)	50 (222)	STANDARD	#6 (M3) SCREW	.32 (145)
PLC2S-S10	.06 (1.5)	1.84 (47)	.047 (1.2)	.190 (4.8)	.765 (19.4)	.180 (4.1)	.373 (9.5)	7.9 (200.7)	.200 (5.1)	50 (222)	STANDARD	#10 (M5) SCREW	.32 (145)
PLC3S-S10	.06 (1.5)	3.00 (76)	.052 (1.3)	.190 (4.8)	.765 (19.4)	.220 (5.6)	.373 (9.5)	12 (304.8)	.200 (5.1)	50 (222)	STANDARD	#10 (M5) SCREW	.50 (227)
PLC4S-S10	.06 (1.5)	4.00 (102)	.052 (1.3)	.190 (4.8)	.765 (19.4)	.220 (5.6)	.373 (9.5)	15 (381.0)	.200 (5.1)	50 (222)	STANDARD	#10 (M5) SCREW	.59 (268)

NOTES:

- *1) SEE CURRENT PRICE SHEET FOR PART NUMBER SUFFIX DESIGNATION FOR PACKAGE SIZE AND PART COLOR
- 2) RECOGNIZED UNDER THE COMPONENT PROGRAM OF UNDERWRITERS LABORATORIES INC.

SS-2724-18.PRT

CAD FILENAME/LAYERS
DIMENSIONS IN PARENTHESES ARE IN METRIC UNITS

PANDUIT CORP. TINLEY PARK, ILLINOIS

PAN-TY LOCKING CLAMP TIE
PLC SERIES

UNLESS OTHERWISE SPECIFIED,
DIMENSIONAL TOLERANCES ARE:
(.X) ± .005 (.125) (XXX) ± .020 (.51)
(.XX) ± .02 (.5) ANGLES ± .005

UNLESS OTHERWISE SPECIFIED,
ALL DIMENSIONS ARE GIVEN
IN INCHES, THIRD ANGLE PROJECTION.

REV	DATE	BY	CHK	DESCRIPTION	ECN	R	CUST	SUP	DRAWN BY L.V./AJC	DATE 2-11-71	MAT'L: NYLON 6.6	SCALE NONE	DWG SIZE A
--	-----	---		CHANGED MAX. BUNDLE DIA. METRIC NUMBERS TO WHOLE NUMBERS	----	--							
18	5/31/05	ERW		CHANGED DIMENSION 'G' FROM A TOLERANCE TO A NOMINAL HOLE DIAMETER	2724	18							